

45279

M70 PAGE 8699

SUPPLEMENTAL AGREEMENT

On April 8, 1964, a Drift Fence Easement, hereinafter designated as the "Original Easement", was granted by WEYERHAEUSER COMPANY, therein designated as "Weyerhaeuser", to the UNITED STATES OF AMERICA, therein designated as "Government".

The parties mutually agree that the Original Easement shall be and is hereby supplemented to include additional drift fence and cattle guard on the additional Weyerhaeuser land;

W $\frac{1}{2}$ NE $\frac{1}{4}$; SE $\frac{1}{4}$ SW $\frac{1}{4}$; W $\frac{1}{2}$ SE $\frac{1}{4}$	- Section 24-T36S-R15E
NW $\frac{1}{4}$	- Section 25-T36S-R15E
SE $\frac{1}{4}$ SE $\frac{1}{4}$	- Section 14-T36S-R16E
SE $\frac{1}{4}$ SE $\frac{1}{4}$	- Section 9-T37S-R16E
NE $\frac{1}{4}$ NW $\frac{1}{4}$; W $\frac{1}{2}$ SW $\frac{1}{4}$	- Section 10-T37S-R16E

all in Lake County, Oregon, located approximately as shown on the attached "Exhibit A".

Except as herein expressly provided, all of the terms and conditions of the Original Easement, as supplemented, shall remain unmodified.

IN WITNESS WHEREOF, the parties hereto have executed this Supplemental Agreement, in duplicate, as of the 14th day of SEPT., 1970.

WEYERHAEUSER COMPANY

By R. N. Witter, Jr.
Manager, Land Resources

Attest: Mary B. Mosier
Assistant Secretary

Accepted:

UNITED STATES OF AMERICA

By Robert B. [Signature]
Title: Deputy Forest Supervisor

STATE OF WASHINGTON)
County of Pierce) ss.

On this 14th day of September, 1970, before me personally appeared R. N. WITTER, JR. and MARY B. MOSIER, to me known to be the Manager, Land Resources, and Assistant Secretary, respectively, of Weyerhaeuser Company, the corporation that executed the within and foregoing instrument, and acknowledged said instrument to be the free and voluntary act and deed of said corporation, for the uses and purposes therein mentioned, and on oath stated that they were authorized to execute said instrument and that the seal affixed is the corporate seal of said corporation.

IN WITNESS WHEREOF, I have hereunto set my hand and affixed my official seal the day and year first above written.

Robert J. Morris
Notary Public in and for the State of
Washington, residing at Puyallup

40

SEP 29 1 12 PM '70

FORM No. 124-MECHANICAL
SC-1

SEP 30 4 45 PM '70

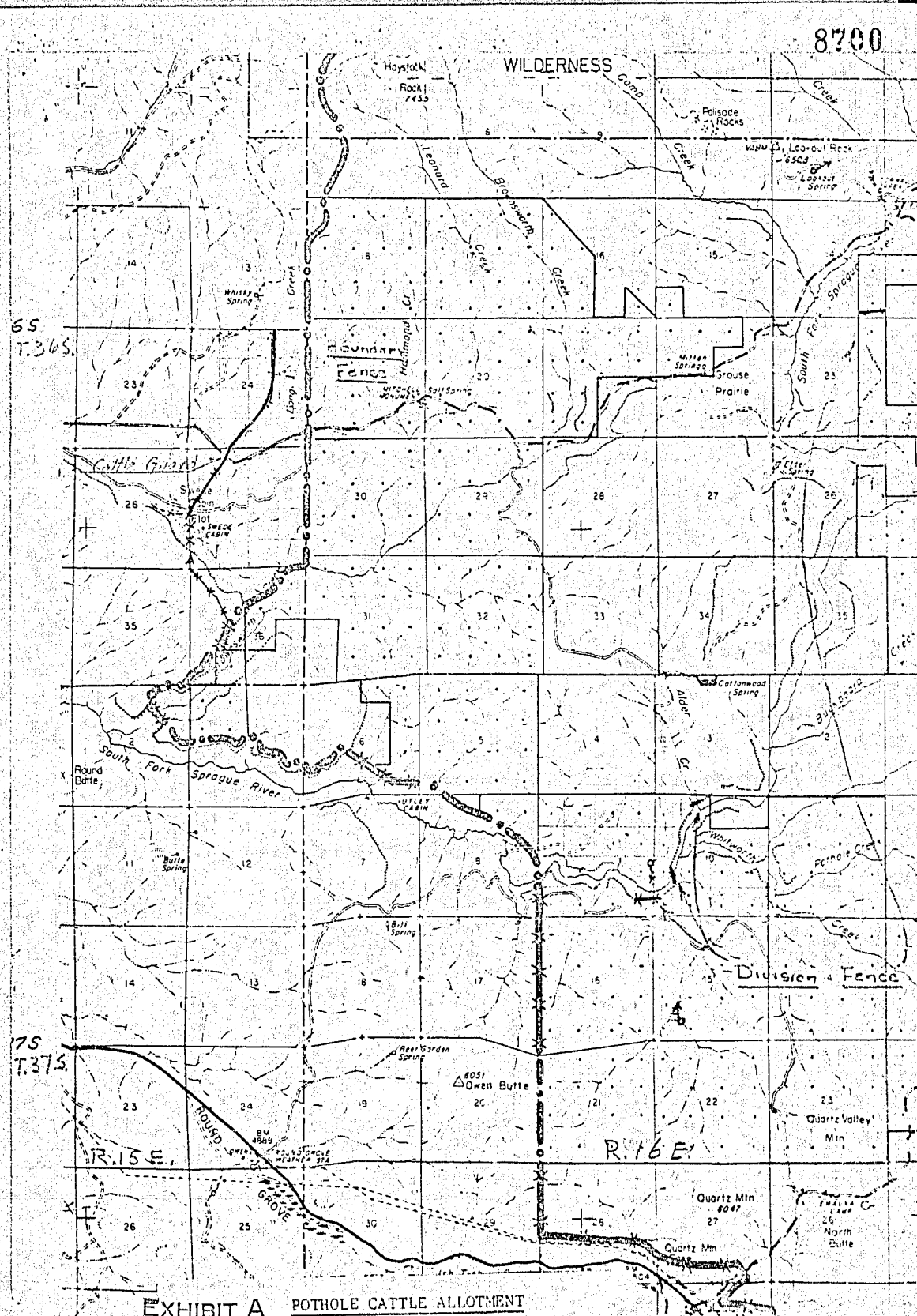

EXHIBIT A POTHOLE CATTLE ALLOTMENT

STATE OF OREGON, COUNTY OF KLAMATH; ss.

Filed for record at request of Weyerhaeuser Company

this 29th day of Sept. A.D., 1970 at 1:12 o'clock P.M., and duly recorded in
Vol. M70 of Deeds on Page 8699

Fee \$3.00 By WM. D. MILNE, County Clerk
Cartha P. P. P.

FORM No. 124-MED
SC-1

SEP 30 4 45 PM 1970