

TEMPORARY RIGHT-OF-WAY EASEMENT DEED

THIS EASEMENT, dated this 13th day of MARCH, 19 72,
from Gilchrist Timber Company, a corporation of the State of Delaware,
hereinafter called "Grantor," to the United States of America, hereinafter
called "Grantee,"

WITNESSETH:

Grantor, for and in consideration of \$1.00, received by Grantor, does hereby
grant and convey unto the Grantee and its assigns, an easement for a road
over and across the following described lands in the County of Klamath, State
of Oregon, to wit:

Township 26 South
Range 11 East, Willamette Meridian
Section 19: Lot 4; SE $\frac{1}{4}$ SW $\frac{1}{4}$
Section 30: N $\frac{1}{2}$ SE $\frac{1}{4}$

The said easement being 33 feet in width on each side of a centerline as
located on the ground, with such additional width as required for accommo-
dation and protection of cuts and fills, the said centerline being located
and described as shown on the plat which is attached hereto and made a
part hereof.

If the road is located substantially as described herein, the centerline
of the road as constructed is hereby deemed accepted by the Grantor as the
true centerline of the easement granted.

The acquiring agency is the Forest Service, Department of Agriculture.

This conveyance is made subject to the following reservations by the Grantor,
his heirs and assigns:

1. The right to cross and recross the easement at any point and for
any purpose in such manner as will not materially interfere with
the use of the road.
2. The right to all timber now or hereafter growing on the easement
subject to grantee's right to cut timber on the easement to the
extent necessary for constructing, reconstructing, and maintaining
the road. Timber so cut shall, unless otherwise agreed to, be cut
into logs of standard lengths and decked along the road for disposal
by the grantor.

The rights, privileges, and authority herein granted to the United States and
its assigns, including contractors, licensees, and permittees, to remove and
administer the removal of National Forest Products from the proposed Timber
Butte L. P. sale area, estimated to be approximately 9 million board feet, and
the right to perform the resulting slash disposal, sale area betterment, and
related activities on and in the vicinity of the sale area.

This grant shall continue as long as needed for the above purposes, and shall
expire upon completion of the above work, or on July 1, 1976, whichever occurs
first.

IN WITNESS WHEREOF, the said Grantor has hereunto set its hand and seal on the
day and year first above written.



GILCHRIST TIMBER COMPANY

By: James R. Gilchrist
President

MAR 16 1 24 PM 1972

MAR 17 3 22 PM 1972

MAR 17 9 38 AM 1972

MAR 16 1 26 PM 1972

FORM N
1967/50

Attest:

By: Wayne H. Ernst
SecretarySTATE OF OREGON)
) ss.
COUNTY OF KLAMATH)

On this 13 day of MARCH, 1972, before me the under-
signed, a Notary Public in and for said county and State, personally
appeared FRANK R. GILCHRIST and WAYNE H. ERNST,
known to me to be the PRESIDENT and SECRETARY
of GILCHRIST TBR. Co., the PERSONS that
executed the within instrument, known to me to be the persons who executed
the within instrument on behalf of the GILCHRIST TBR. Co. therein named,
and acknowledged to me that such COMPANY executed the within
instrument pursuant to its bylaws or a resolution of its BOARD OF
DIRECTORS.

WITNESS my hand and Official Seal,

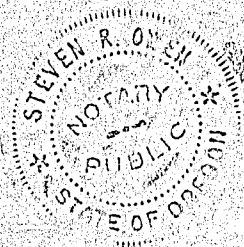

Steven R. Owen
Notary Public in and for said
County and State
My Commission Expires Oct. 5, 1974
My commission expires _____

MAR 17 3 22 PM 1972

MAR 17 9 38 AM 1972

MAR 16 1 24 PM 1972

2839

5460 RIGHTS-OF-WAY ACQUISITION
 GILCHRIST TIMBER COMPANY
 DAVIS FLAT ROAD NO. 2657
 LOT 4, SE1/4 SEC. 19 AND NW1/4 SEC. 30
 T. 26 S., R. 11 E., W.M.
 FREMONT NATIONAL FOREST
 KLAMATH COUNTY, OREGON
 PLATTED BY: E. THOMAS 3-6-72

SCALE: 2 INCHES = 1 MILE

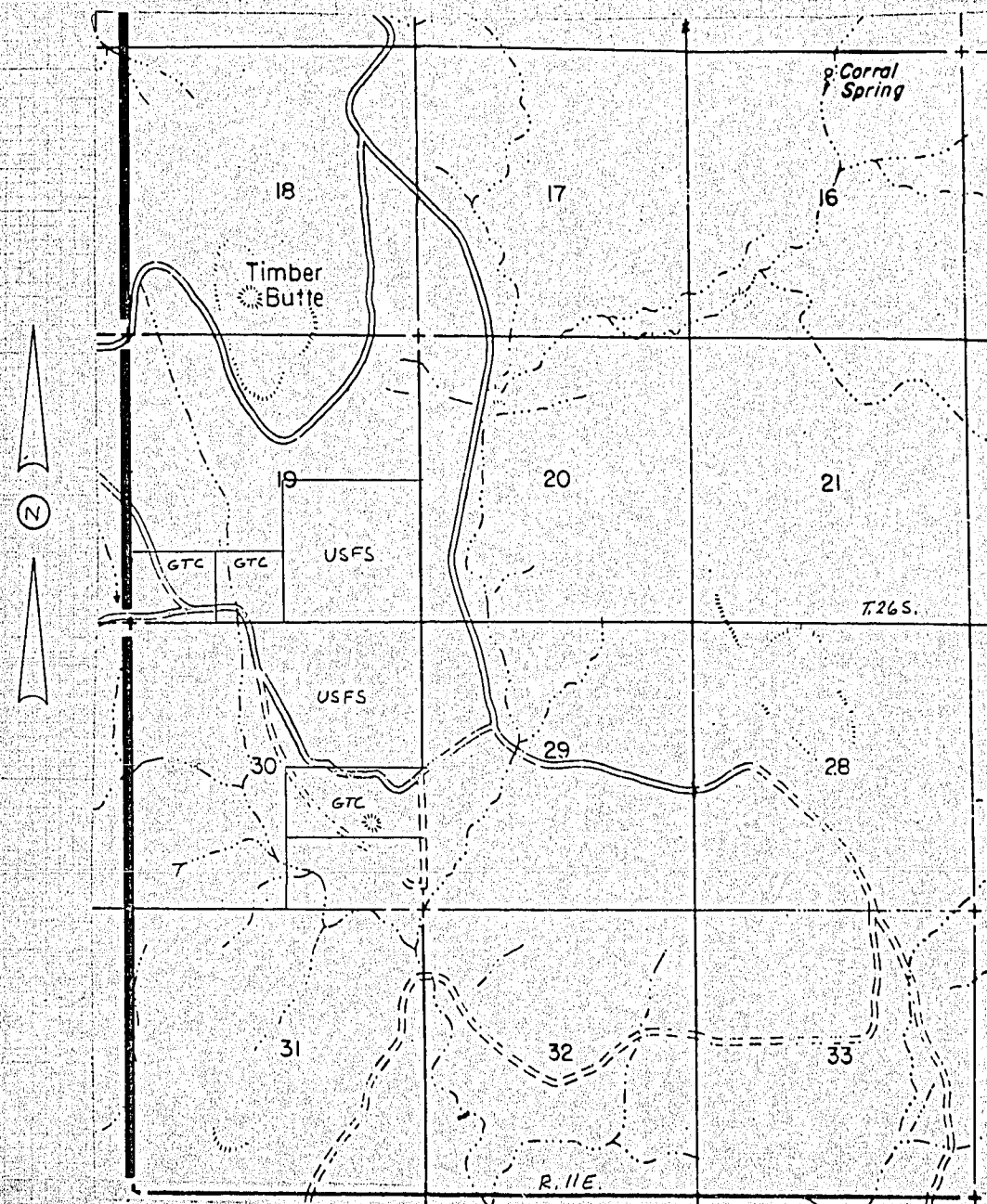

STATE OF OREGON; COUNTY OF KLAMATH; ss.

Filed for record at request of DEPT OF AGRICULTURE FOREST SERVICE

this 16 day of MARCH A. D., 1972 at 1:44 o'clock P.M., and duly recorded in

Vol. M 72 of DEEDS on Page 2837

FEE \$6.00

WM. D. MILNE, County Clerk

By *Hazel Dragan*FORM NO.
1967/50MAR 17 3 52 PM 1972
MAR 17 9 38 AM 1972

MAR 16 1 44 PM 1972