

86040

RIGHT OF WAY EASEMENT  
(CORPORATE)Vol. 74 Page 2438

For value received the undersigned Grantor Loveness Company does hereby grant to PACIFIC POWER & LIGHT COMPANY, a corporation, its successors and assigns, the Grantee, an easement or right of way for a stubble and anchors (including guys and other supports) at or near the location as now located and staked out by the Grantee over, across and upon the following described real property in Klamath County, State of Oregon, to wit:

A portion of the Southwest Quarter of Section 19, Township 41 South, Range 13 East, W.M. as more particularly described at Volume 355, Page 585 deed records of said county.

Feb 15 9 45 AM 1974  
Anchors and guys to be located on the above described property as shown on the attached map marked EXHIBIT "A".

Together with the right of ingress and egress over the adjacent lands of the Grantor for the purpose of construction, reconstruction, maintaining and removing such guys and appurtenances, and exercising the rights hereby granted.

The Grantee shall pay to the Grantor reasonable compensation for any damage caused by Grantee, or its agents, to any property or crops (growing or to be grown) on the above described real property, arising out of the construction, reconstruction, operation or maintenance of said anchors and guys.

All rights hereunder shall cease if and when such lines shall have been abandoned.

Dated this 12<sup>th</sup> day of February, 1974.

(SEAL)

Loveness Company

Attest:

B. Loveness  
Secretary

By

H. K. Loveness  
PresidentSTATE OF OREGONCOUNTY OF KLAMATH

} ss

Personally appeared H. K. LOVENESS and R. E. LOVENESS who, being duly sworn, did say that they are the Secretary and President of LOVENESS COMPANY and that the seal affixed to the foregoing instrument is the corporate seal of said corporation and that said instrument was signed and sealed in behalf of said corporation by authority of its board of directors; and they acknowledge said instrument to be its voluntary act and deed. Before me:

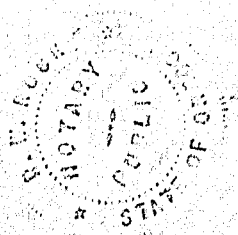
Notary public for Klamath County OregonMy commission expires: 4-11-77

Ref. G. 242.  
Ref. 728 -  
K. 3. 11. 77

2439

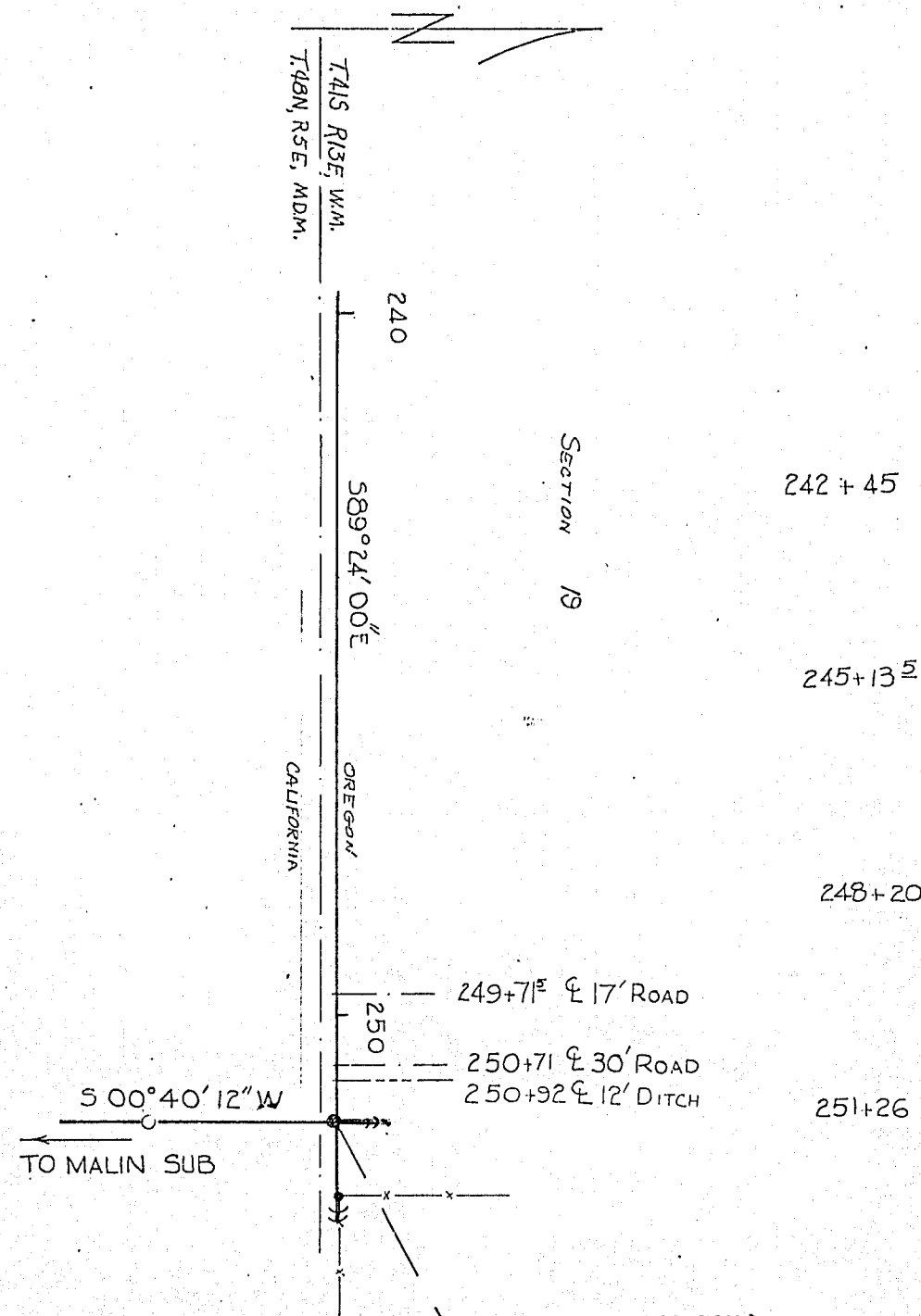

PACIFIC POWER & LIGHT CO.

Loveness Company

SECTION 19 T41S, R13E, W4M.

Klamath COUNTY, Oregon

DATE GRANTORS

SCALE 1"=200' EXHIBIT "A"

C.L. LENGTH ACRES

APR 15 1974  
5 00°40'12"W

STATE OF OREGON, }  
County of Klamath } ss.

Filed for record at request of:

PACIFIC POWER & LIGHT CO

on this 15th day of FEBRUARY A. D., 1974

at 9:43 o'clock A. M. and duly

recorded in Vol. M 74 of DEEDS

Page 2438

WM. D. MILNE, County Clerk

Fee \$ 4.00 By Hazel Craig Deputy.