

1986

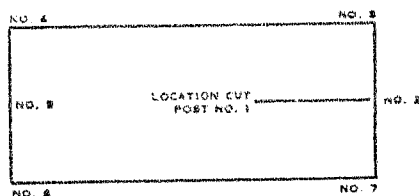

## Notice of Mining Location

STATE OF OREGON,

County of CLATSOP

Mining District

NOTICE IS HEREBY GIVEN That the undersigned, having complied with the requirements of Chapter Six of Title Thirty-Two, of the revised statutes of the United States, and the laws of the above State, and the local customs and regulations of said District have located and do hereby locate linear feet in length, and feet in width on the Lucky B. B. lode, vein, ledge or deposit situated in the above State, County and Mining District, and further described as follows:

Commencing at a post marked No. 1 at the Discovery shaft (cut or tunnel), from thence  
100 feet in a NORTHERLY direction to an end post marked No. 2, thence  
300 feet in a WESTERLY direction to a corner post marked No. 3, thence  
1500 feet in a SOUTHERLY direction to a corner post marked No. 4, thence  
300 feet in a EASTERLY direction to an end post marked No. 5, thence  
300 feet in a EASTERLY direction to a corner post marked No. 6, thence  
1500 feet in a NORTHERLY direction to a corner post marked No. 7, thence  
300 feet in a WESTERLY direction to said end post marked No. 2; hereby locating and intending to claim 100 feet in a NORTH direction from discovery to the NORTH end line and 1400 feet in the opposite direction from discovery to the SOUTH end line and 300 FT feet on each side of the middle of said lode or ledge, for the purpose of mining the same and claiming all the surface rights, privileges and minerals, with all dips, spurs, angles and variations, and other rights granted by existing laws and customs. This claim is further described as follows (and state distance from natural object or permanent monument, Section, Township and Range, if possible):

THIS CLAIM IS LOCATED AT THE HEAD OF SE FORK OF FLYCREEK T25S R1E SEC 31 NW 1/4 Gold & Silver

The adjoining claims are NONE

This notice is placed at discovery on post No. 1; posts are placed at each corner and both center ends, and the name of this lode and date of location are placed on all posts.

Located this 31st day of May, A.D. 1975

Witnesses:

Heland E. Wing  
 Locater.

RECEIVED JUN 4 1975

STATE OF OREGON,

County of Clatsop

6111

I, Leland E. Wing, do solemnly swear that I am a citizen of the United States of America (or have declared my intentions to become such), and that I am acquainted with the mining ground described in this notice of location, and herewith called the

Lucky B & B

ledge, lode, or claim; that the ground and claim therein described, or any part thereof, has not to the best of my knowledge and belief, been located according to the laws of the United States, and of this State, or if so located, that the same has been abandoned and forfeited by reason of the failure of such former locators to comply in respect thereto with the requirements of said laws and that I have sunk a discovery shaft upon said claim to a depth of ten feet from the lowest part of the rim of said shaft at the surface—made a cut or cross cut or tunnel which cuts the lode at a depth of ten feet—made an open cut six feet deep, four feet wide and ten feet in length along the lode, from the point of discovery, showing a lode or vein of mineral deposit in place.

Subscribed and sworn to before me, this 31st day of May, 1975

E. L. Schuman  
Notary Public for Oregon.  
My Commission expires MARCH 3, 1979

# Mining Location LODE (FORM No. 530)

Name of Claim.

Locators.

STATE OF OREGON,

County of KLATHA

I certify that the within instrument was received for record on the 2nd day of June, 1975, at 1:00 o'clock P. M., and recorded in book M 75, on page 6110.  
Record of MINING RECORD  
of said County.

Witness my hand and seal of  
County affixed.

WM. D. MILNE

County Clerk—Recorder.

Deputy.

STEVENS-NESS LAW PUB. CO., PORTLAND, ORE.

1204 134

Ernest Ch...

## Necessary steps in locating a quartz claim.

1. Post notice of location at point of discovery.
2. Stake claim within 30 days of date of discovery.
3. Dig location cut or shaft within 60 days of date of discovery.
4. File copy of notice of location with county clerk or recorder for the county in which the claim is located. Filing fee is \$1.00 per claim. Notice may be mailed in for recording. Notice should be recorded within 60 days from the posting of the notice on the claim.

## Area and shape of a quartz claim.

A quartz claim can be not more than 1500 feet in length and can extend not more than 300 feet on either side of the center line (Fig. 1-A). A full sized quartz claim embraces an area of slightly more than 20½ acres. Although most claims are rectangular they may have a variety of shapes, the only requirement being that the end-lines be parallel. In the case of non-rectangular claims it should be noted that the end-lines need not be limited to 600 feet in length (Fig. 1-B).

## Requirements of a quartz claim (Fig. 1-C).

1. Location notice posted at or near point of discovery.
2. Discovery cut or shaft. Discovery cut must be at least 4 feet wide, 10 feet long and 6 feet high at the face. A discovery shaft must be sunk at least 10 feet deep from the lowest part of the rim.
3. Four claim corner posts, or monuments, and two center end posts, or monuments. All posts must be at least 4 inches square or in diameter, and must project at least 8 feet above the ground. Monuments of stone, or earth and stone, must be at least 2 feet in height.

## Quartz or placer location.

Quartz claims are located where minerals occur in place in veins or lodes. Most metal mines are quartz locations.

Placer claims are located where minerals have been derived from rocks or veins to form deposits such as stream gravels and gold-bearing alluvium. Massive deposits of nonmetallic minerals such as limestone, building stone, and pumice are generally located as placer claims.

FIG. 1 (A)

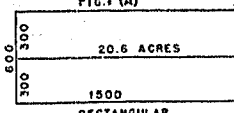

FIG. 1 (B)

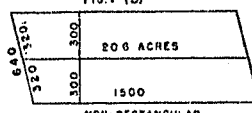

FIG. 1 (C)

