

42563

RIGHT-OF-WAY EASEMENT
(Corporate)Vol. m 78 Page 2040

For value received, WASHBURN ENTERPRISES, INC.,
a OREGON corporation, hereinafter referred to as Grantor, does hereby grant to PACIFIC
POWER & LIGHT COMPANY, a corporation, its successors and assigns, the Grantee, an easement or right-
of-way for an electric transmission and distribution line of one or more wires and all necessary or desirable ap-
purtenances (including telephone and telegraph wires, towers, poles, props, guys, anchors and other supports
and the right to place all or any part of such line underground) at or near the location and along the general
course now located and staked out by the Grantee over, across and upon the following described real property
in KLAMATH County, State of OREGON, to wit:

SITUATED IN THE NORTHEAST QUARTER OF THE SOUTHEAST QUARTER OF SECTION
4, TOWNSHIP 39 SOUTH, RANGE 9 EAST, WILLAMETTE MERIDIAN.

SAID RIGHT-OF-WAY TO BE 5 FEET WIDE, SITUATED ON THE SOUTH SIDE OF
THE NORTHERLY PROPERTY LINE.

" FOR THE INSTALLATION OF AN UNDERGROUND ELECTRICAL CIRCUIT, AS MORE
PARTICULARLY SHOWN ON EXHIBIT "A" ATTACHED HERETO AND BY THIS REFERENCE
MADE A PART HEREOF."

Together with the right of ingress and egress over the adjacent lands of the Grantor for the purpose of con-
structing, reconstructing, stringing new wires on, maintaining and removing such line and appurtenances, and
exercising other rights hereby granted.

Grantor reserves the right to use said right-of-way for roads, agricultural crops or other purposes not incon-
sistent with the easement granted hereby, but in using or operating any irrigation pipes, motorized vehicles or
other equipment, or in any other such use of said right-of-way, Grantor (including its successors or assigns)
shall conform strictly to the provisions of any then applicable safety code or regulations pertaining to required
clearances from the wires or conductors of such line.

All rights hereunder shall cease if and when such line shall have been abandoned.

Dated this 6th day of Dec., 1977.

Washburn Enterprises, Inc.
By: Norman A. Turner, Pres.
DORMAN A. TURNER (Title)

Attest: Jewell Huston, Sec.
JEWELL HUSTON (Title)

STATE OF Ore
County of Klamath } ss.

On this 6th day of Dec., 1977, before me personally appeared
Dorman A. Turner, to me personally known to be the Pres.
of the corporation that executed the within and foregoing instrument; who, duly sworn, on oath did say: that
he is the Pres. of the corporation that executed the within foregoing instrument; that the
seal affixed to said instrument is the corporate seal of said corporation, and that said instrument was signed and
sealed in behalf of said corporation by authority of its Board of Directors, and he acknowledged said instrument
to be the free act and deed of said corporation for the uses and purposes therein mentioned.

IN WITNESS WHEREOF, I have hereunto set my hand and official seal the day and year above written.

Notary Public for Oregon
Residing at Blanchard, Idaho
My commission expires April 8, 1980

Return to
Pacific Power
P.O. Box 728
K.T.

778 FEB 2 1978

2041

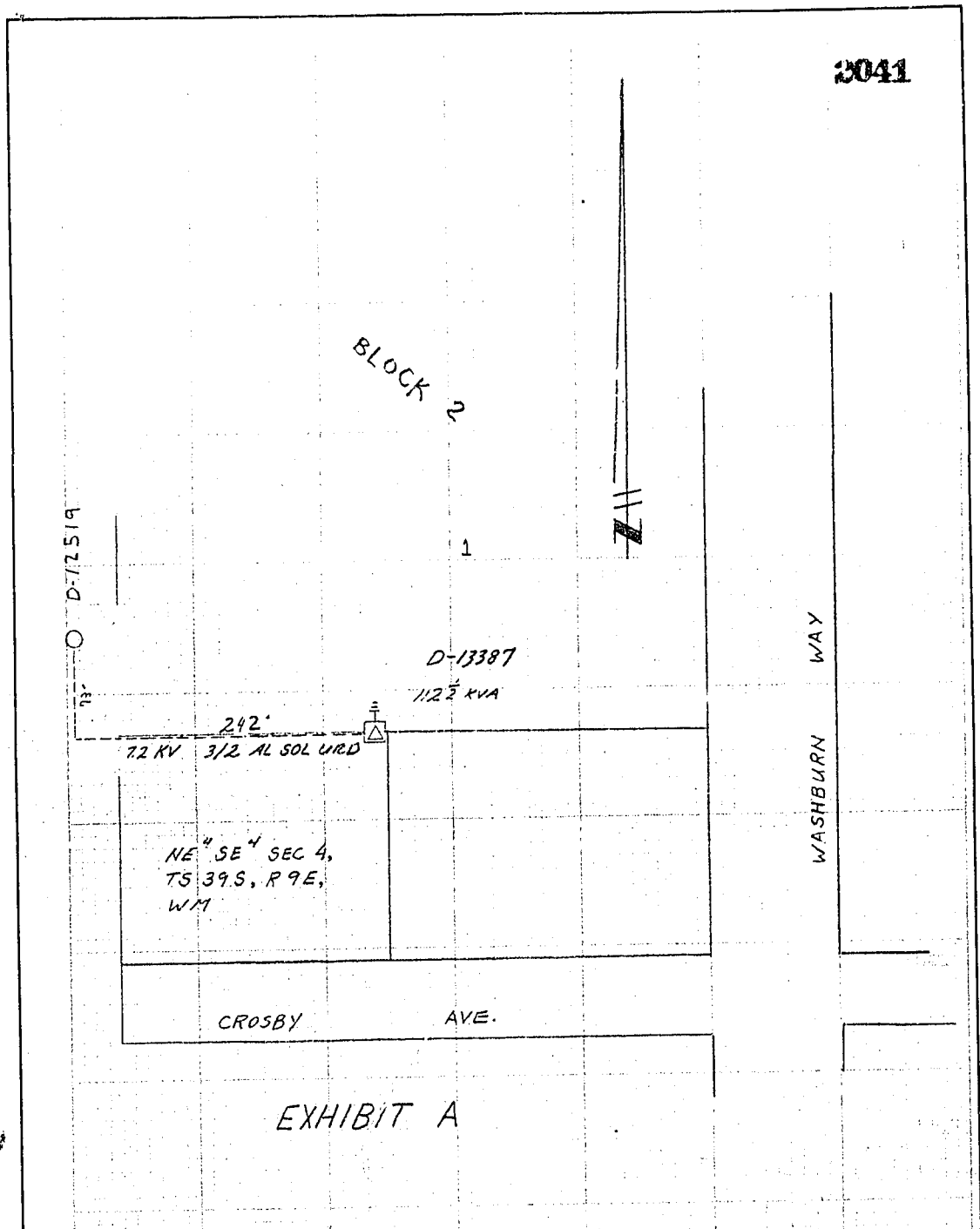

EXHIBIT A

DISTRICT <u>KLAMATH</u>		
NAME <u>LUCCA CAFE</u>	FILE NO.	<u>136-8701</u>
LOCATION <u>2400 CROSBY</u>	E R NO.	<u>31-710</u>
MAP NO. <u>D-69-2-B</u>	W.O.	<u>9913</u>
DRAWN <u>19 27</u>		

PACIFIC POWER & LIGHT COMPANY
E R SKETCH
SCALE 1"=100'

STATE OF OREGON; COUNTY OF KLAMATH; ss.

I hereby certify that the within instrument was received and filed for record on the 2nd day of February A.D., 19 78 at 2:54 o'clock P M., and duly recorded in Vol M78 of Deeds on Page 2040.

FEE \$6.00

WM. D. MILNE, County Clerk
By Bernard J. Letoch Deputy