

13074

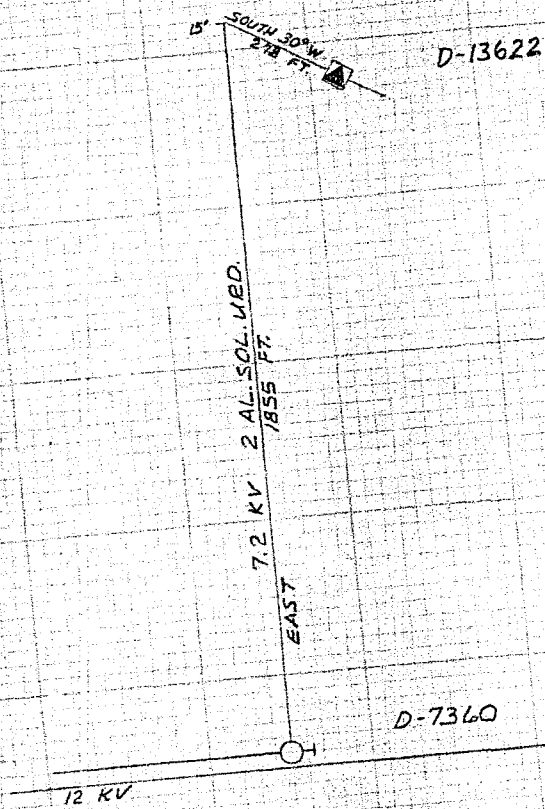

EXHIBIT "A"

P.P.B. &  
PO Box 928  
Klamath Falls  
4/6 C.B.UT

DISTRICT <u>KLAMATH</u>		
NAME <u>CLIFF PEERY</u>	FILE NO.	<u>136-9226</u>
LOCATION <u>REEDER RD.</u>	ER NO.	<u>31-710-136</u>
MAP NO. <u>D-28-9</u>	W.O.	<u>10417</u>
DRAWN <u>J. COX 6/11/78</u>		

PACIFIC POWER & LIGHT COMPANY  
E R SKETCH

SCALE 1" = 400'

I hereby certify that the within instrument was received and filed for record on the 20th day of June A.D., 19 78 at 8:31 o'clock A M., and duly recorded in Vol M78 of Deeds on Page 13073.

FEE \$6.00

WM. D. MILNE, County Clerk  
By Bernard H. H. H. H. Deputy