

53066

Vol. ^m 78 Page 17415File No. 136-9315
ER/WO No. 31-710-136
10505RIGHT-OF-WAY EASEMENT
(Individual)

For value received the undersigned, hereinafter referred to as Grantors, (whether singular or plural), do hereby grant to PACIFIC POWER & LIGHT COMPANY, a corporation, its successors and assigns, the Grantee, an easement or right-of-way for an electric transmission and distribution line of one or more wires and all necessary or desirable appurtenances (including telephone and telegraph wires, towers, poles, props, guys, anchors and other supports and the right to place all or any part of such line underground) at or near the location and along the general course now located and staked out by the Grantee over, across and upon the following described real property in KLAMATH County, State of OREGON, to wit:

LOCATED IN THE SE $\frac{1}{4}$ OF THE SW $\frac{1}{4}$, SEC. 22, T.39S., R.8E., W.M.

"AS MORE PARTICULARLY SHOWN ON EXHIBIT "A" ATTACHED HERETO
AND BY THIS REFERENCE MADE A PART HEREOF."

Together with the right of ingress and egress over the adjacent lands of the Grantors for the purpose of constructing, reconstructing, stringing new wires on, maintaining and removing such line and appurtenances, and exercising other rights hereby granted.

Grantors reserve the right to use said right-of-way for roads, agricultural crops or other purposes not inconsistent with the easement granted hereby, but in using or operating any irrigation pipes, motorized vehicles or other equipment, or in any other such use of said right-of-way, Grantors and Grantors' heirs or assigns, shall conform strictly to the provisions of any then applicable safety code or regulation pertaining to required clearances from the wires or conductors of such line.

All rights hereunder shall cease if and when such line shall have been abandoned.

Dated this 4th day of August, 19 78

(SEAL) Jesse Patterson (SEAL)

(SEAL) Elizabeth Anne Patterson (SEAL)

STATE OF Oregon

County of Klamath

On this 4th day of August, 19 78, personally appeared before me a notary public in and for said State, the within named Jesse Patterson and Elizabeth Anne Patterson, Husband & Wife to me known to be the identical person s described therein and who executed the foregoing instrument, and acknowledged to me that they executed the same freely and voluntarily for the uses and purposes therein mentioned.

IN WITNESS WHEREOF, I have hereunto set my hand and official seal the day and year above written.

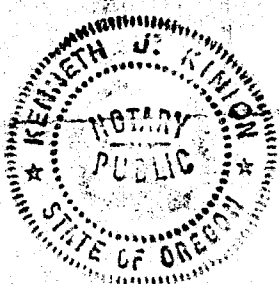

Kenneth J. Kinion
Notary Public for Oregon
Residing at Klamath Falls
My commission expires: April 30, 1982

PP & L
P.O. Box 728
K.F.O.

78 AUG 9 AM 8 46

17416

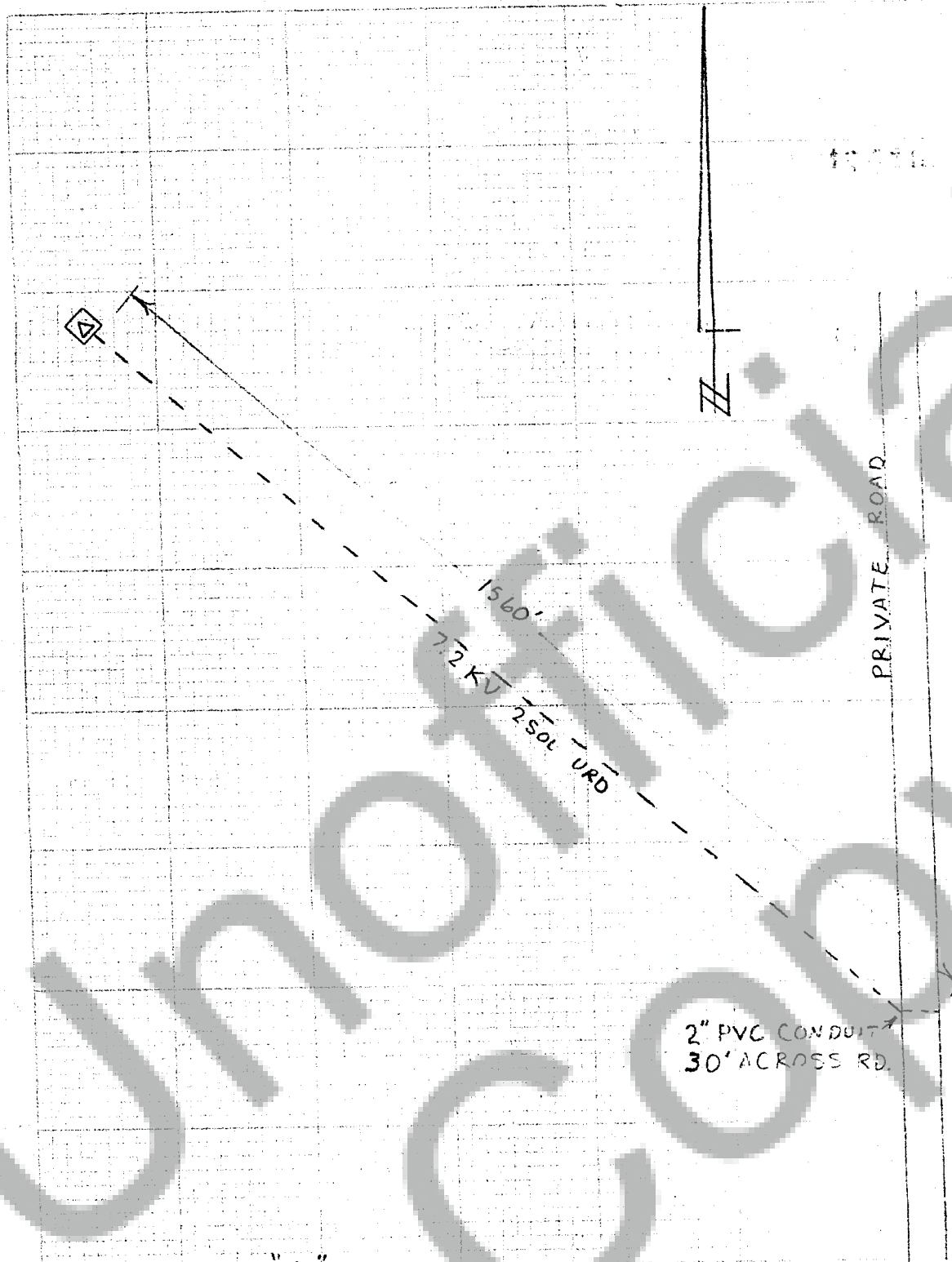

EXHIBIT "A"

DISTRICT KLAMATH

NAME <u>JESSE PATTERSON</u>	FILE NO. <u>136-9315</u>
LOCATION	E R NO. <u>31-710-136</u>
MAP NO. <u>C-50-B-A</u>	W.O. <u>10525</u>
DRAWN <u>16</u>	

PACIFIC POWER & LIGHT COMPANY

E R SKETCH

SCALE 1 = 200'

FORM 8708 - 7/74

STATE OF OREGON; COUNTY OF KLAMATH; ss.

I hereby certify that the within instrument was received and filed for record on the 9th day of August A.D., 19 78 at 8:46 o'clock A M., and duly recorded in Vol. 178 of Deeds on Page 17415.

FEE \$6.00

WM. D. MILNE, County Clerk

By Bernetha Shelton Deputy