

MEMORANDUM OF ASSIGNMENT

* * * * *

THIS INDENTURE, Made and entered into this 2nd day of November, 1979 by and between PONDEROSA POTATO DISTRIBUTORS, INC., an Oregon coporation (hereinafter called Secured Party), PAUL LANSDOWNE, trustee in bankruptcy, (hereinafter called Assignor) and K-C WOOD PRODUCTS, INC., an Oregon corporation, ELMER R. COLSON, GENEVIEVE J. COLSON, WILBER R. KEEN and BRENDA J. KEEN, (hereinafter called Assignees);

W I T N E S S E T H:

Assignor, PAUL LANSDOWNE, trustee in bankruptcy, through an Order filed in Bankruptcys Nos. 79-624, 625 and 626 in the United States District Court for the District of Oregon, acquired all of the right, title and interest of THOMAS BOULTON and BRENDA L. BOULTON, in that certain Conditional Sales Contract and Security Agreement, dated the 9th day of October, 1978, and recorded on October 10, 1978 as document #22627, wherein Secured Party agreed to sell and THOMAS BOULTON and BRENDA L. BOULTON agreed to buy, all of the following described property situated in Klamath County, State of Oregon:

That certain sheet metal building located on Southern Pacific property at Stukel Station, more particularly described on Exhibit "A" attached hereto and by this reference made a part hereto, and specifically as item #1, and further described on the 1977-78 tax rolls of Klamath County, Oregon, as Lot 1, Block 40, Range 9 WAREHOUSE AT STUKEL #1, Account #0070-122-A00-000-000.

WHEREAS, the Secured Party and Assignor have executed a document entitled "ASSIGNMENT", dated the 2 day of November 1979, wherein Assignor has agreed to sell, transfer and assign unto said Assignees, all of Assignor's right, title and interest in and to the above-mentioned Conditional Sales Contract and

970 NOV 19 1979

Handwritten initials or marks at the bottom left corner.

27123

Security Agreement;

WHEREAS, said Assignment has provided for the sale of certain real property therein described; and,

WHEREAS, said Assignment provides, among other things, that upon payment of the sum of \$17,120.51 Dollars plus interest at the rate of nine per cent per annum on the unpaid balance, until the principal and interest have been paid in full, said amount allocated to the property, Secured Party will convey to Assignees the above described property by a Bill of Sale;

NOW, THEREFORE, the parties agree that the within Memorandum is executed for the purpose of memorializing of record the execution of the Assignment aforesaid.

IN WITNESS WHEREOF, The parties have hereunto set their hands the day and year first above written.

PONDEROSA POTATO DISTRIBUTORS, INC.,
an Oregon corporation

by: Leed Clugne
President

by: Ralph Hill
Secretary

Paul Lansdowne
PAUL LANSDOWNE, Trustee in Bankruptcy

K-C WOOD PRODUCTS, INC., an
Oregon corporation

by: Wilber R. Keen
President

by: Brenda J. Keen
Secretary

Elmer R. Colson
ELMER R. COLSON

Genevieve J. Colson
GENEVIEVE J. COLSON

Wilber R. Keen
WILBER R. KEEN

Brenda J. Keen
BRENDA J. KEEN

STATE OF OREGON)
County of Klamath) ss.

27124

Personally appeared LELAND CHEYNE and RALPH HILL, who being first duly sworn, did say that he is the President and Secretary respectively of PONDEROSA POTATO DISTRIBUTORS, INC., an Oregon corporation, and that the seal affixed to the foregoing instrument is the corporate seal of said corporation, and that said instrument was signed and sealed on behalf of said corporation by authority of its Board of Directors; and he acknowledged said instrument to be its voluntary act and deed.

BEFORE ME:

Susan Kay Way
Susan Kay Way
Notary Public for Oregon
NOTARY PUBLIC FOR OREGON
My Commission Expires: 6/4/98

STATE OF OREGON)
County of Lane) ss.

Personally appeared PAUL LANSDOWNE, as the trustee in bankruptcy, and acknowledged the foregoing instrument to be his voluntary act and deed.

BEFORE ME:

Vicki H. Boyd
Vicki H. Boyd
Notary Public for Oregon
NOTARY PUBLIC FOR OREGON
My Commission Expires: 5/31/81

STATE OF OREGON)
County of Klamath) ss.

Personally appeared *Wilbur R. Keen* and *Brenda J. Keen* who being first duly sworn, did say that he is the President and Secretary respectively of K-C WOOD PRODUCTS, INC., an Oregon corporation, and that the seal affixed to the foregoing instrument is the corporate seal of said corporation, and that said instrument was signed and sealed on behalf of said corporation by authority of its Board of Directors; and he acknowledged said instrument to be its voluntary act and deed.

BEFORE ME:

Susan Kay Way
Susan Kay Way
Notary Public for Oregon
NOTARY PUBLIC FOR OREGON
My Commission Expires: 6/4/98

STATE OF OREGON)
County of Klamath) ss.

Personally appeared ELMER R. COLSON and GENEVIEVE J. COLSON, husband and wife, and acknowledged the foregoing instrument to be their voluntary act and deed.

BEFORE ME:

Susan Kay Way
Susan Kay Way
Notary Public for Oregon
NOTARY PUBLIC FOR OREGON
My Commission Expires: 6/4/98

MEMORANDUM OF
ASSIGNMENT, PAGE THREE.

STATE OF OREGON)
) ss.
County of Klamath)

27125

Personally appeared WILBER R. KEEN and BRENDA J. KEEN, husband and wife, and acknowledged the foregoing instrument to be their voluntary act and deed.

BEFORE ME:

Susan Kay Way
Susan Kay Way
Notary Public for Oregon
My commission expires 6/4/98

NOTARY PUBLIC FOR OREGON
My Commission Expires: _____

27126

547.06

E.S. 337 + 37.4
STUKEL
M.P. 547.11

C.F.A. 547.06 - R
Non-Contig. R/W

OREGON
DRAWING L-2199.1
SHEET NO.

TO FLANIGAN

TO KLAMATH FALLS

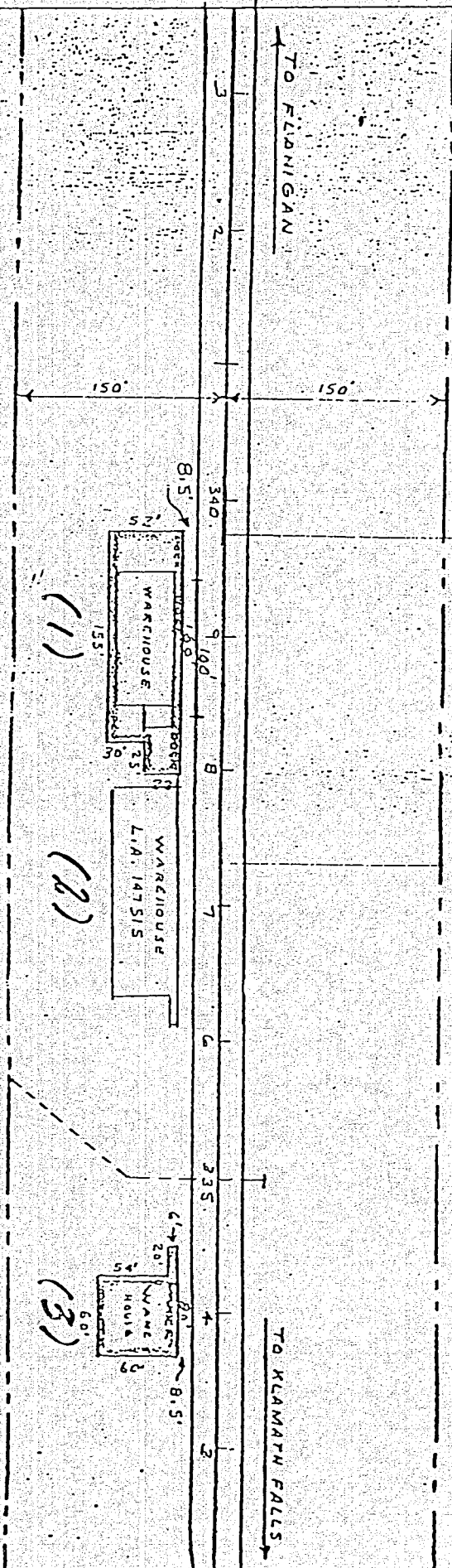

LEGEND

Shows lease area; 12,330 sq. ft.
Red Shows track.

Lease for Warehouses and 100 Ft. of Track
Leland Cheney, Ralph Hill, Howard Manning, Thomas Lasset
Gerald Arnt and Jerry Deputy.

SOUTHERN PACIFIC COMPANY

PACIFIC LINES
MOGOC LINE
STUKEL

Shows S.P.T. Co. Property line

Scale: 1" = 100'
M.G. Sept. 15, 1971

STATE OF OREGON; COUNTY OF KLAMATH; ss.

I hereby certify that the within instrument was received and filed for record on the 19th day of November A.D., 1979 at 3:18 o'clock P.M., and duly recorded in Vol M79 of Needs on Page 27122.

WM. D. MILNE, County Clerk
By Barbara DeLoach Deputy

FEE \$17.50

V-35
7