

8051 37021

79903

File No. 137-1456
ER/WO No. 700/3223RIGHT-OF-WAY EASEMENT
(Individual)Vol. ^m 80 Page 1702

For value received the undersigned, hereinafter referred to as Grantors, (whether singular or plural), do hereby grant to PACIFIC POWER & LIGHT COMPANY, a corporation, its successors and assigns, the Grantee, an easement or right-of-way for an electric transmission and distribution line of one or more wires and all necessary or desirable appurtenances (including telephone and telegraph wires, towers, poles, props, guys, anchors and other supports and the right to place all or any part of such line underground) at or near the location and along the general course now located and staked out by the Grantee over, across and upon the following described real property in Klamath County, State of Oregon, to wit:

A portion in the SW $\frac{1}{4}$ of Section 7,
Township 36 South, Range 13 East, W.M.

Together with the right of ingress and egress over the adjacent lands of the Grantors for the purpose of constructing, reconstructing, stringing new wires on, maintaining and removing such line and appurtenances, and exercising other rights hereby granted.

Grantors reserve the right to use said right-of-way for roads, agricultural crops or other purposes not inconsistent with the easement granted hereby, but in using or operating any irrigation pipes, motorized vehicles or other equipment, or in any other such use of said right-of-way, Grantors and Grantors' heirs or assigns, shall conform strictly to the provisions of any then applicable safety code or regulation pertaining to required clearances from the wires or conductors of such line.

All rights hereunder shall cease if and when such line shall have been abandoned.

Dated this 17th day of JANUARY, 19 79

Kenneth W. Dolglish (SEAL) Lemard S. Seifer (SEAL)
Patricia D. Dolglish (SEAL) Martha Seifer (SEAL)

STATE OF CALIF.

County of SANTA CLARA

ss.

On this 17th day of JANUARY, 19 79, personally appeared before me a notary public in and for said State, the within named CALIF.

to me known to be the identical person described therein and who executed the foregoing instrument, and acknowledged to me that HE executed the same freely and voluntarily for the uses and purposes therein mentioned.

IN WITNESS WHEREOF, I have hereunto set my hand and official seal the day and year above written.

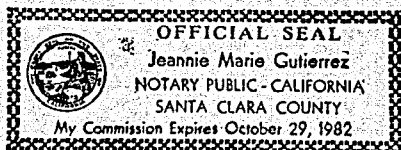

Jeannie Marie Gutierrez
Notary Public for NORTHERN CALIF. SAVINGS AND LOAN
Residing at MORGAN HILL, CALIF.

My commission expires: OCTOBER 29, 1982

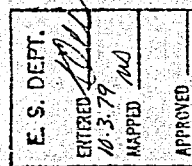

Return To
TERRY LAMB
- PFL
Box 431
LAKEVIEW, OREGON
97630

1703

THEME: YAN-TO-THOIR
(Lullaby)

[illegible]

Township 36 South Range 13 East, W.M.
A location in the SW 1/4 of Section 5.

STATE OF OREGON,

County of Marion

SS.

FORM NO. 23 — ACKNOWLEDGMENT
STEVENS-NESS LAW PUB. CO., PORTLAND 5411

BE IT REMEMBERED, That on this 22 day of January, 1979, before me, the undersigned, a Notary Public in and for said County and State, personally appeared the within named Leonard Seifer and Martha Seifer

known to me to be the identical individual S described in and who executed the within instrument and
acknowledged to me that they executed the same freely and voluntarily.

IN TESTIMONY WHEREOF, I

IN TESTIMONY WHEREOF, I have hereunto set my hand and affixed my official seal the day and year last above written.

Notary Public for Oregon
My Commission expires 8-25-82

8-25-82

STATE OF CALIFORNIA

COUNTY OF SANTA CLARA

SS.

On this 17th day of January in the year one thousand nine hundred and 79 before me, Johanna Tacci, a Notary Public, State of California, duly commissioned and sworn, personally appeared PATRICIA G. DALGLEISH

known to me to be the person..... whose nameis... subscribed to the within
instrument and acknowledged to me that S...he..... executed the same.

IN WITNESS WHEREOF I have hereunto set my hand and affixed my official seal in the County of Santa Clara the day and year in this certificate first above written.

Johann Tacci
Notary Public, State of California

My commission expires May 15, 1981

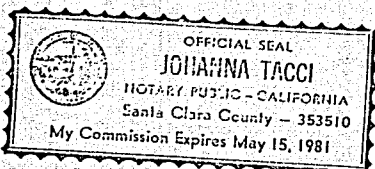

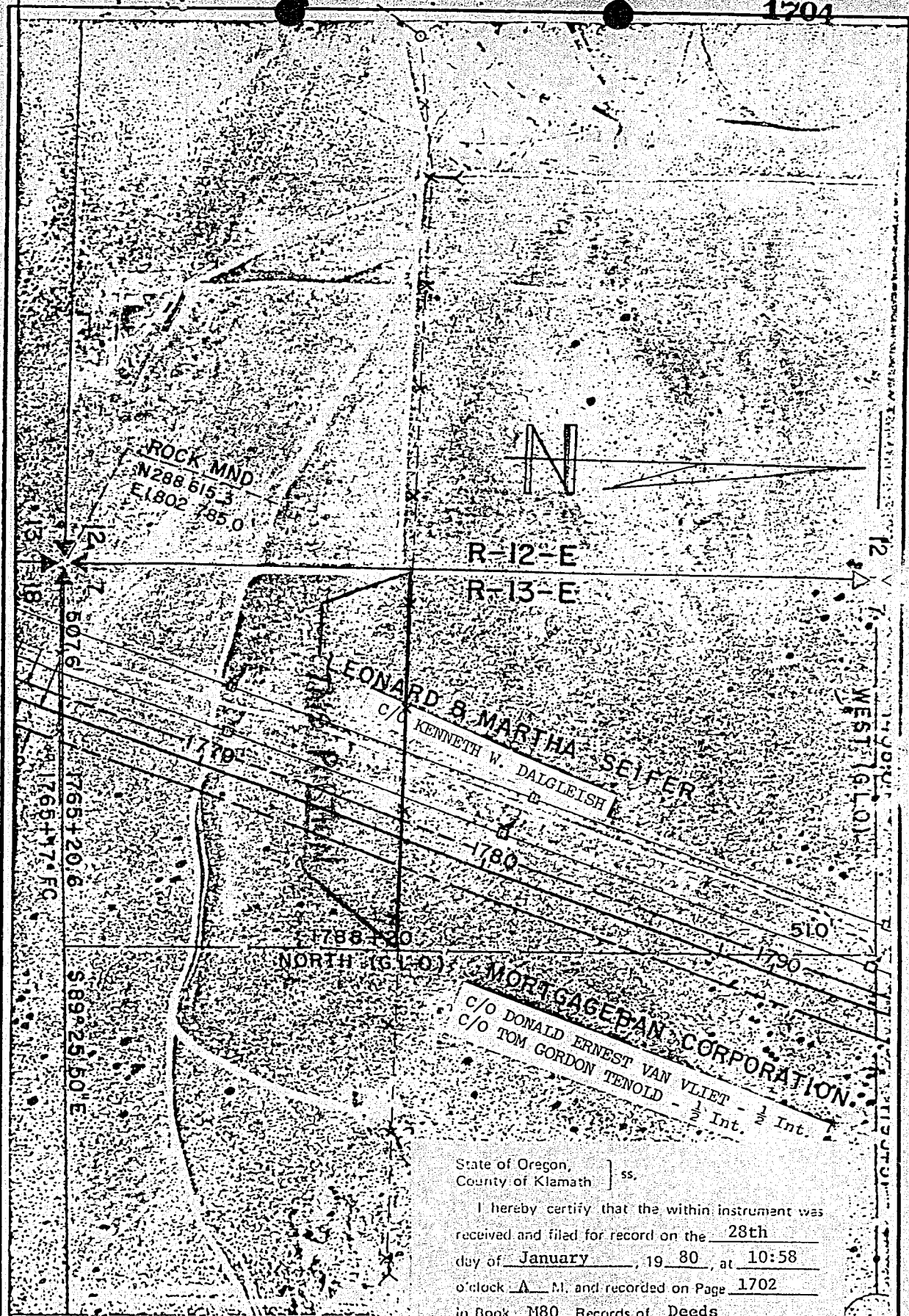

State of Oregon, } ss.
County of Klamath }

I hereby certify that the within instrument was
received and filed for record on the 28th
day of January, 19 80, at 10:58
o'clock A M. and recorded on Page 1702
in Book M80 Records of Deeds
of said County.

WM. D. MILNE, County Clerk

By Bernice H. Hetch Deputy

Fee \$7.00

PACIFIC POWER & LIGHT CO.

Kenneth W. Dalgleish

SECTION 7 T 36 S. R 13 E., W.M.

Klamath COUNTY, Oregon

DATE _____ GRANTORS _____

SCALE 1"=400' EXHIBIT "A"

C.L. LENGTH ACRES

SR VALLEY ACRES. OR.
LEGEND
G & B FRIEDA
ARGO D.