



IN REPLY
REFER TO: MP-420
780.

81625

Vol. ^m 80 Page 4411

United States Department of the Interior
BUREAU OF RECLAMATION

MID-PACIFIC REGIONAL OFFICE
2800 COTTAGE WAY
SACRAMENTO, CALIFORNIA 95825

OCT 3 1978

Mr. and Mrs. John D. Giacomini
Star Route, Box 9
Merrill, Oregon 97633

Mr. J. Anthony Giacomini
635 Main Street
Klamath Falls, Oregon 97601

Dear Mr. and Mrs. John Giacomini
and Mr. J. Anthony Giacomini:

The United States is not at present exercising its rights under the Act of August 30, 1890, and has no plan to exercise its rights thereunder in the foreseeable future, on that portion of the G-3 Lateral that is no longer in use because of its relocation, and a portion of the toe drain adjacent to the "D" Canal. The areas being abandoned are more particularly described as follows:

1. All those portions of the G-3 Lateral located in the NW $\frac{1}{4}$ SE $\frac{1}{4}$, NE $\frac{1}{4}$ SW $\frac{1}{4}$, and the S $\frac{1}{2}$ and the S $\frac{1}{2}$ NW $\frac{1}{4}$ of the SW $\frac{1}{4}$ NW $\frac{1}{4}$ of Section 5, Township 41 South, Range 11 East, W.M., lying outside the right-of-way granted to the United States by John D. and Alameda Giacomini and J. Anthony Giacomini on January 4, 1972, and recorded in Volume M-72 of deeds on Page 162.
2. All that portion of the right-of-way of the existing toe drain on the northerly side of the "D" Canal, including all works constructed thereon, lying west of a point 161.9 feet east of the easterly right-of-way boundary of the Malone Road in the W $\frac{1}{2}$ SW $\frac{1}{4}$ of Section 5, Township 41 South, Range 11 East, W.M., lying outside the right-of-way granted to the United States by John D. and Alameda Giacomini and J. Anthony Giacomini on January 4, 1972, and recorded in Volume M-72 of deeds on Page 162.

80 MAR 7 PM 3 54

The United States also releases all that portion of the easement granted by John D. and Alameda Giacomini on January 4, 1972, described as follows:

A strip of land 30.0 feet in width parallel to, and with its easterly boundary contiguous with, the westerly right-of-way boundary of the Dodds Hollow Road from a point 30.0 feet southerly from the northerly boundary of the NW $\frac{1}{4}$ SE $\frac{1}{4}$ of Section 5, Township 41 South, Range 11 East, W.M., south 1,033 feet, more or less, to the centerline of the existing G-3 Lateral as the same is presently located and constructed; and containing 0.71 acres, more or less.

The United States does not relinquish, abandon, or in any way modify its rights to future utilization of right-of-way reserved to it by the Act of August 30, 1890.

Sincerely yours,

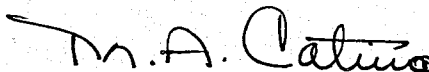

M. A. Catino
Acting Regional Director

Enclosures

Copy to: Klamath Irrigation District
6649 K.I.D. Lane
Klamath Falls, Oregon 97601
(without enclosures)

STATE OF CALIFORNIA)
County of Sacramento) ss.

On this 3rd day of October, 1979, before
me, Gloria M. Simas, a Notary Public in and for
the County and State aforesaid, personally appeared M. A. Catino
Acting Regional Director of the United States
Bureau of Reclamation, Mid-Pacific Region, known to me to be the
person whose name is subscribed to the within instrument, and acknow-
ledged that he executed the same on behalf of the United States.

IN WITNESS WHEREOF, I have hereunto set my hand and affixed
my official seal the day and year in this certificate first above
written.

Gloria M. Simas
Notary Public in and for the County
of Sacramento, State of California

(SEAL)

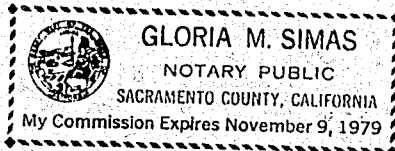

4414

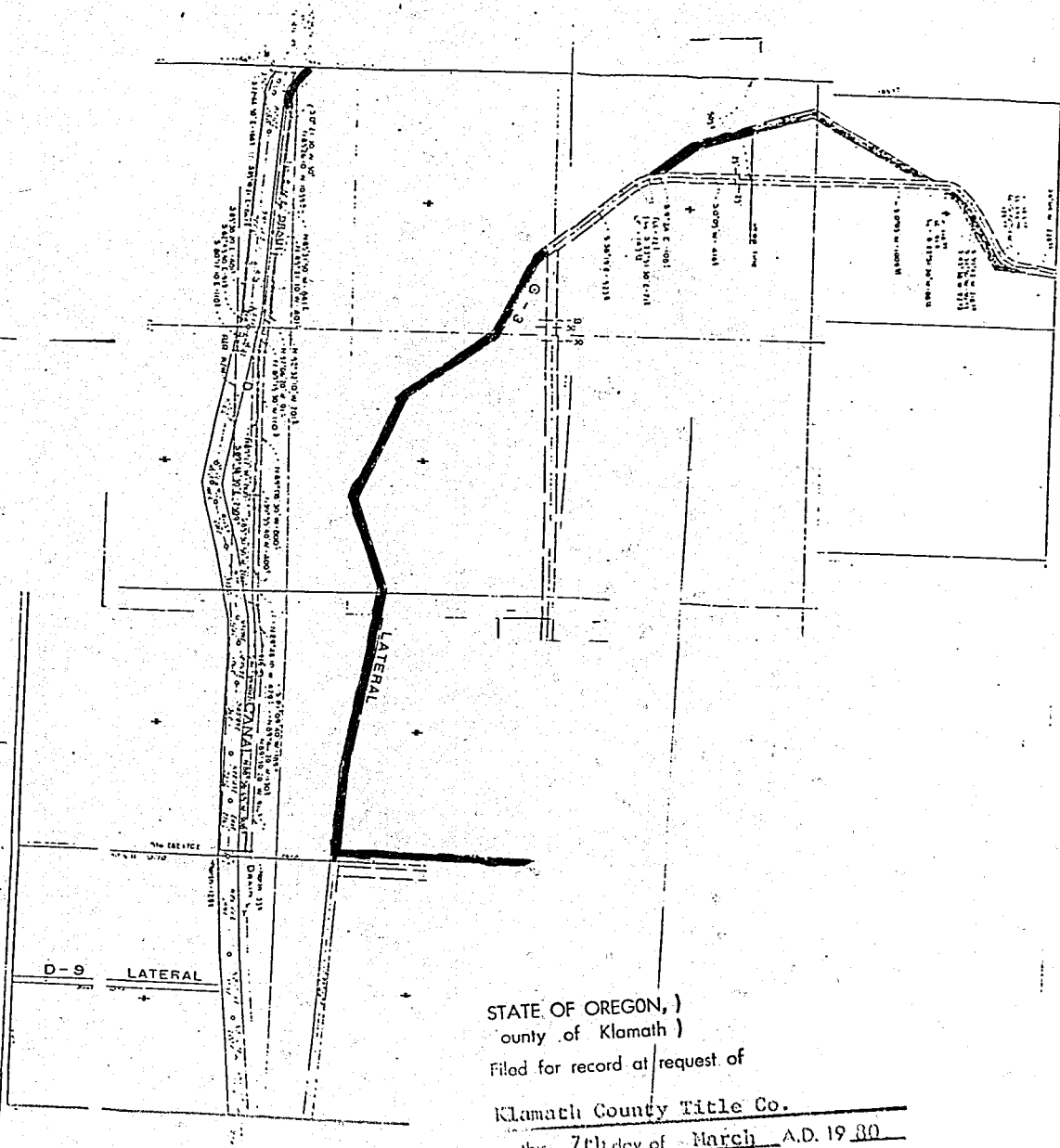

STATE OF OREGON,
County of Klamath)
Filed for record at request of

Klamath County Title Co.

on this 7th day of March A.D. 19 80
at 3:54 o'clock P M, and duly
recorded in Vol. M80 of Deeds
page 4411

Wm D. Milne, County Clerk

By Bernard Phelps Deputy

Fee \$14.00

Return to KETCO
ATTN: Cathy

One