

90948

EASEMENT FOR BURIED CABLE

Vol. 1780

31-70-136-11403

136-10260

Page 19496

WEYERHAEUSER COMPANY, a Washington corporation, herein called "Owner," hereby grants to PACIFIC POWER AND LIGHT COMPANY, a corporation, herein called "Pacific," an easement for an underground electric power cable under, over and across portions of the S $\frac{1}{2}$ NW $\frac{1}{4}$ and NW $\frac{1}{4}$ SW $\frac{1}{4}$ of Section 17, Township 39 South, Range 8 East, W.M., Klamath County, Oregon, located approximately as shown on the attached "Exhibit A."

SUBJECT TO the rights of Pacific Northwest Bell Telephone Company, granted coincidentally herewith, to maintain a telephonic cable in the same trench and to the following terms and conditions:

1. Owner shall have the right to use said strip of land for any purpose not inconsistent with the rights herein granted.
2. Pacific shall have access to the cable for the purpose of exercising the rights herein granted.
3. Pacific releases Owner from any claim for damage to the cable installed by Pacific, arising from any operation of Owner; provided, however, that in the conduct of any such operation, Owner shall use reasonable care to avoid causing such damage.
4. Pacific shall pay for all damages to Owner's property resulting directly or indirectly from the negligent acts or omissions of Pacific hereunder.
5. Pacific shall indemnify and hold harmless Owner from all claims for damages which may be caused by Pacific's exercise of rights herein granted.
6. The easement and rights hereby granted shall continue and be in force for such time as Pacific shall maintain and use the cable; provided, however, that when Pacific shall have ceased to use the cable for a period of two (2) years, all rights and interest of Pacific hereunder shall cease and terminate without notice, but Pacific shall, nevertheless, remain liable for all claims and damages arising hereunder.

DATED this 23rd day of August, 1979.

SEND TO:

C. SCOTT

P. O. BOX 728

KLAMATH FALLS, OR 97601

WEYERHAEUSER COMPANY

By

Land & Timber Resources Manager

Oct. 6, 1980

Kenneth J. Kinton

Notary for Oregon

Residing - Klamath Falls,

My Commission Expires 4-30-82

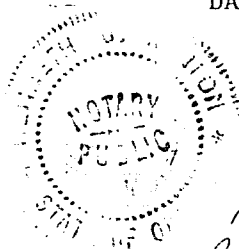

12
8 AM 8 57
130 OCT '80

19497

PH 1 40
C-5209

C-1602

SW # 9314

2" PVC CONDUIT
UNDER RD72KV + 36L
1820' TO VAULTINSTALL 2" STEEL
CONDUIT UNDER
CREEK CROSSING

22 1/2' 1450'

195'

ROUND LAKE RD

PH 2 45
C-5210#1
C-5220

30" VAULT

1820
2180
300072KV + 36L
1820' TO VAULT

RW WEYERHAEUSER

RW KOOPMAN

18 17 WEYERHAEUSER
19 20 KOOPMAN151 33-8076
7200 - 120/240#2
C-5221

30' ROUND VAULT

2" PVC CONDUIT
UNDER RDPad
C-5222

EXHIBIT "A"

FOR DIVISION AUTHORIZATION

PACIFIC POWER & LIGHT COMPANY

E R SKETCH

SCALE 1" = 400'

FORM 2705-4/74

| | | | |
|-----------------------------------|--|----------|-------------------|
| DISTRICT <u>KLAMATH FALLS</u> | | | |
| NAME <u>JIM KOOPMAN</u> | | FILE NO. | <u>136-10260</u> |
| LOCATION <u>ROUND LK RD.</u> | | ER NO. | |
| MAP NO. <u>C-50-4</u> | | | <u>31-710-136</u> |
| DRAWN <u>LKT 6-6</u> 19 <u>79</u> | | W.O. | <u>11403</u> |

19498

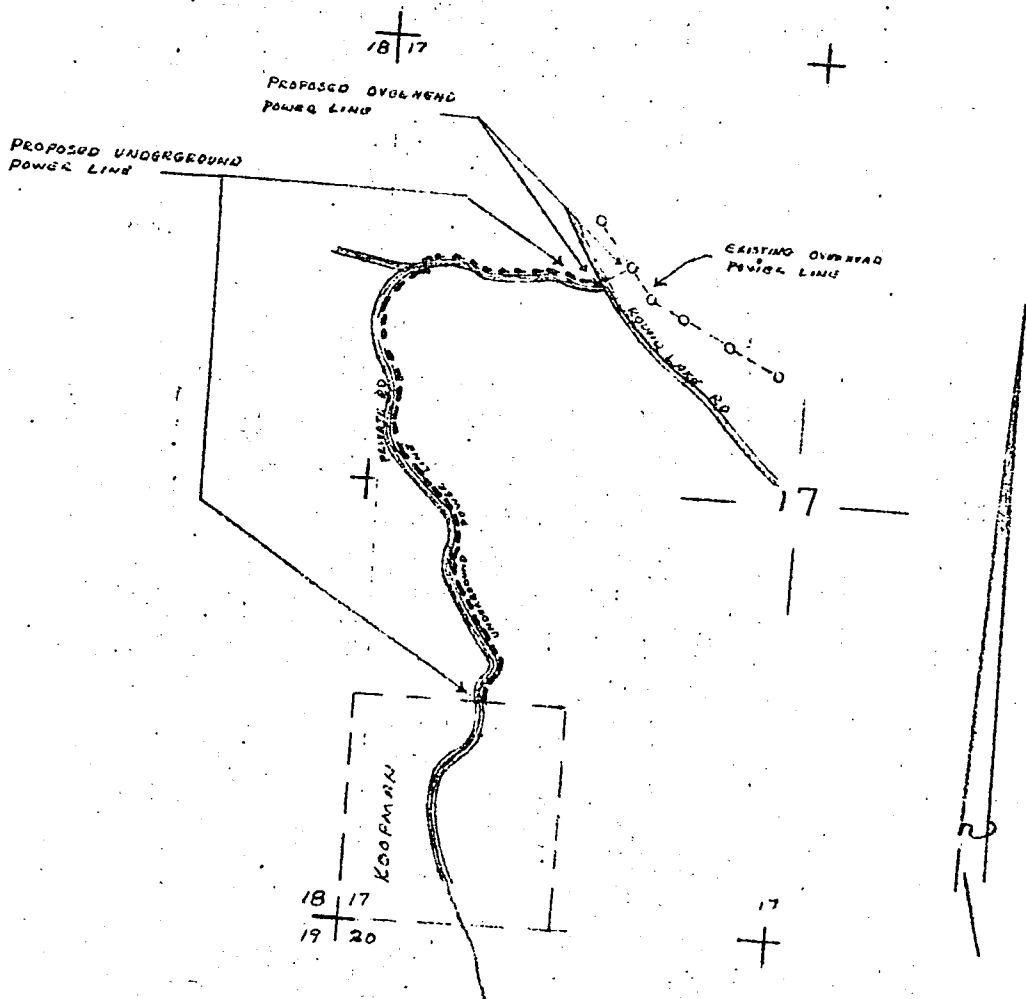

EXHIBIT "A"

SEC. 17, T. 39S, R. 8E, W.M.

| | |
|------------------|----------------|
| DISTRICT _____ | |
| NAME _____ | FILE NO. _____ |
| LOCATION _____ | E.R. NO. _____ |
| MAP NO. _____ | W.O. _____ |
| DRAWN _____ 19__ | |

PACIFIC POWER & LIGHT COMPANY
E R SKETCH

SCALE 1" = 1000'

FORM 2708-4/74

STATE OF OREGON; COUNTY OF KLAMATH; ss.

I hereby certify that the within instrument was received and filed for record on the 8th day of October A.D., 19 80 at 8:57 o'clock A M., and duly recorded in Vol. 180 of Deeds on Page 19496.

FEE \$10.50

WM. D. MILNE, County Clerk
By Bernetha Hetch Deputy