

96429

Vol. ¹⁷ 81 Page 3433

EASEMENT SUPPLEMENT

WHEREAS, by Easement dated January 29, 1976, herein referred to as "Original Easement," OREGON, CALIFORNIA AND EASTERN RAILWAY COMPANY, a Nevada corporation, Klamath Falls, Oregon, 97601, granted to HERMAN F. ROMTVEDT, 339 South Lewis, Monroe, Washington, a nonexclusive easement for a roadway located upon, over and across Grantor's railroad right of way in the S $\frac{1}{2}$ SE $\frac{1}{4}$ of Section 15, Township 39 South, Range 10 East, W.M., Klamath County, Oregon, said easement being located approximately as shown in yellow on the attached Exhibit A; and

WHEREAS, Grantee has requested and Grantor has agreed to supplement said original easement to include additional roadway,

NOW THEREFORE, it is mutually agreed by the parties hereto that the original easement be supplemented to include a nonexclusive easement for a private roadway twelve (12) feet in width upon, over and across Grantor's railroad right of way in the SW $\frac{1}{4}$ SE $\frac{1}{4}$ of Section 15, Township 39 South, Range 10 East, W.M., Klamath County, Oregon and located approximately as shown in red on the attached Exhibit A.

Grantee shall, at Grantee's sole expense, furnish, install and maintain a good and substantial gate on the northerly property line of Grantor, located as shown in green on the attached Exhibit A, to prevent all livestock from entering upon Grantor's railroad right of way.

Except as herein expressly provided, all of the terms and conditions of the Original Easement shall remain in full force and effect.

IN WITNESS WHEREOF, the parties hereto have executed this instrument, in duplicate, as of the day and year hereinabove first written.

OREGON, CALIFORNIA AND EASTERN
RAILWAY COMPANY

By
Its

Dave Guarnaccia

Herman F. Romtvedt
HERMAN F. ROMTVEDT

Bob Langley
Rt 2 Box 733
K. Falls.

*81 FEB 27 AM 11 14

STATE OF OREGON

3434

COUNTY OF Klamath } ss.

The foregoing instrument was acknowledged before me this 6th day of February, 1981 by Dave Guarnaccia of Oregon, California and Eastern Railway Company, a Nevada corporation, on behalf of the corporation.

Judy L. Bangs
Notary Public in and for the State
of Oregon.

My commission expires: 4/9/82.

STATE OF Washington }
COUNTY OF Snohomish } ss.

On this 23 day of Feb, 1981, before me personally appeared Herman F. Kontwiedt and to me known to be the individual described in, and who executed the above and foregoing instrument and acknowledged that he signed the same as his free and voluntary act and deed, for the uses and purposes therein mentioned.

IN WITNESS WHEREOF, I have hereunto set my hand and affixed my official seal the day and year first above written.

Quana L. Hearn
Notary Public in and for the State of
Wash residing at Sultan.

My commission expires: 8-1-82.

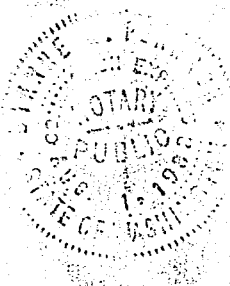

05/0612/3/s1
1/12/81

3435

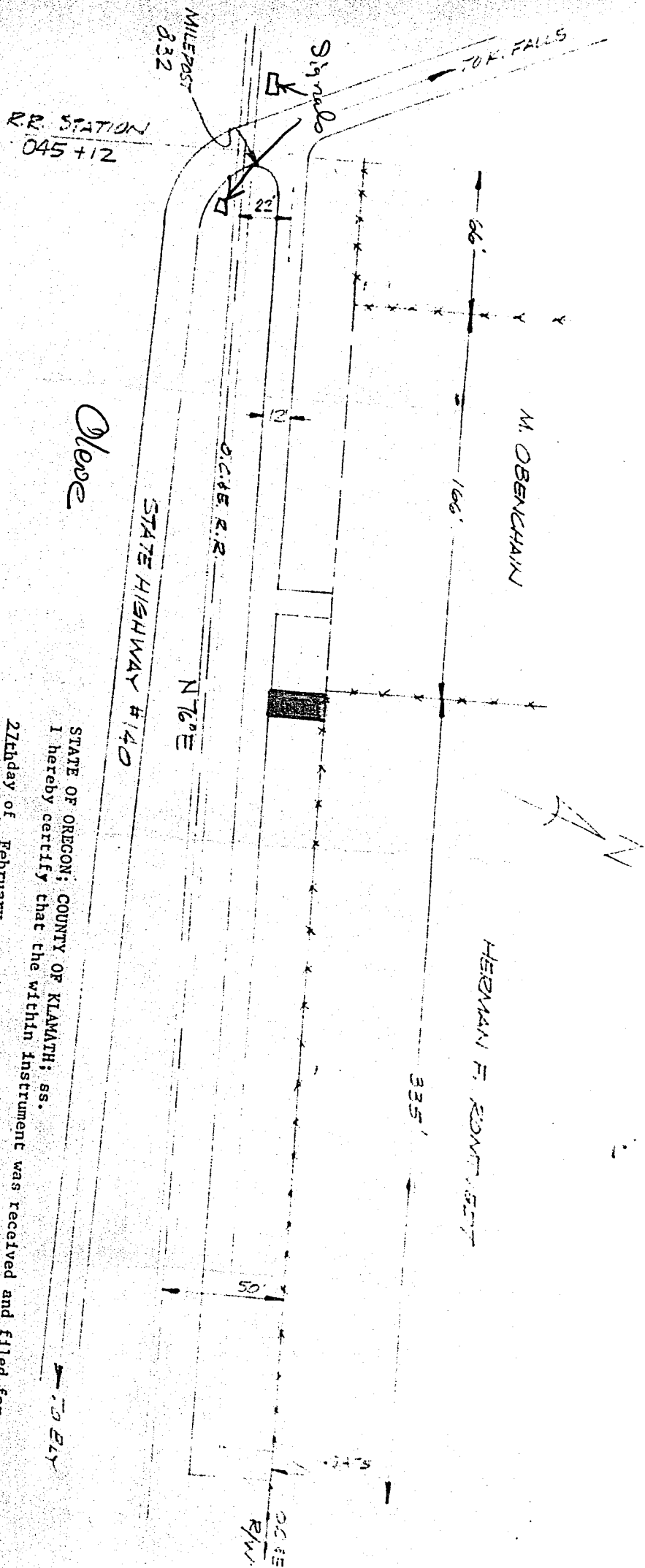

Cleave

STATE OF OREGON; COUNTY OF KLAMATH; ss.
I hereby certify that the within instrument was received and filed for record on the
27th day of February A.D., 1981 at 11:14 o'clock A M., and duly recorded in
Vol. 881, of Deeds on page 3433.
Fee \$ 10.50
EVELYN BIEHN
COUNTY CLERK

By *[Signature]*
Deputy

See. 15-395-10E, W.M.

EXHIBIT A