

17427

SUPPLEMENT NO. 3  
TO ROAD RIGHT-OF-WAY CONSTRUCTION  
AND USE AGREEMENT

Vol. 11 Page 15513

WHEREAS, DIAMOND INTERNATIONAL CORPORATION, hereinafter referred to as "Cooperator," and the UNITED STATES OF AMERICA, by and through the Acting Regional Forester, Forest Service, Department of Agriculture, hereinafter referred to as "Government," on the 18th day of March, 1975, entered into a Road Right-of-Way Construction and Use Agreement, hereinafter referred to as "Agreement," providing for construction and use of roads within the Deschutes Agreement Area within and adjacent to the Deschutes National Forest in Jefferson, Deschutes, Klamath, and Lake Counties, State of Oregon; and

WHEREAS, said Agreement provides that a Supplement thereto will be executed to cover any jointly financed roads, and

WHEREAS, the parties have now determined the road hereinafter described is to be a jointly financed road,

NOW, THEREFORE, in accordance with the provisions of said Agreement, the parties agree as follows:

1. Identification of Road

Roads added to the Agreement:

The roads to be jointly financed are as follows:  
Santiam Block

- a. Clinker Cutoff No. 1417B (1000650) (Segment S-1) Beginning at the junction with Road No. 1471 in the NW $\frac{1}{4}$ NW $\frac{1}{4}$  sec. 33, T. 14 S., R. 9 E., W.M., being approximately 0.35 miles in length and ending at the SE $\frac{1}{4}$ NE $\frac{1}{4}$  sec. 32, T. 14 S., R. 9 E., W.M., and is in the approximate location as shown as Segment S-1 on Exhibit 1.
- b. Sisters Mainline No. 1139 (1012500) (Segment S-2) Beginning at the SE $\frac{1}{4}$ SE $\frac{1}{4}$  sec. 25, T. 14 S., R. 9 E., W.M., being approximately 0.05 miles in length and ending at the NW $\frac{1}{4}$ NW $\frac{1}{4}$  sec. 31, T. 14 S., R. 10 E., W.M., and is in the approximate location as shown as Segment S-2 on Exhibit 1.
- c. Abbot Butte No. 1210 (1210000) (Segment S-3) Beginning at the SW $\frac{1}{4}$ SW $\frac{1}{4}$  sec. 18, T. 13 S., R. 9 E., W.M., being approximately 0.90 miles in length and ending at the SW $\frac{1}{4}$ SE $\frac{1}{4}$  sec. 12, T. 13 S., R. 8 E., W.M., and is in the approximate location as shown as Segment S-3 on Exhibit 1.
- d. Junction No. 1315A (2061000) (Segment S-4) Beginning at the SW $\frac{1}{4}$ NW $\frac{1}{4}$  sec. 4, T. 14 S., R. 9 E., W.M., being approximately 0.5 miles in length and ending at its junction with Road No. 1375 in the NW $\frac{1}{4}$ SE $\frac{1}{4}$  sec. 5, T. 14 S., R. 9 E., W.M., and is in the approximate location as shown as Segment S-4 on Exhibit 1.

82 NOV 22 PM/2 19

ck  
9200

- e. Road No. 1582F (1510600) (Segment S-5) Beginning at the junction with Road No. 1582 in the NE $\frac{1}{4}$ SW $\frac{1}{4}$  sec. 3, T. 15 S., R. 9 E., W.M., being approximately 0.5 miles in length and ending at the NW $\frac{1}{4}$ NW $\frac{1}{4}$  sec. 10, T. 15 S., R. 9 E., W.M., and is in the approximate location as shown as Segment S-5 on Exhibit 1.
- f. Road No. 1528F (1510600) (Segment S-7) Beginning at the NW $\frac{1}{4}$ NW $\frac{1}{4}$  sec. 10, T. 15 S., R. 9 E., W.M., being approximately 1.28 miles in length and ending at the NE $\frac{1}{4}$ SE $\frac{1}{4}$  sec. 8, T. 15 S., R. 10 E., W.M., and is in the approximate location as shown as Segment S-7 on Exhibit 1.
- g. Old Santiam No. 1315 (1012310) (Segment S-9) Beginning at the NW $\frac{1}{4}$ NW $\frac{1}{4}$  sec. 23, T. 14 S., R. 9 E., W.M., being approximately 0.01 miles in length and ending at the SE $\frac{1}{4}$ SE $\frac{1}{4}$  sec. 15, T. 14 S., R. 9 E., W.M., and is in the approximate location as shown as Segment S-9 on Exhibit 1.
- h. Cow Camp No. 1536A (1512000) (Segment S-10) Beginning at the SW $\frac{1}{4}$ SE $\frac{1}{4}$  sec. 10, T. 15 S., R. 9 E., W.M., being approximately 0.85 miles in length and ending at the NE $\frac{1}{4}$ NE $\frac{1}{4}$  sec. 16, T. 15 S., R. 9 E., W.M., and is in the approximate location as shown as Segment S-10 on Exhibit 1.
- i. Half Ration No. 1375 (2060000) (Segment S-11) Beginning at the NE $\frac{1}{4}$ NE $\frac{1}{4}$  sec. 17, T. 14 S., R. 9 E., W.M., being approximately 0.3 miles in length and ending at a point in the NE $\frac{1}{4}$ SE $\frac{1}{4}$  sec. 8, T. 14 S., R. 9 E., W.M., approximately 1,380 feet north and 400 feet west of the southeast section corner of sec. 8, T. 14 S., R. 9 E., W.M., and is in the approximate location as shown as Segment S-11 on Exhibit 1.
- j. Unnamed Spur (Half Ration No. 1375) (2060000) (Segment S-12) Beginning at the NW $\frac{1}{4}$ NW $\frac{1}{4}$  sec. 16, T. 14 S., R. 9 E., W.M., being approximately 0.35 miles in length and ending at the SE $\frac{1}{4}$ SE $\frac{1}{4}$  sec. 8, T. 14 S., R. 9 E., W.M. and is in the approximate location as shown as Segment S-12 on Exhibit 1.
- k. Half Ration No. 1375 (2060000 and 2060350) (Segment S-13) Beginning at a point in the SW $\frac{1}{4}$ NE $\frac{1}{4}$  sec. 16, T. 14 S., R. 9 E., W.M., approximately 2,503 feet N. 81° 31' W. of the east quarter corner of sec. 16, T. 14 S., R. 9 E., W.M., being approximately 0.8 miles in length and ending at the NE $\frac{1}{4}$ NE $\frac{1}{4}$  sec. 17, T. 14 S., R. 9 E., W.M., and is in the approximate location as shown as Segment S-13 on Exhibit 1.
- l. Half Ration No. 1375 (2060350) (Segment S-14) Beginning at the NW $\frac{1}{4}$ NE $\frac{1}{4}$  sec. 21, T. 14 S., R. 9 E., W.M., being approximately 0.8 miles in length and ending at a point in the SW $\frac{1}{4}$ NE $\frac{1}{4}$  sec. 16, T. 14 S., R. 9 E., W.M., approximately 2503 feet N. 81° 31' W. of the east quarter corner of sec. 16, T. 14 S., R. 9 E., W.M., and is in the approximate location as shown as Segment S-14 on Exhibit 1.

- m. Half Ration No. 1375 (1012300) (Segment S-15) Beginning at the SW $\frac{1}{4}$ SE $\frac{1}{4}$  sec. 16, T. 14 S., R. 9 E., W.M., being approximately 0.85 miles in length and ending at the NW $\frac{1}{4}$ SW $\frac{1}{4}$  sec. 22, T. 14 S., R. 9 E., W.M., and is in the approximate location as shown as Segment S-15 on Exhibit 1. The following portion of this segment was terminated with a document dated February 4, 1980. Beginning at the SW $\frac{1}{4}$ SE $\frac{1}{4}$  sec. 16, T. 14 S., R. 9 E., W.M., being approximately 0.81 miles in length and ending at its junction with Road No. 1375J in the NE $\frac{1}{4}$ SE $\frac{1}{4}$  sec. 21, T. 14 S., R. 9 E., W.M.
- n. Half Ration No. 1375 (1012300) (Segment S-17) Beginning at the NE $\frac{1}{4}$ SE $\frac{1}{4}$  sec. 22, T. 14 S., R. 9 E., W.M., being approximately 0.73 miles in length and ending at the junction with Road No. 1315 in the NW $\frac{1}{4}$ SE $\frac{1}{4}$  sec. 23, T. 14 S., R. 9 E., W.M., and is in the approximate location as shown as Segment S-17 on Exhibit 1.
- o. Road No. 1375G (1012310) (Segment S-18) Beginning at a point on Road No. 1315 in the NW $\frac{1}{4}$ SE $\frac{1}{4}$  sec. 23, T. 14 S., R. 9 E., W.M., being approximately 0.1 miles in length and ending at Road No. 1375 in the NW $\frac{1}{4}$ SE $\frac{1}{4}$  sec. 23, T. 14 S., R. 9 E., W.M., and is in the approximate location as shown as Segment S-18 on Exhibit 1.
- p. Guzzler No. 1447 (1012200) (Segment S-19) Beginning at the NW $\frac{1}{4}$ NE $\frac{1}{4}$  sec. 26, T. 14 S., R. 9 E. W.M., being approximately 0.4 miles in length and ending at the junction with Road No. 1315 in the SE $\frac{1}{4}$ SE $\frac{1}{4}$  sec. 23, T. 14 S., R. 9 E., W.M., and is in the approximate location as shown as Segment S-19 on Exhibit 1.
- q. Road No. 1444 (2060000) (Segment S-20) Beginning at the NE $\frac{1}{4}$ SE $\frac{1}{4}$  sec. 17, T. 14 S., R. 9 E., W.M., being approximately 0.3 miles in length and ending at the junction with Road No. 1375 in the SW $\frac{1}{4}$ NW $\frac{1}{4}$  sec. 16, T. 14 S., R. 9 E., W.M., and is in the approximate location as shown as Segment S-20 on Exhibit 1.
- r. Road No. 1444 (2060000) (Segment S-21) Beginning at the NW $\frac{1}{4}$ SW $\frac{1}{4}$  sec. 16, T. 14 S., R. 9 E., W.M., being approximately 1.0 miles in length and ending at the junction with Road No. 1471A in the SW $\frac{1}{4}$ SW $\frac{1}{4}$  sec. 17, T. 14 S., R. 9 E., W.M., and is in the approximate location as shown as Segment S-21 on Exhibit 1.
- s. Road No. 1445 (Now Old Santiam 1315) (1012330) (Segment S-22) Beginning at the junction with Road No. 1375 in the NW $\frac{1}{4}$ SW $\frac{1}{4}$  sec. 23, T. 14 S., R. 9 E., W.M., being approximately 0.2 miles in length and ending at a point approximately 660 feet north of the west quarter corner of sec. 23, T. 14 S., R. 9 E., W.M., and is in the approximate location as shown as Segment S-22 on Exhibit 1.

- t. Road No. 1446C (1014120) (Segment S-23) Beginning at the NW $\frac{1}{4}$ NW $\frac{1}{4}$  sec. 28, T. 14 S., R. 9 E., W.M., being approximately 0.05 miles in length and ending at the SE $\frac{1}{4}$ SE $\frac{1}{4}$  sec. 20, T. 14 S., R. 9 E., W.M., and is in the approximate location as shown as Segment S-23 on Exhibit 1.
- u. Road No. 1375C (2061110) (Segment S-47) Beginning at the junction with Road No. 1375 in Lot 4 sec. 5, T. 14 S., R. 9 E., W.M., being approximately 0.20 miles in length and ending at the SE $\frac{1}{4}$ NE $\frac{1}{4}$  sec. 6, T. 14 S., R. 9 E., W.M. and is in the approximate location as shown as Segment S-47 on Exhibit 1.
- v. Road No. 1014000 (Segment S-48) Beginning at the junction with Road No. 1028000 in the SE $\frac{1}{4}$ SE $\frac{1}{4}$  sec. 14, T. 14 S., R. 8 E., W.M., being approximately 0.02 miles in length and ending at the SW $\frac{1}{4}$ SW $\frac{1}{4}$  sec. 13, T. 14 S., R. 8 E., W.M. and is in the approximate location as shown as Segment S-48 on Exhibit 1.
- w. Half Ration No. 1375 (1012300) (Segment S-16) Beginning at the NW $\frac{1}{4}$ SW $\frac{1}{4}$  sec. 23, T. 14 S., R. 9 E., W.M., being approximately 1.2 miles in length and ending at the NE $\frac{1}{4}$ SE $\frac{1}{4}$  sec. 21, T. 14 S., R. 9 E., W.M., and is in the approximate location as shown as Segment S-16 on Exhibit 1.
- x. Road No. 1492 (1028260) (Segment S-24) Beginning at the junction with Road No. 1444 in the SW $\frac{1}{4}$ SW $\frac{1}{4}$  sec. 17, T. 14 S., R. 9 E., W.M., being approximately 1.2 miles in length and ending at the NE $\frac{1}{4}$ NE $\frac{1}{4}$  sec. 24, T. 14 S., R. 8 E., W.M., and is in the approximate location as shown as Segment S-24 on Exhibit 1.
- y. Spur No. 1028220 (Segment S-26) Beginning at the junction with Road No. 1492 (1028260) in the SE $\frac{1}{4}$ SW $\frac{1}{4}$  sec. 18, T. 14 S., R. 9 E., W.M., being approximately 0.05 miles in length and ending at the NE $\frac{1}{4}$ NW $\frac{1}{4}$  sec. 19, T. 14 S., R. 9 E., W.M., and is in the approximate location as shown as Segment S-26 on Exhibit 1.
- z. 1315A Spur (2061270) (Segment S-27) Beginning at the junction with Road No. 1315A in the NW $\frac{1}{4}$ NW $\frac{1}{4}$  sec. 8, T. 14 S., R. 9 E., W.M., being approximately 0.5 miles in length and ending at the NW $\frac{1}{4}$ SW $\frac{1}{4}$  sec. 8, T. 14 S., R. 9 E., W.M., and is in the approximate location as shown as Segment S-27 on Exhibit 1.
- aa. Spur (1028910 and 1028900) (Segment S-28) Beginning at the junction with Road No. 1028900 in the N $\frac{1}{2}$ SW $\frac{1}{4}$  sec. 34, T. 13 S., R. 8 E., W.M., being approximately 0.5 miles in length and ending at the SE $\frac{1}{4}$ NE $\frac{1}{4}$  sec. 33, T. 13 S., R. 8 E., W.M., and is in the approximate location as shown as Segment S-28 on Exhibit 1.

- bb. Road No. 1018800 (Segment S-29) Beginning at the junction with Road 1040000 in the  $N\frac{1}{2}SW\frac{1}{4}$  sec. 8, T. 15 S., R. 9 E., W.M., being approximately 0.8 miles in length and ending at a point on Road 1018800 approximately 260 feet west and 130 feet north of the southeast corner of sec. 7, T. 15 S., R. 9 E., W.M., and is in the approximate location as shown as Segment S-29 on Exhibit 1.
- cc. Road No. 1528F (1510600) (Segment S-6) Beginning at the  $SW\frac{1}{4}SW\frac{1}{4}$  sec. 3, T. 15 S., R. 9 E., W.M., being approximately 0.1 miles in length and ending at the  $NE\frac{1}{4}NE\frac{1}{4}$  sec. 9, T. 15 S., R. 9 E., W.M., and is in the approximate location as shown as Segment S-6 on Exhibit 1.

#### Squawback Block

- a. Six Creek No. 1228 (1100800) (Segment SQ-1) Beginning at the  $SW\frac{1}{4}NE\frac{1}{4}$  sec. 15, T. 12 S., R. 10 E., W.M., being approximately 0.26 miles in length and ending at the  $NE\frac{1}{4}NW\frac{1}{4}$  sec. 15, T. 12 S., R. 10 E., W.M., and is in the approximate location as shown as Segment SQ-1 on Exhibit 1.
- b. Green Ridge No. 1137 (1130000) (Segment SQ-2) Beginning at the junction with Road No. 1139 in the  $NE\frac{1}{4}SW\frac{1}{4}$  sec. 19, T. 13 S., R. 10 E., W.M., being approximately 0.50 miles in length and ending at the  $SE\frac{1}{4}NE\frac{1}{4}$  sec. 24, T. 13 S., R. 9 E., W.M., and is in the approximate location as shown as Segment SQ-2 on Exhibit 1.
- c. Squawback Ridge No. 1139 (1100000) (Segment SQ-3) Beginning at the  $NW\frac{1}{4}SE\frac{1}{4}$  sec. 25, T. 13 S., R. 9 E., W.M., being approximately 0.22 miles in length and ending at a point on Road No. 1139 in the  $SW\frac{1}{4}NE\frac{1}{4}$  sec. 25, T. 13 S., R. 9 E., W.M., and is in the approximate location as shown as Segment SQ-3 on Exhibit 1.
- d. Section 7 Spur (1130540 and 1100280) (Segment SQ-4) Beginning at the  $SW\frac{1}{4}SW\frac{1}{4}$  sec. 8, T. 13 S., R. 10 E., W.M., being approximately 0.25 miles in length and ending at the  $NW\frac{1}{4}SW\frac{1}{4}$  sec. 8, T. 13 S., R. 10 E., W.M., and is in the approximate location as shown as Segment SQ-4 on Exhibit 1.
- e. Spur No. 2 (2050400) (Segment SQ-5) Beginning at the  $SE\frac{1}{4}SE\frac{1}{4}$  sec. 33, T. 13 S., R. 10 E., W.M., being approximately 0.1 miles in length and ending at the  $NW\frac{1}{4}NW\frac{1}{4}$  sec. 3, T. 14 S., R. 10 E., W.M., and is in the approximate location as shown as Segment SQ-5 on Exhibit 1.

#### Bull Springs Block

- a. Sisters Mainline No. 1139 (4606000) (Segment BS-1) Beginning at the  $SW\frac{1}{4}SW\frac{1}{4}$  sec. 34, T. 17 S., R. 11 E., W.M., being approximately 1.60 miles in length and ending at the  $NW\frac{1}{4}SW\frac{1}{4}$  sec. 2, T. 18 S., R. 11 E., W.M., and is in the approximate location as shown as Segment BS-1 on Exhibit 1.

- b. Three Creeks No. 1534 (1600000) (Segment BS-2) Beginning at Lot 4 sec. 6, T. 16 S., R. 10 E., W.M., being approximately 0.3 miles in length and ending at the NE $\frac{1}{4}$ SE $\frac{1}{4}$  sec. 1, T. 15 S., R. 9 E., W.M., and is in the approximate location as shown as Segment BS-2 on Exhibit 1.
- c. Bear Wallow No. 1750 (4601000) (Segment BS-3) Beginning at the junction with Skyliners Road No. 4601000 in the SE $\frac{1}{4}$ NE $\frac{1}{4}$  sec. 10, T. 18 S., R. 10 E., W.M., being approximately 4.30 miles in length and ending at the SW $\frac{1}{4}$ SW $\frac{1}{4}$  sec. 34, T. 18 S., R. 10 E., W.M., and is in the approximate location as shown as Segment BS-3 on Exhibit 1.
- d. Spur A (4606400) (Segment BS-5) Beginning at the junction with Road No. 1139 in the SE $\frac{1}{4}$ NE $\frac{1}{4}$  sec. 6, T. 17 S., R. 11 E., W.M., being approximately 1.45 miles in length and ending at the junction with the 600 line in the SE $\frac{1}{4}$ NE $\frac{1}{4}$  sec. 12, T. 17 S., R. 10 E., W.M., and is in the approximate location as shown as Segment BS-5 on Exhibit 1.
- e. 600 Line (4607000) (Segment BS-6) Beginning at the junction with Road 1139 in the NW $\frac{1}{4}$ NE $\frac{1}{4}$  sec. 8, T. 17 S., R. 11 E., W.M., being approximately 1.85 miles in length and ending at the junction with the A Spur in SE $\frac{1}{4}$ NE $\frac{1}{4}$  sec. 12, T. 17 S., R. 10 E., W.M., and is in the approximate location as shown as Segment BS-6 on Exhibit 1.
- f. Spur C (4607100) (Segment BS-7) Beginning at the junction with the 600 line in the NW $\frac{1}{4}$ NE $\frac{1}{4}$  sec. 8, T. 17 S., R. 11 E., W.M., being approximately 1.0 miles in length and ending at the NE $\frac{1}{4}$ NE $\frac{1}{4}$  sec. 18, T. 17 S., R. 11 E., W.M., and is in the approximate location as shown as Segment BS-7 on Exhibit 1.
- g. Spur D (4606280) (Segment BS-8) Beginning at the junction with Road No. 1139 in the NW $\frac{1}{4}$ SW $\frac{1}{4}$  sec. 16, T. 17 S., R. 11 E., W.M., being approximately 1.4 miles in length and ending at the junction with E Spur in the NW $\frac{1}{4}$ NW $\frac{1}{4}$  sec. 20, T. 17 S., R. 11 E., W.M., and is in the approximate location as shown as Segment BS-8 on Exhibit 1.
- h. Spur E (4607100) (Segment BS-9) Beginning at the junction with Spur D in the NW $\frac{1}{4}$ NW $\frac{1}{4}$  sec. 20, T. 17 S., R. 10 E., W.M., being approximately 0.25 miles in length and ending at the SW $\frac{1}{4}$ SW $\frac{1}{4}$  sec. 17, T. 17 S., R. 11 E., W.M., and is in the approximate location as shown as Segment BS-9 on Exhibit 1.
- i. Spur F (4606230) (Segment BS-10) Beginning at the junction with Road No. 1139 in the NW $\frac{1}{4}$ NW $\frac{1}{4}$  sec. 22 T. 17 S., R. 11 E., W.M., being approximately 0.1 miles in length and ending at the NE $\frac{1}{4}$ NE $\frac{1}{4}$  sec. 21, T. 17 S., R. 11 E., W.M. and is in the approximate location as shown as Segment BS-10 on Exhibit 1.



15519

- j. Spur G (4606200) (Segment BS-11) Beginning at the junction with Road No. 1139 in the SW $\frac{1}{4}$ NW $\frac{1}{4}$  sec. 22, T. 17 S., R. 11 E., W.M., being approximately 0.35 miles in length and ending at the NE $\frac{1}{4}$ SE $\frac{1}{4}$  sec. 21, T. 17 S., R. 11 E., W.M., and is in the approximate location as shown as Segment BS-11 on Exhibit 1.
- k. Spur H (4605050) (Segment BS-12) Beginning at the junction with the 700 line in the SE $\frac{1}{4}$ NW $\frac{1}{4}$  sec. 28, T. 17 S., R. 11 E., W.M., being approximately 0.4 miles in length and ending at the SE $\frac{1}{4}$ SW $\frac{1}{4}$  sec. 21, T. 17 S., R. 11 E., W.M., and is in the approximate location as shown as Segment BS-12 on Exhibit 1.
- l. 700 Line (4605000) (Segment BS-13) Beginning at the junction with Road No. 1139 in the NE $\frac{1}{4}$ SW $\frac{1}{4}$  sec. 27, T. 17 S., R. 11 E., W.M., being approximately 2.2 miles in length and ending at the SE $\frac{1}{4}$ SE $\frac{1}{4}$  sec. 20, T. 17 S., R. 11 E., W.M., and is in the approximate location as shown as Segment BS-13 on Exhibit 1.
- m. Columbia Southern Spur (Segment BS-14) Beginning at the SW $\frac{1}{4}$ NW $\frac{1}{4}$  sec. 1, T. 18 S., R. 10 E., W.M., being approximately 0.35 miles in length and ending at the NW $\frac{1}{4}$ SE $\frac{1}{4}$  sec. 2, T. 18 S., R. 10 E., W.M., and is in the approximate location as shown as Segment BS-14 on Exhibit 1.
- n. Tumalo Lake Spur (4601430) (Segment BS-15) Beginning at the junction with the county road in the SE $\frac{1}{4}$ NW $\frac{1}{4}$  sec. 10, T. 18 S., R. 10 E., W.M., being approximately 0.95 miles in length and ending at the SW $\frac{1}{4}$ SE $\frac{1}{4}$  sec. 9, T. 18 S., R. 10 E., W.M., and is in the approximate location as shown as Segment BS-15 on Exhibit 1.
- o. Spur B (4607300) (Segment BS-16) Beginning at the SW $\frac{1}{4}$ SE $\frac{1}{4}$  sec. 7, T. 17 S., R. 11 E., W.M., being approximately 0.1 miles in length and ending at the NE $\frac{1}{4}$ NW $\frac{1}{4}$  sec. 18, T. 17 S., R. 11 E., W.M., and is in the approximate location as shown as Segment BS-16 on Exhibit 1.
- p. Tumalo Creek Spur (4606060) (Segment BS-17) Beginning at the junction with Road No. 1139 in the SE $\frac{1}{4}$ NE $\frac{1}{4}$  sec. 4, T. 18 S., R. 11 E., W.M., being approximately 0.4 miles in length and ending at the SE $\frac{1}{4}$ NW $\frac{1}{4}$  sec. 4, T. 18 S., R. 11 E., W.M., and is in the approximate location as shown as Segment BS-17 on Exhibit 1.
- q. Tumalo Creek Spur (4607060) (Segment BS-18) Beginning at the SE $\frac{1}{4}$ NE $\frac{1}{4}$  sec. 5, T. 18 S., R. 11 E., W.M., being approximately 0.2 miles in length and ending at the NW $\frac{1}{4}$ SE $\frac{1}{4}$  sec. 5, T. 18 S., R. 11 E., W.M., and is in the approximate location as shown as Segment BS-18 on Exhibit 1.

Spring Butte Block

- a. Road No. 233 (2430000) (Segment SB-1) Beginning at the junction with Highway 31 in Lot 9 sec. 6, T. 24 S., R. 11 E., W.M., being approximately 1.25 miles in length and ending at the junction with Road 2217 (2210200) in the SW $\frac{1}{4}$ NW $\frac{1}{4}$  sec. 5, T. 24 S., R. 11 E., W.M., and is in the approximate location as shown as Segment SB-1 on Exhibit 1.
- b. Road No. 2217 (2220900) (Segment SB-2) Beginning at the junction with Road 2210 in the SW $\frac{1}{4}$ SW $\frac{1}{4}$  sec. 17, T. 24 S., R. 11 E., W.M., being approximately 0.15 miles in length and ending at the NE $\frac{1}{4}$ SE $\frac{1}{4}$  sec. 18, T. 24 S., R. 11 E., W.M., and is in the location as shown as Segment SB-2 on Exhibit 1.
- c. Road No. 2217 (2210300) (Segment SB-3) Beginning at the NE $\frac{1}{4}$ SE $\frac{1}{4}$  sec. 18, T. 24 S., R. 11 E., W.M., being approximately 2.3 miles in length and ending at the junction with Road 233 (2430000) in the SW $\frac{1}{4}$ NW $\frac{1}{4}$  sec. 5, T. 24 S., R. 11 E., W.M., and is in the approximate location as shown as Segment SB-3 on Exhibit 1.
- d. Road No. 2210 (2220000) (Segment SB-4) Beginning at the junction with Highway 31 in the SW $\frac{1}{4}$ SW $\frac{1}{4}$  sec. 17, T. 24 S., R. 11 E., W.M., being approximately 4.25 miles in length and ending at the NW $\frac{1}{4}$ SW $\frac{1}{4}$  sec. 12, T. 24 S., R. 11 E., W.M., and is in the approximate location as shown as Segment SB-4 on Exhibit 1.
- e. Road No. (2220945) (Segment SB-5) Beginning at the junction with Road 2217 (2220900) in the NW $\frac{1}{4}$ SW $\frac{1}{4}$  sec. 8, T. 24 S., R. 11 E., W.M., being approximately 0.1 mile in length and ending at the NE $\frac{1}{4}$ SE $\frac{1}{4}$  sec. 7, T. 24 S., R. 11 E., W.M., and is in the approximate location as shown as Segment SB-5 on Exhibit 1.
- f. Road No. 2210 (2220000) (Segment SB-6) Beginning at the NE $\frac{1}{4}$ NE $\frac{1}{4}$  sec. 1, T. 24 S., R. 11 E., W.M., being approximately 0.1 miles in length and ending at the SW $\frac{1}{4}$ SW $\frac{1}{4}$  sec. 31, T. 23 S., R. 12 E., W.M., and is in the approximate location as shown as Segment SB-6 on Exhibit 1.
- g. Road No. 2210B (2430830) Segment SB-7) Beginning at the junction with Road 233 (2430000) in the NE $\frac{1}{4}$ SE $\frac{1}{4}$  sec. 36, T. 23 S., R. 11 E., W.M., being approximately 0.45 miles in length and ending at the NW $\frac{1}{4}$ NE $\frac{1}{4}$  sec. 1, T. 24 S., R. 11 E., W.M., and is in the approximate location as shown as Segment SB-7 on Exhibit 1.
- h. Road No. 233 (2430000) (SB-8) Beginning at the W $\frac{1}{4}$ SW $\frac{1}{4}$  sec. 31, T. 23 S., R. 12 E., W.M., being approximately 0.05 miles in length and ending at the junction with Road No. 2210B (2430830) in the NE $\frac{1}{4}$ SE $\frac{1}{4}$  sec. 36, T. 23 S., R. 11 E., W.M., and is in the approximate location as shown as Segment SB-8 on Exhibit 1.



- i. Road No. 2218 (3117450) (SB-9) Beginning at the junction with Road 2210 (2220000) in the NE $\frac{1}{4}$ NE $\frac{1}{4}$  sec. 15, T. 24 S., R. 11 E., W.M., being approximately 0.70 miles in length and ending at the junction with Road No. 3117000 in the SE $\frac{1}{4}$ SE $\frac{1}{4}$  sec. 15, T. 24 S., R. 11 E., W.M., and is in the approximate location as shown as Segment SB-9 on Exhibit 1.
- j. Road No. 3117400 (Segment SB-10) Beginning at the junction with Road 3117000 in the SE $\frac{1}{4}$ SE $\frac{1}{4}$  sec. 15, T. 24 S., R. 11 E., W.M., being approximately 0.3 miles in length and ending at the SW $\frac{1}{4}$ SW $\frac{1}{4}$  sec. 14, T. 24 S., R. 11 E., W.M., and is shown as Segment SB-10 on Exhibit 1.
- k. Road No. 3117453 (Segment SB-11) Beginning at the junction with Road 3117450 in the NE $\frac{1}{4}$ SE $\frac{1}{4}$  sec. 15, T. 24 S., R. 11 E., W.M., being approximately 0.05 miles in length and ending at the NW $\frac{1}{4}$ SW $\frac{1}{4}$  sec. 14, T. 24 S., R. 11 E., W.M., and is in the approximate location as shown as Segment SB-11 on Exhibit 1.
- l. Road No. 3117455 (Segment SB-12) Beginning at the junction with Road 3117450 in the SE $\frac{1}{4}$ NE $\frac{1}{4}$  sec. 15, T. 24 S., R. 11 E., W.M., being approximately 0.10 miles in length and ending at the SW $\frac{1}{4}$ NW $\frac{1}{4}$  sec. 14, T. 24 S., R. 11 E., W.M., and is in the approximate location as shown as Segment SB-12 on Exhibit 1.

Roads removed from the Agreement:

Santiam Block

- a. Old Santiam No. 1315 (2060300) (Segment S-30) Beginning at the SE $\frac{1}{4}$ SE $\frac{1}{4}$  sec. 8, T. 14 S., R. 9 E., W.M., being approximately 0.59 miles in length and ending at the NE $\frac{1}{4}$ NW $\frac{1}{4}$  sec. 16, T. 14 S., R. 9 E., W.M., and is in the approximate location as shown as Segment S-30 on Exhibit 1.
- b. Old Santiam No. 1315 (2000200) (Segment S-31) Beginning at the SE $\frac{1}{4}$ NE $\frac{1}{4}$  sec. 36, T. 14 S., R. 9 E., W.M., being approximately 1.23 miles in length and ending at the SW $\frac{1}{4}$ SW $\frac{1}{4}$  sec. 32, T. 14 S., R. 10 E., W.M., and is in the approximate location as shown as Segment S-31 on Exhibit 1.
- c. Old Santiam No. 1315 (2000200) (Segment S-32) Beginning at the SW $\frac{1}{4}$ SW $\frac{1}{4}$  sec. 32, T. 14 S., R. 10 E., W.M., being approximately 0.18 miles in length and ending at a point in sec. 5, T. 15 S., R. 10 E., W.M., approximately 660 feet south and 660 feet east of the northeast corner of sec. 5, T. 15 S., R. 10 E., W.M., and is in the approximate location as shown as Segment S-32 on Exhibit 1.
- d. Road No. 1582 (1500035) (Segment S-33) Beginning at the NE $\frac{1}{4}$ SE $\frac{1}{4}$  sec. 2, T. 15 S., R. 9 E., W.M., being approximately 1.03 miles in length and ending at the SW $\frac{1}{4}$ SW $\frac{1}{4}$  sec. 6, T. 15 S., R. 10 E., W.M., and is in the approximate location as shown as Segment S-33 on Exhibit 1.

15522

- e. Old Santiam No. 1315 (1012310) Segment S-34 Beginning at a point in sec. 16, T. 14 S., R. 9 E., W.M., approximately 1,320 feet west and 150 feet north of the east quarter corner of sec. 16, being approximately 0.83 miles in length and ending at the  $\frac{1}{2}$ SE $\frac{1}{4}$  sec. 15, T. 14 S., R. 9 E., W.M., and is in the approximate location as shown as Segment S-34 on Exhibit 1.
- f. Old Railroad Grade (Segment S-35) Beginning at the SW $\frac{1}{4}$ NW $\frac{1}{4}$  sec. 22, T. 14 S., R. 9 E., W.M., being approximately 0.35 miles in length and ending at the junction with Road 1375 in the SW $\frac{1}{4}$ NE $\frac{1}{4}$  sec. 21, T. 14 S., R. 9 E., W.M., and is in the approximate location as shown as Segment S-35 on Exhibit 1.
- g. Road No. 1315A (2060000) (Segment S-36) Beginning at the SW $\frac{1}{4}$ NW $\frac{1}{4}$  sec. 4, T. 14 S., R. 9 E., W.M., being approximately 0.34 miles in length and ending at a point in the SE $\frac{1}{4}$ NE $\frac{1}{4}$  sec. 5, T. 14 S., R. 9 E., W.M., approximately 2,180 feet south and 448 feet west of the northeast corner of sec. 5, T. 14 S., R. 9 E., W.M., and is in the approximate location as shown as Segment S-36 on Exhibit 1.
- h. Half Ration No. 1375 (2060000) (Segment S-37) Beginning at the NE $\frac{1}{4}$ NE $\frac{1}{4}$  sec. 8, T. 14 S., R. 9 E., W.M., being approximately 0.05 miles in length and ending at a point in the SE $\frac{1}{4}$ SE $\frac{1}{4}$  sec. 5, T. 14 S., R. 9 E., W.M., approximately 712 feet west and 328 feet north of the southeast corner of sec. 5, T. 14 S., R. 9 E., W.M., and in the approximate location as shown as Segment S-37 on Exhibit 1.
- i. Four-mile Spring No. 1445 (1012330) (Segment S-38) Beginning at a point on the west boundary of sec. 23, T. 14 S., R. 9 E., W.M., approximately 528 feet north of the west quarter corner, being approximately 0.25 miles in length and ending at a point on the west boundary of sec. 23, T. 14 S., R. 9 E., W.M., approximately 160 feet south of the west quarter corner and in the approximate location as shown as Segment S-38 on Exhibit 1.
- j. Old Railroad Grade (1012380) (Segment S-39) Beginning at a point in the SW $\frac{1}{4}$ NE $\frac{1}{4}$  sec. 21, T. 14 S., R. 9 E., W.M., where it joins an easement dated April 14, 1977, recorded in Vol. 249, page 11, being approximately 0.6 miles in length and ending at a point on the west boundary of sec. 21, T. 14 S., R. 9 E., W.M., approximately 160 feet north of the west quarter corner of sec. 21, and is in the approximate location as shown as Segment S-39 on Exhibit 1.
- k. Half Ration No. 1375 (1012300) (Segment S-40) Beginning at the junction with Road No. 1445 (currently No. 1375J) in the NE $\frac{1}{4}$ SE $\frac{1}{4}$  sec. 21, T. 14 S., R. 9 E., W.M., being approximately 0.8 miles in length and ending at the SW $\frac{1}{4}$ SE $\frac{1}{4}$  sec. 16, T. 14 S., R. 9 E., W.M., and is in the approximate location as shown as Segment S-40 on Exhibit 1.

15523

1. Road No. 1445 (1012300) (Segment S-41) Beginning at the junction with Road No. 1375 in the SW $\frac{1}{4}$ NE $\frac{1}{4}$  sec. 21, T. 14 S., R. 9 E., W.M., being approximately 0.01 miles in length and ending at a point in the SW $\frac{1}{4}$ NE $\frac{1}{4}$  sec. 21, T. 14 S., R. 9 E., W.M., where it joins an easement dated October 2, 1963 and recorded in Vol. 137, page 143, and is in the approximate location as shown as Segment S-41 on Exhibit 1.
- m. Old Santiam No. 1315 (1012310) (Segment S-42) Beginning at the junction with Road No. 1375 in the NW $\frac{1}{4}$ SE $\frac{1}{4}$  sec. 16, T. 14 S., R. 9 E., W.M., being approximately 0.2 miles in length and ending at the SE $\frac{1}{4}$ NE $\frac{1}{4}$  sec. 16, T. 14 S., R. 9 E., W.M., and is in the approximate location as shown as Segment S-42 on Exhibit 1.
- n. Old Santiam No. 1315 (1012310) (Segment S-43) Beginning at the W $\frac{1}{2}$ SW $\frac{1}{4}$  sec. 15, T. 14 S., R. 9 E., W.M., being approximately 0.53 miles in length and ending at the NE $\frac{1}{4}$ NE $\frac{1}{4}$  sec. 22, T. 14 S., R. 9 E., W.M., and is in the approximate location as shown as Segment S-43 on Exhibit 1.
- o. East Spur (Segment S-44) Beginning at a point on the west boundary of sec. 9, T. 15 S., R. 9 E., W.M., approximately 1,600 feet north of the southwest corner of sec. 9, being approximately 1.2 miles in length and ending at a point on the north boundary of sec. 9 approximately 630 feet west of the northeast corner of sec. 9, T. 14 S., R. 9 E., W.M. and is shown as Segment S-44 on Exhibit 1.
- p. East Spur (Segment S-45) Beginning at a point on the west boundary of sec. 3, T. 15 S., R. 9 E., W.M., approximately 530 feet north of the southwest corner of sec. 3, being approximately 0.36 miles in length and ending at the junction with parallel Road No. 1582 in the NE $\frac{1}{4}$ SW $\frac{1}{4}$  sec. 3, approximately 1,370 feet east and 1,900 feet north of the southwest corner of sec. 3, T. 15 S., R. 9 E., W.M., and is in the approximate location as shown as Segment S-45 on Exhibit 1.
- q. Half Ration No. 1375 (2060000) (Segment S-46) Beginning at the SE $\frac{1}{4}$ SE $\frac{1}{4}$  sec. 5, T. 14 S., R. 9 E., W.M. being approximately 0.5 miles in length and ending at a point in the NE $\frac{1}{4}$ SE $\frac{1}{4}$  sec. 8, T. 14 S., R. 9 E., W.M., approximately 120 feet south and 146 feet west of the east quarter corner of sec. 8, T. 14 S., R. 9 E., W.M., and is in the approximate location as shown as Segment S-46 on Exhibit 1.

#### Bull Springs Block

- a. Jack Pine Springs No. 1722 (Segment BS-19) Beginning at a point approximately 2,050 feet south and 2,510 feet west of the northeast corner of sec. 33, T. 17 S., R. 11 E., W.M., being approximately 6.5 miles in length and ending at a point approximately 1,320 feet east and 1,000 feet north of the southwest corner of sec. 34, T. 17 S., R. 10 E., W.M., and is in the approximate location as shown as Segment BS-19 on Exhibit 1.

15524

2. Plans and Specifications

There are no plans and specifications for the constructed roads.

3. Construction Program and Agreed Costs

a. Construction Program

All roads included in this supplement are existing. There will be no construction or reconstruction under this supplement.

b. Cost Estimates

Cost estimates are agreed upon by the parties as set forth in the papers filed with them in their respective offices.

4. Basis of Cost Sharing

The parties agree that the share of the cost of construction or reconstruction to be born by each party is set forth below:

Both parties have born their share of the cost of construction or reconstruction for each segment included in the supplement. There will be no further sharing of costs. There are no excess costs developed under this supplement.

The agreed upon costs shown below are to be used only for investment records.

Investment cost of road segments added

to the agreement

\$250,400

Investment cost of road segments deleted

from the agreement

\$ 45,750

Net increase in investment costs

\$204,650

5. Method of Payment

No excess costs have been developed under this supplement. No payments are to be made.

6. Continued Effectiveness of Agreement

Except as otherwise specifically agreed herein, all terms, provisions, and agreements of the aforesaid Agreement shall be and continue in full force and effect.

IN WITNESS WHEREOF, the parties hereto have caused this Third Supplement  
to be properly executed by their authorized representatives on this  
19<sup>th</sup> day of October, 1982.

15525

DIAMOND INTERNATIONAL CORPORATION

UNITED STATES OF AMERICA

BY *Greg Baule*  
Title *V.P.*

*for* *Robert M. Reeman*  
Jeff M. Sirmon  
Regional Forester  
Forest Service  
Department of Agriculture

# SUPPLEMENT NO. 3 AREA MAPS

EXHIBIT 1  
15526

SQUAWBACK BLOCK (SQ)	2 pages	segments 1--5
SANTIAM BLOCK (S)	3 pages	segments 1--7 9--24 & 26--48
BULL SPRINGS BLOCK (BS)	3 pages	segments 1--19
SPRING BUTTE BLOCK (SB)	1 page	segments 1--12

NATIONAL FOREST ---US

DIAMOND INTERNATIONAL CORP. ---D

THIRD PARTY ---P

segments added to the agreement

segments removed from the agreement



KRM 4/82



**SQUAWBACK BLOCK**

**PAGE 1 of 2**

**SEGMENT SQ-1**

15527

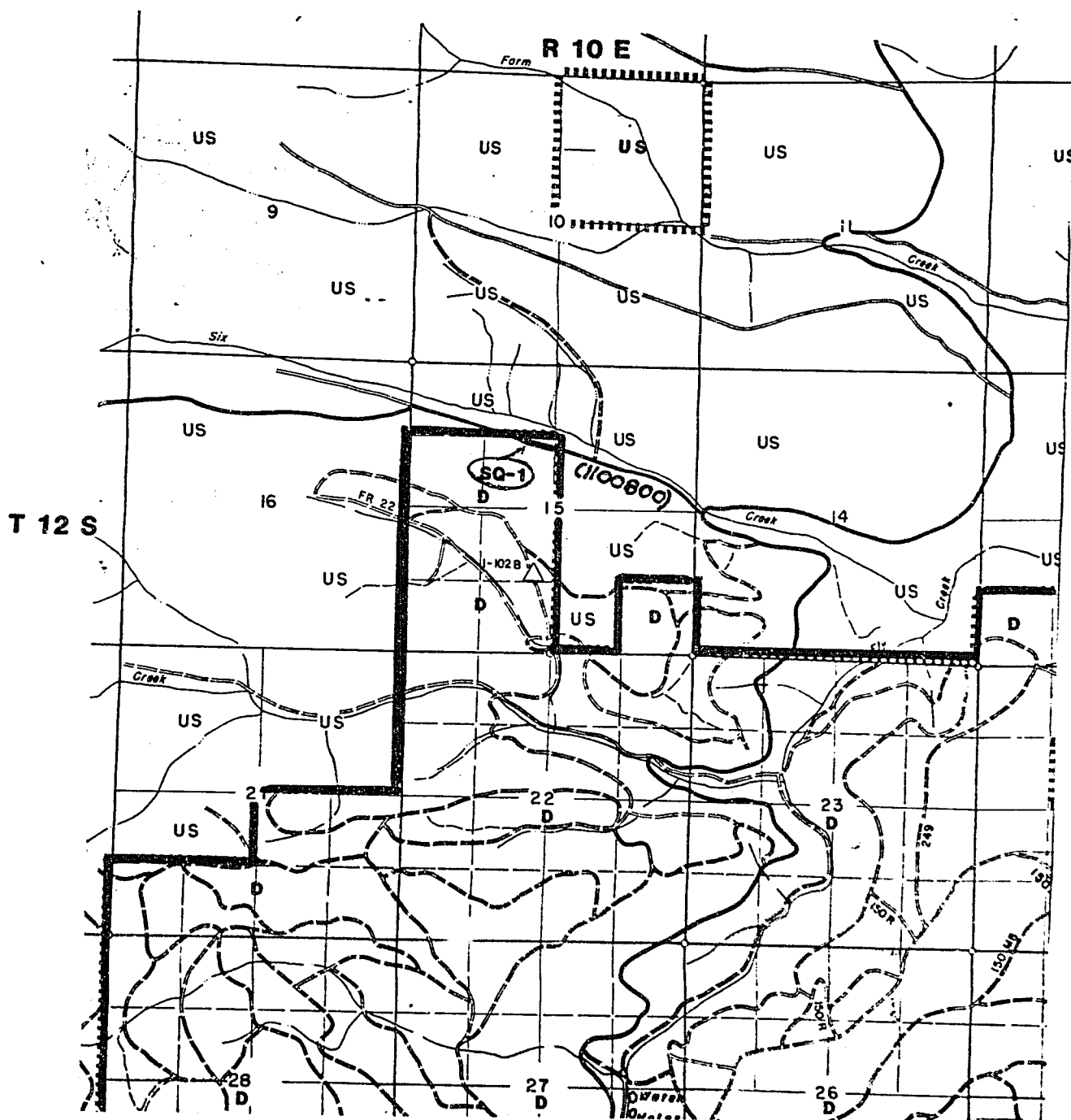

# SQUAWBACK BLOCK<sup>15528</sup>

SEGMENTS SQ-2 -- SQ-5

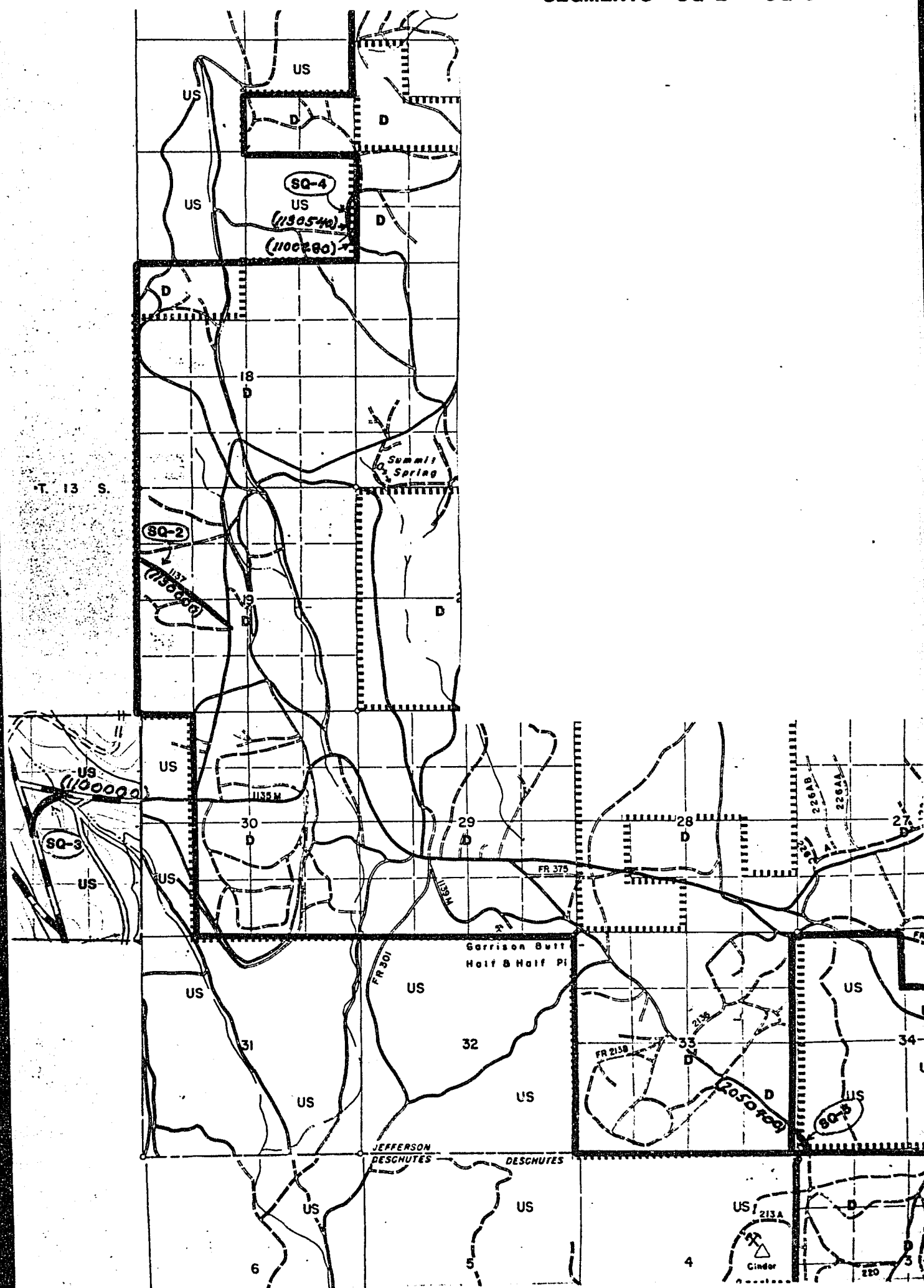

# SANTIAM BLOCK

PAGE 1 of 3

15529

SEGMENTS S-3 & S-28

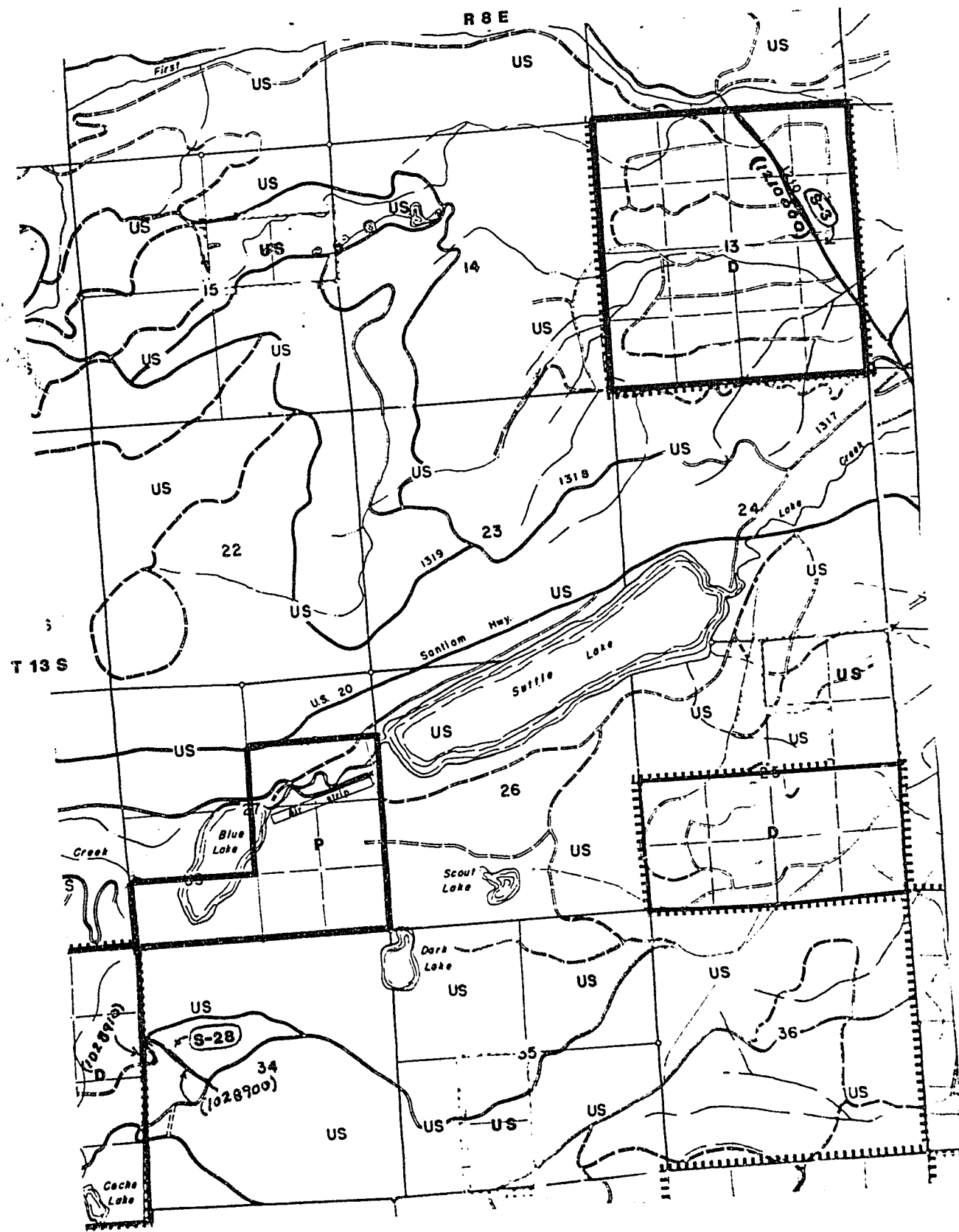

**SANTIAM BLOCK**

**SEGMENTS S-4,9,11--24,26,27,30,  
34--43,&46--48**

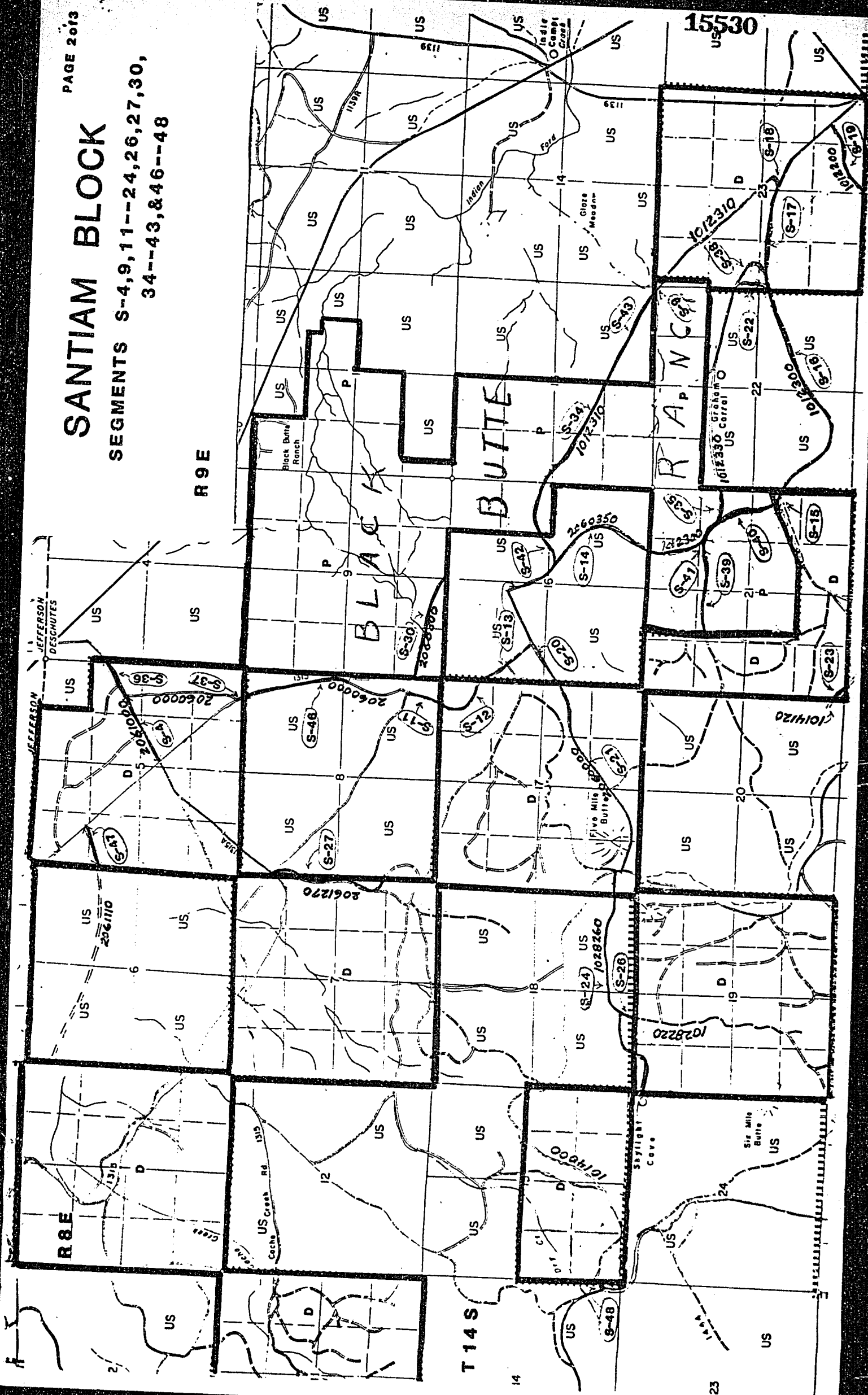

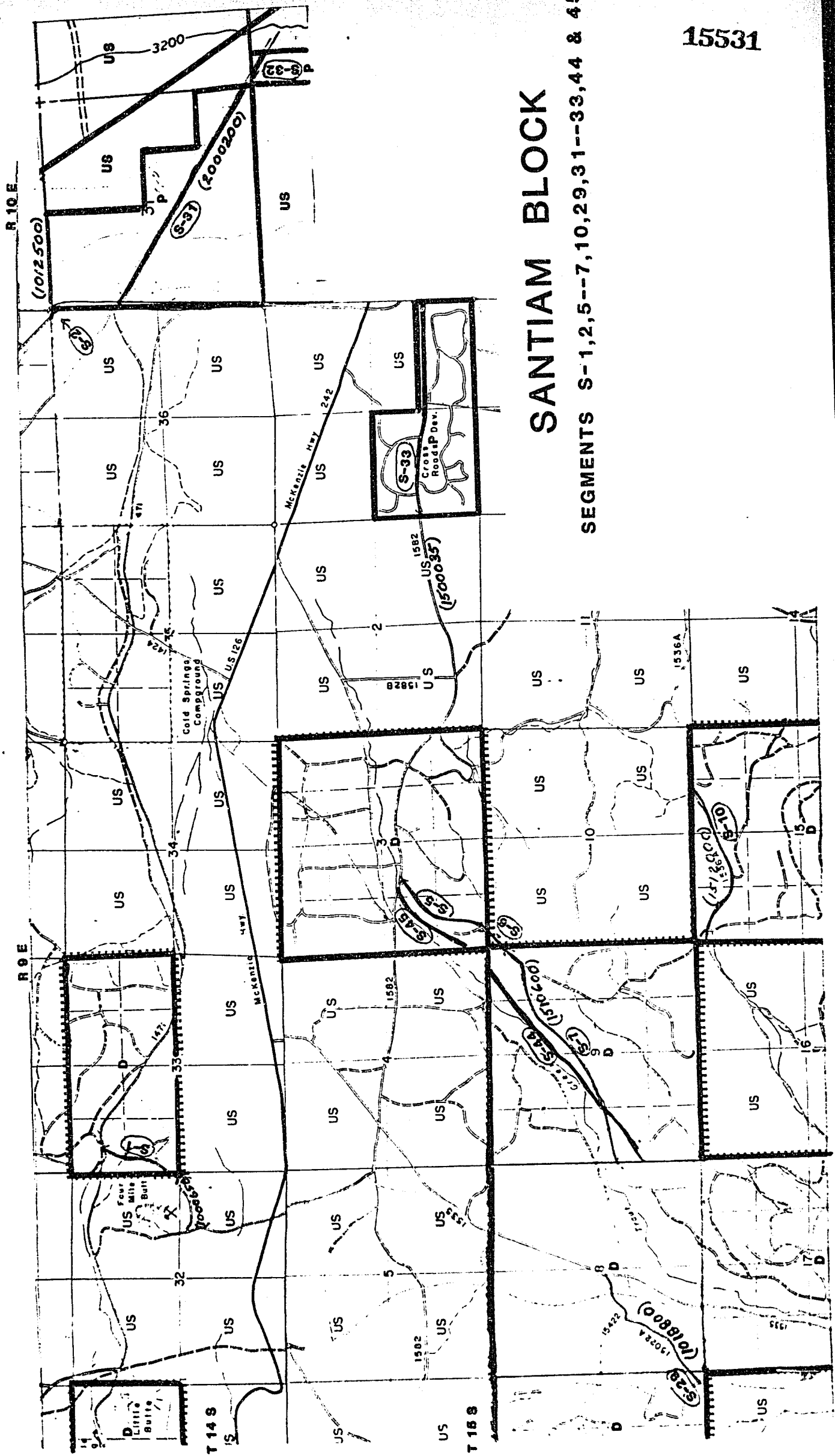

# SANTIAM BLOCK

SEGMENTS S-1, 2, 5--7, 10, 29, 31--33, 44 & 45

15531

# BULL SPRINGS BLOCK

15532

SEGMENT BS-2

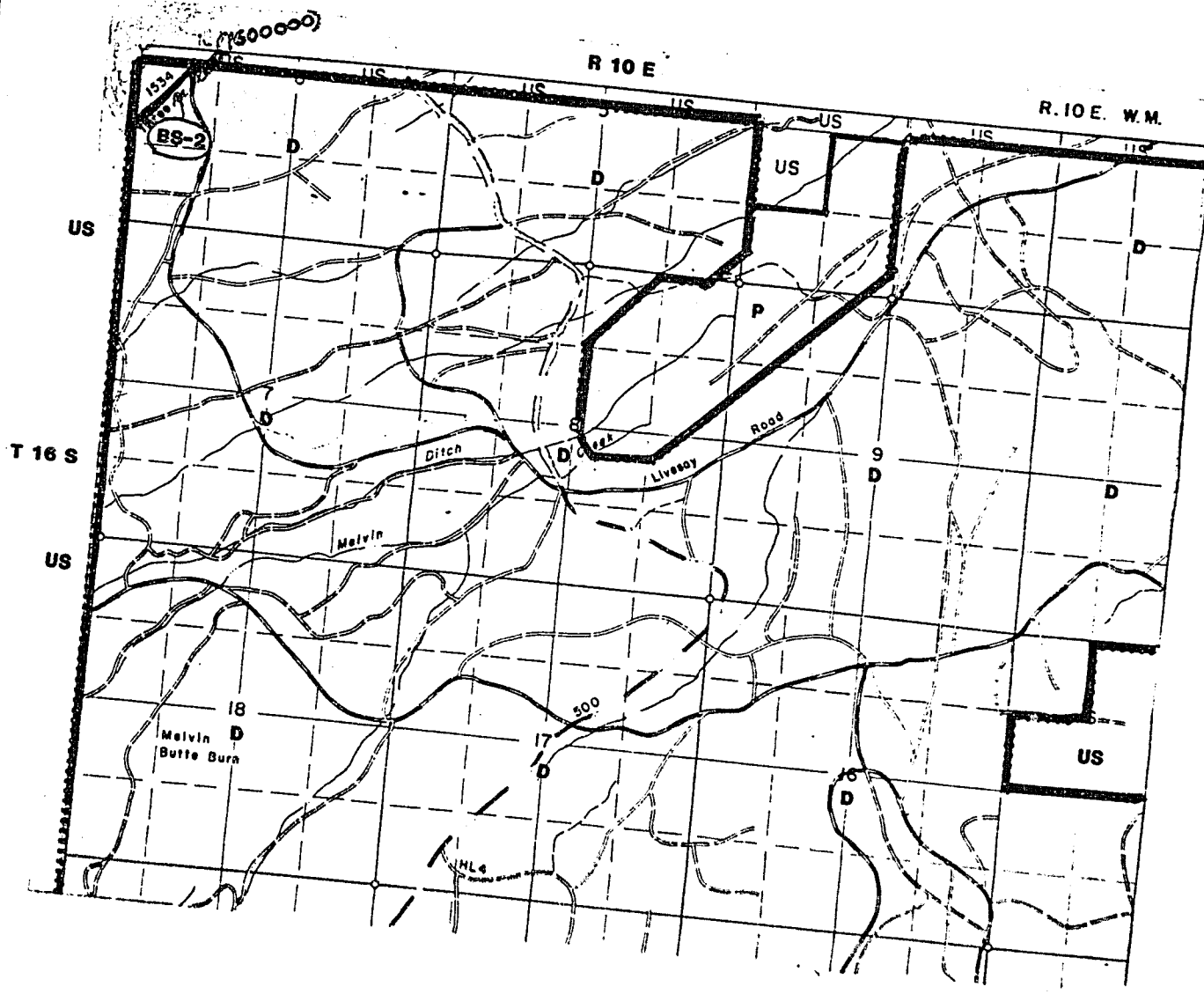



# BULL SPRINGS BLOCK

SEGMENTS BS-1,5--13 &amp; 16--19

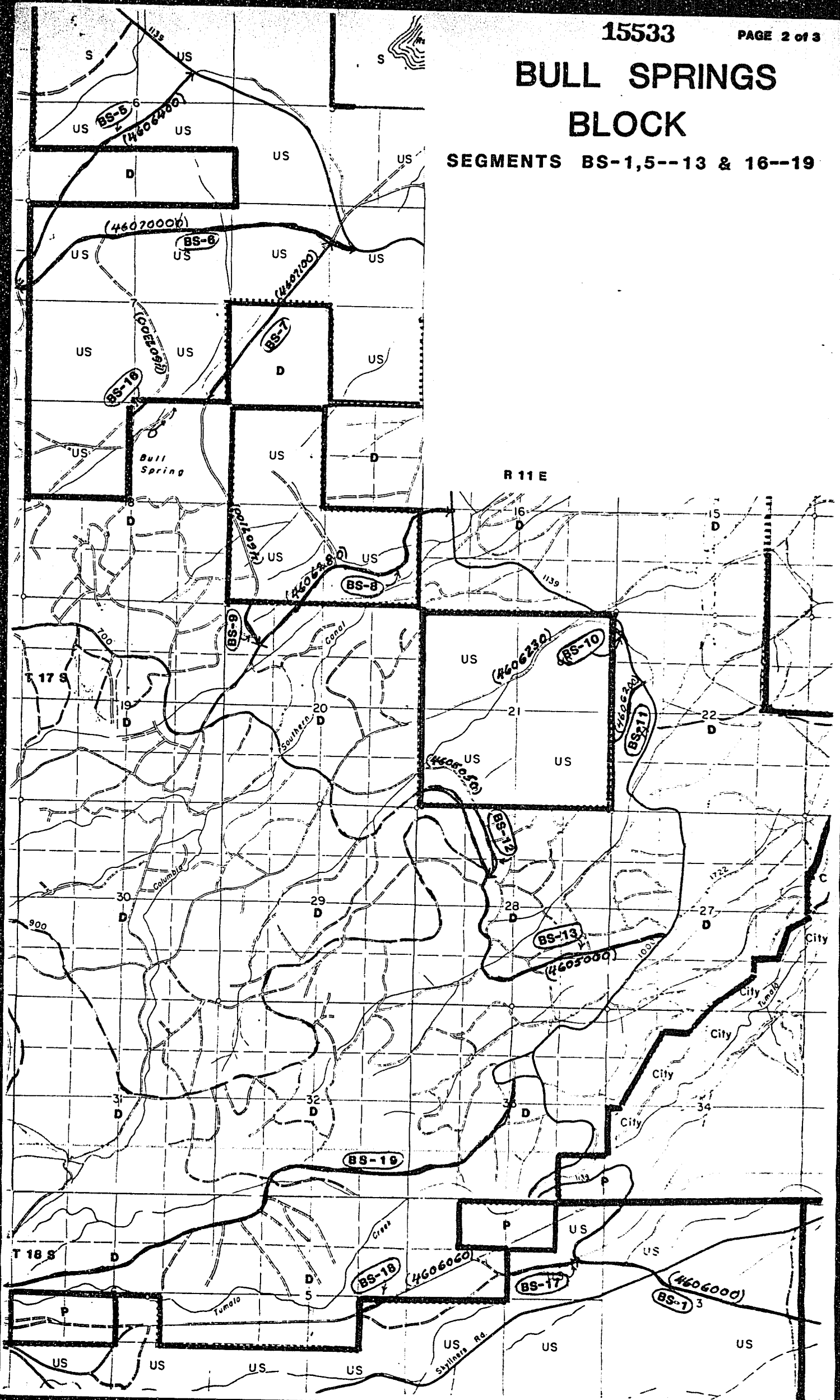

# BULL SPRINGS BLOCK

15534

PAGE 3 of 3

SEGMENTS BS-3, 14, 15 & 19

R 10 E

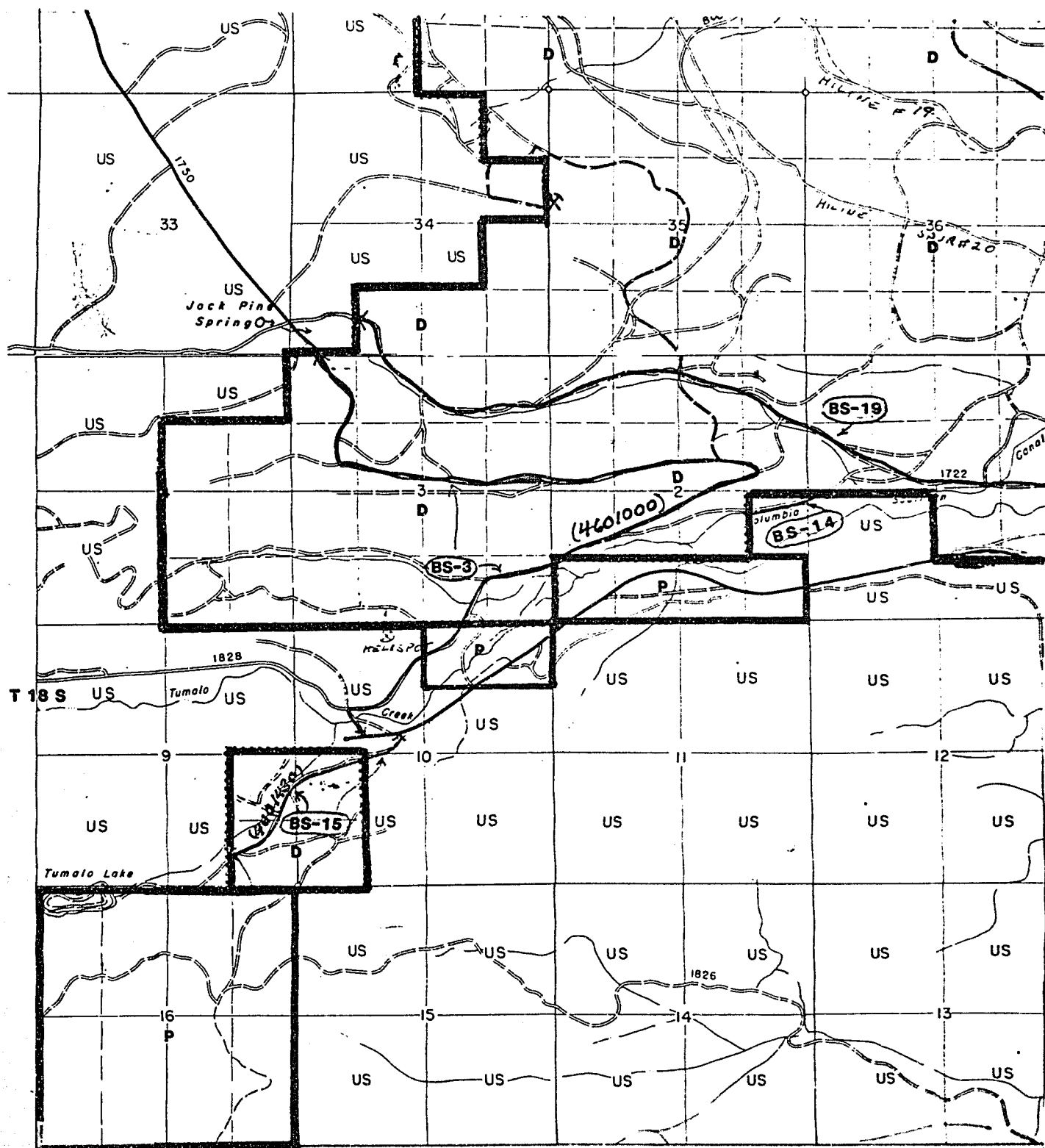

R. 10 E. W.M.



**Diamond  
International**  
Lumber

*Return to:*

Oregon Lumber  
a division of  
Diamond International Corporation

P.O. Box 1111  
Bend, OR 97709  
503/382-2511

# SPRING BUTTE BLOCK

SEGMENTS 1-12

Page 1 of 1



R 11 E

T 23 S

T 24 S

15535

STATE OF OREGON: COUNTY OF KLAMATH ;ss  
 I hereby certify that the within instrument was received and filed for  
 record on the 22nd day of November A.D., 1982 at 12:19 o'clock P M  
 and duly recorded in Vol M82 of Deeds on page 15513  
 FEE \$ 92.00  
 EVELYN BIEHN COUNTY CLERK  
 by Bernard A. Detoch Deputy

