

132128

Form 2769 4/80

RETURN TO:

C SCOTT
Bx 728

KFO 97601

Vol. 1184 Page 42

File No. 136-13799

ER/WO No. 31-713-136

W.O. 14768

UNDERGROUND
RIGHT-OF-WAY EASEMENT
(Individual)

For value received the undersigned, (Grantor), (whether singular or plural), do hereby grant to PACIFIC POWER & LIGHT COMPANY, a corporation, its successors and assigns, (Grantee), an easement or right-of-way, 10 feet in width, for an electric underground distribution line of one or more conductors and all necessary or desirable appurtenances (including but not limited to the right to install conduits, surface or subsurface mounted transformers, surface mounted connection boxes and meter cabinets), over, under, across and along the following described real property in Klamath County, State of Oregon to wit:

A portion of the northwest quarter (NW $\frac{1}{4}$) of the northeast quarter (NE $\frac{1}{4}$) of section 14, township 39 south, range 9 east, Willamette Meridian

PH 3 15

the location and course of said right-of-way are approximately as shown on the sketch attached as Exhibit ~~(A)~~ A and by this reference made a part hereof.

Together with the right of ingress and egress over the adjacent lands of Grantor in order to install, maintain, repair, replace, rebuild, operate and patrol the underground electric power lines and appurtenances, and to exercise all other rights herein granted.

Grantor shall have the right to use the lands subject to the above-described easement for all purposes not inconsistent with the uses and purposes herein set forth; provided that Grantor shall not build or erect any structure upon the right-of-way without the prior written consent of Grantee.

All rights hereunder shall cease if and when such line shall have been abandoned.

Dated this 21st day of October, 1983.

E. Sagens

(SEAL)

Phyllis E. Sagens

(SEAL)

STATE OF OREGONCounty of KLAMATH

(SEAL)

(SEAL)

On this 21 day of NOVEMBER, 1983, personally appeared before me a notary public in and for said State, the within named E. SAGENS AND PHYLLIS described therein and who executed the foregoing instrument, and acknowledged to me that THEY executed the same freely and voluntarily for the uses and purposes therein mentioned.

IN WITNESS WHEREOF, I have hereunto set my hand and official seal the day and year above written.

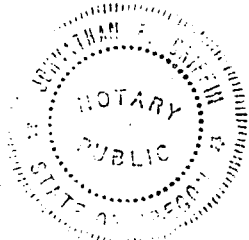

Jonathan E. Liffman
Notary Public for Oregon
Residing at Klamath Falls
My commission expires: 3-3-86

ck
8.00

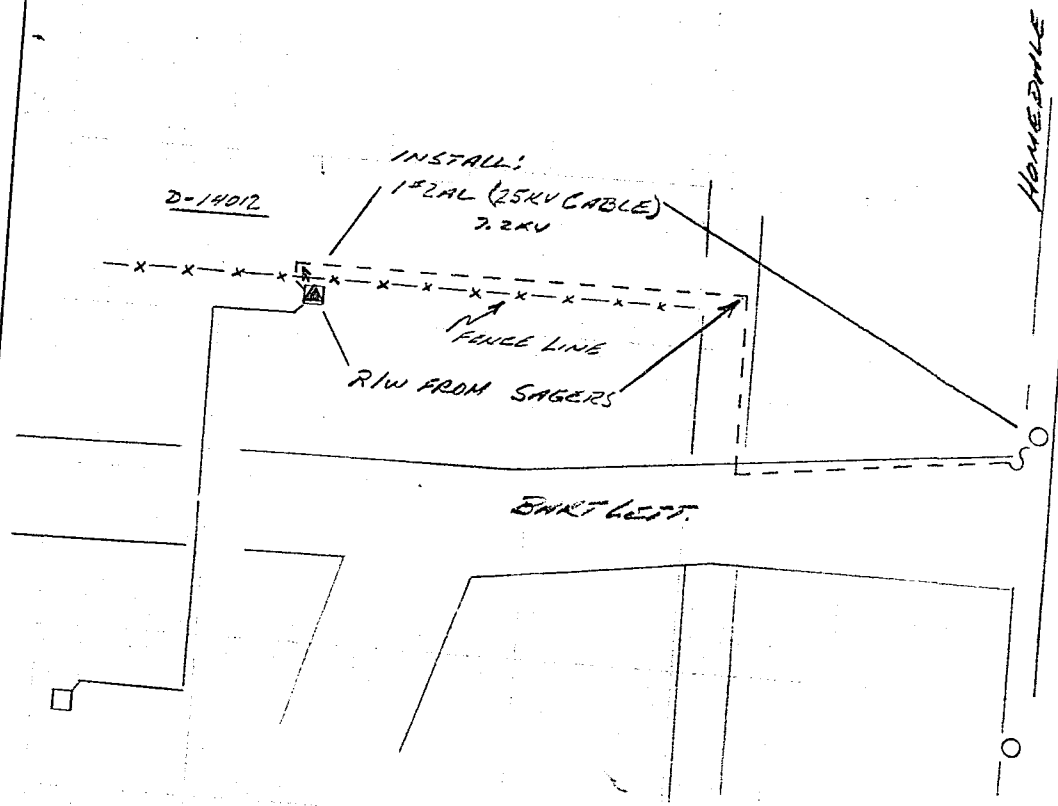

EXHIBIT "A"

DISTRICT <u>KLAMATH</u>		
NAME <u>V.E. SANGES</u>	FILE NO. <u>13774</u>	
LOCATION <u>GATEWOOD</u>	ER NO. <u>31-715-136</u>	
MAP NO. <u>D-69-6-B-1</u>	W.O. <u>14768</u>	
DRAWN <u>11-1-1983</u>		

PACIFIC POWER & LIGHT COMPANY
E R SKETCH

SCALE 1" = 100'

STATE OF OREGON: COUNTY OF KLAMATH: ss
I hereby certify that the within instrument was received and filed for
record on the 3rd day of Jan A.D., 1984 at 3:15 o'clock P M,
and duly recorded in Vol M84, of Deeds on page 10.

EVELYN BIEHN, COUNTY CLERK
by Sam Smith Deputy

Fee \$ 8.00

FORM 2705-A/74