

OL

35372

NO. 4

2100 FALCON HT WIL
D3414 V KICKFORWARD

NO. 5

LOCATION DISCOVERY
POST NO. 1

NO. 6

THIS DISCOVERY

Vol. 189 Page 5817
Notice of Mining Location
VEIN OR LODE CLAIM

STATE OF OREGON,

County of Klamath

- Mining District

NOTICE HEREBY IS GIVEN that the undersigned locators, each a citizen of the United States or one who has declared his intention to become such, have discovered a vein or lode of locatable mineral bearing rock in place upon the public domain of the United States which is open to mineral entry and location within the above state, county and mining district; and, in accordance with the laws of the United States and of the State of Oregon, have located and do hereby locate a claim upon such vein or lode by posting this notice of such discovery and location on a substantial post or monument at the point of discovery, marked Post No. 1. The name of the claim is: ELK HAVEN Mining District

Commencing at a post marked No. 1 (Discovery Post), thence Claim, further described as follows:
feet in a _____

Commencing at a post marked No. 1 (Discovery Post), thence

feet in a

feet in a

feet in a

feet in a

feet in a

feet in a

feet in a .

direction to an end post marked No. 2, thence
direction to a corner post

direction to a corner post marked No. 3, thence
direction to a corner post marked No. 3, thence

direction to an end post marked No. 5, thence

direction to a corner post marked No. 5, thence
direction to a corner post marked No. 6, thence
direction to a corner post marked No. 7, thence

..... direction to said end post marked No. 2
feet in a S 1/4

... end line and 1495'

end line and 1495'

The locators claim 5'

direction from point of discovery to the SW
feet in the opposite direction.

feet in the opposite direction from point of discovery to the NE
290 feet on each side of the

claim is further described as being _____ feet from a natural object or permanent monument in the vicinity, to-wit: This claim joins the Buck Point Claim with its S.W. End Line

end line and 149.5'

end line and

The general course or strike of the vein or lode as nearly as may be determined is SW-NE
This claim is situated in the NE 1/4 with reference to the natural object or permanent monument described above,
245, Range 5 1/2 E (designate quarter section) of Section 22, Township
or protracted if the land is unsurveyed, of the Willamette Meridian, as surveyed by the U.S. Government
The end lines of the claim

The end lines of the claim are parallel to each other. The adjoining claims are the Fawn Lake & Buck Point to SW, and Grater Butte, ~~the~~ small claim & D. J. claim to NE.

This notice is placed conspicuously at discovery post No. 1; posts are placed at each corner and both center ends. The location of this claim is distinctly marked on the ground so that the boundaries of the claim may be readily traced. In construing this location notice, the singular includes the plural and vice versa, where the context so requires.

Located April 9 1984

Located April 9

19.84

David A. Kleppert

David A. Kropfenstein

5160 Lardon Rd NE Salem, Ore 97305

Steve Stevenson

owner-operator Prospect Landfill-Jackson Co
Prospect, Ore

Locator(s).

Philip J. de
my commission
expires 11.16.86

Sec. 23. "A mining claim *** may equal, but shall not exceed, one thousand five hundred feet in length along the vein or lode; but no location of a mining claim shall be made until the discovery of the vein or lode within the limits of the claim located. No claim shall extend more than three hundred feet on each side of the middle of the vein at the surface *** The end lines of each claim shall be parallel to each other."

Sec. 28. "The location must be distinctly marked on the ground so

Excerpts from the mining laws of the United States, 30 U.S. Code Annotated

that its boundaries can be readily traced. All records of mining claims *** shall contain the name or names of the locators, the date of the location, and such a description of the claim or claims located by reference to some natural object or permanent monument as will identify the claim.***"

Sec. 34. "The description of vein or lode claims upon surveyed lands shall designate the location of the claims with reference to the lines of the public survey, but need not conform therewith ***"

Excerpts from Chapter 517, Oregon Revised Statutes Re: Location—Vein and Lode Claims

517.010. Location of mining claims upon veins or lodes. (1) Any person, a citizen of the United States, or one who has declared his intention to become such, who discovers a vein or lode of mineral-bearing rock in place upon the unappropriated public domain of the United States within this state, may locate a claim upon such vein or lode by posting thereon a notice of such discovery and location. The notice shall contain:

- The name of the lode or claim.
- The names of the locators.
- The date of the location.
- The number of linear feet claimed along the vein or lode each way from the point of discovery, with the width on each side of the lode or vein.
- The general course or strike of the vein or lode as nearly as may be, and by defining the boundaries upon the surface of each claim so that the same may be readily traced.

(2) Such boundaries shall be marked within 30 days after posting of such surface of the ground, and not less than three feet above the surface or by substantial mounds of stone, or four inches square or in diameter, to-wit: one such post or mound of rock at each corner and at the center ends of such claims.

CAUTION: The laws of nearly all western states contain special requirements for location notices. These requirements differ from state to state. The Oregon requirements are used for this form. If the claim for which this form is used is situated outside of Oregon, change the name of the state on the reverse side and, before locating a claim, carefully check this location notice with the laws of the state and the regulations of the mining district in which the claim is situated to ensure that the notice contains all things required.

CLAIM INFORMATION

Necessary steps in locating a vein or lode claim.

- Make a discovery of a valuable mineral deposit on federal land that is open to mineral entry and location.
- Post a completed notice of location at the point of discovery on a post or monument.
- Stake claim within 30 days of date of posting notice.
- File copy of notice of location with county clerk for the county in which the claim is located. Filing fee is as set by ordinance of the county governing body. Notice may be mailed in for recording. Notice must be recorded within 60 days from the posting of the notice on the claim.
- Record the claim with the BLM state office within 90 days after the date of location of the claim. If record by mail, obtain a return receipt.

Area and shape of a vein or lode claim.

A vein or lode claim can be not more than 1500 feet in length and can extend not more than 300 feet on either side of the vein or lode (Fig. 1-A). A full-sized vein or lode claim embraces an area of slightly more than 20½ acres. Although most claims are rectangular they may have a variety of shapes, the only requirement being that the end-lines be parallel. In the case of non-rectangular claims it should be noted that the end-lines need not be limited to 600 feet in length (Fig. 1-B).

Requirements of a vein or lode claim (Fig. 1-C).

- Location notice posted at or near point of discovery.
- At a minimum, four claim corner posts, or mounds of stone, and two center end posts, or mounds of stone. All posts must be at least 4 inches in diameter, and must project at least 3 feet above the ground. Mounds of stone, or earth and stone, must be at least 2 feet in height.

IMPORTANT NOTICE: A mining claim is deemed abandoned under 43 U.S. Code Sec. 1744 unless a copy of the official record of the notice of location is filed with the state office of the Bureau of Land Management in Portland within 90 days after the date of location of the claim. Because BLM recordation regulations change periodically, you should obtain recordation regulations from your local BLM office to determine effective requirements for recordation of notices of location, affidavits of annual assessment work, and notices of intention to hold a mining claim. Additional regulations of the BLM and the Forest Service may apply to the conducting of mining operations on national forest and BLM administered lands.

Vein or lode or placer location.

A placer discovery will not sustain a lode location, nor will a lode discovery sustain a placer location. Vein or lode claims are generally located where minerals occur in place in veins or lodes. For a lode claim there must be *** veins or lodes of quartz or other rock in place bearing gold, silver, copper, lead, tin, copper or other valuable deposits *** 30 U.S. Code Sec. 23. Placer claims are generally located where minerals have been derived from lumps or veins to form deposits such as stream gravels and gold-bearing alluvium.

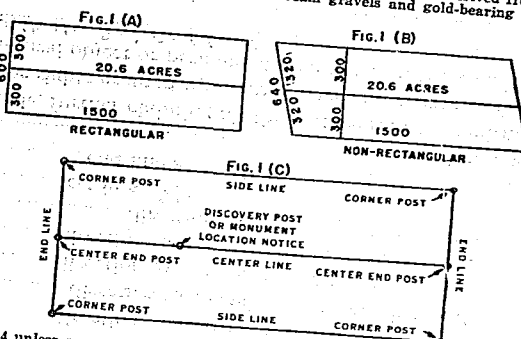

MINING LOCATION VEIN OR LODGE

(FORM No. 830)

ELK HAVEN

Name of Claim

DAVID A. KLOPFENSTEIN

DAK

JOHN SKERVENSON

DAVID A. KLOPFENSTEIN

Locators

AFTER RECORDING RETURN TO

David A. Klopfenstein
5160 Lardon Rd. NE
Salem, OR 97305

SPACE RESERVED
FOR
RECORDER'S USE

STATE OF OREGON,

County of Klamath

ss.

I certify that the within instrument was received for record on the 9th day of April, 1984, at 2:31 o'clock P.M., and recorded in book/reel/volume No. M84, on page 5847, or as fee/title/instrument/microfilm/reception No. 35372, Record of Mining Records of said County.

Witness my hand and seal of County affixed.

Evelyn Biehn, County Clerk

By: [Signature] Deputy

Fee: \$8.00