

A SPECIAL ORDINANCE WITHDRAWING CERTAIN
TERRITORY THAT HAS BEEN ANNEXED TO THE CITY
OF KLAMATH FALLS BY ORDINANCE NO. 6234
(THE "CHARLES PETERSON" ANNEXATION) FROM
THE WIARD PARK DISTRICT

WHEREAS, certain territory described below was annexed by the City of Klamath Falls by Ordinance No. 6234 (Charles Peterson annexation); and

WHEREAS, the territory described below is located within the boundaries of a portion of the Wiard Park District; and

WHEREAS, pursuant to Resolution No. 3076, the City Council held a public hearing to hear objections to the withdrawal of the territory from the above-named special service district; and

WHEREAS, under ORS 222.520, there are no previously contracted liabilities or indebtedness of the above-named district applicable to the territory; NOW THEREFORE

THE CITY OF KLAMATH FALLS ORDAINS AS FOLLOWS:

The following territory within the boundaries of the Wiard Park District shall be withdrawn from said district upon the effective date of this ordinance:

A parcel of land, containing 7.41 acres, more or less, being a portion of Tract 398 and Tract 40A, Enterprise Tracts, Klamath County, Oregon, being more particularly described as follows:

Beginning at a 5/8" iron rod, being on the Southerly right-of-way line of Beverly Drive, from which a steel axle marking the NW 1/16 corner of Section 34, Township 33 South, Range 9 East of the Willamette Meridian bears North 00°09'45" West 30.00 feet;

Thence South 00°09'45" East 874.73 feet to a 5/8" iron rod, being on the Northeasterly right-of-way line of Oregon State Highway 39 (Eastside Bypass) at centerline station 157+77.24;

Thence along the Northeasterly right-of-way line as follows;

North 39°54'55" West 513.66 feet to a 5/8" iron rod (centerline station 152+55.3);

Thence Northwesterly, along a Spiral Curve to the left 364.90 feet to a 5/8" iron rod (centerline station 149+00);

Thence North 45°02'07" East 15.00 feet to a 5/8" iron rod (centerline station 149+00);

Thence Northwesterly, along a Spiral Curve to the left 155.48 feet to a 5/8" iron rod (centerline station P.C.S. 147+55.3);

Thence along the arc of a curve to the left 138.72 feet (Central Angle 6°15'09", Radius 1270.92 feet, Chord bears North 53°02'29" West 133.62 feet) to a 5/8" iron rod, said point being the intersection of the said Northeasterly right-of-way line and the said Southerly right-of-way line (centerline station 146+30.25);

Thence leaving said Northeasterly right-of-way line, along said Southerly right-of-way line, North 89°39'00" East 787.09 feet to the point of beginning.

PASSED by the Council of the City of Klamath Falls, Oregon
this 3rd day of March, 1986.

5434

PRESENTED to the Mayor and by him approved and signed this
3rd day of March, 1986.

George C. Fitzpatrick
Mayor

ATTEST:

Donna L. Wohlwend
Recorder

STATE OF OREGON,)
COUNTY OF KLAMATH,) ss.
CITY OF KLAMATH FALLS.)

I, Donna Wohlwend, Recorder for the City of Klamath Falls, Oregon, do hereby certify that the above and foregoing is a true and correct copy of an Ordinance duly adopted by the Council of the City of Klamath Falls at a regular meeting held on the 3rd day of March, 1986, and thereafter approved and signed by the Mayor and attested by the City Recorder.

Donna L. Wohlwend
Recorder

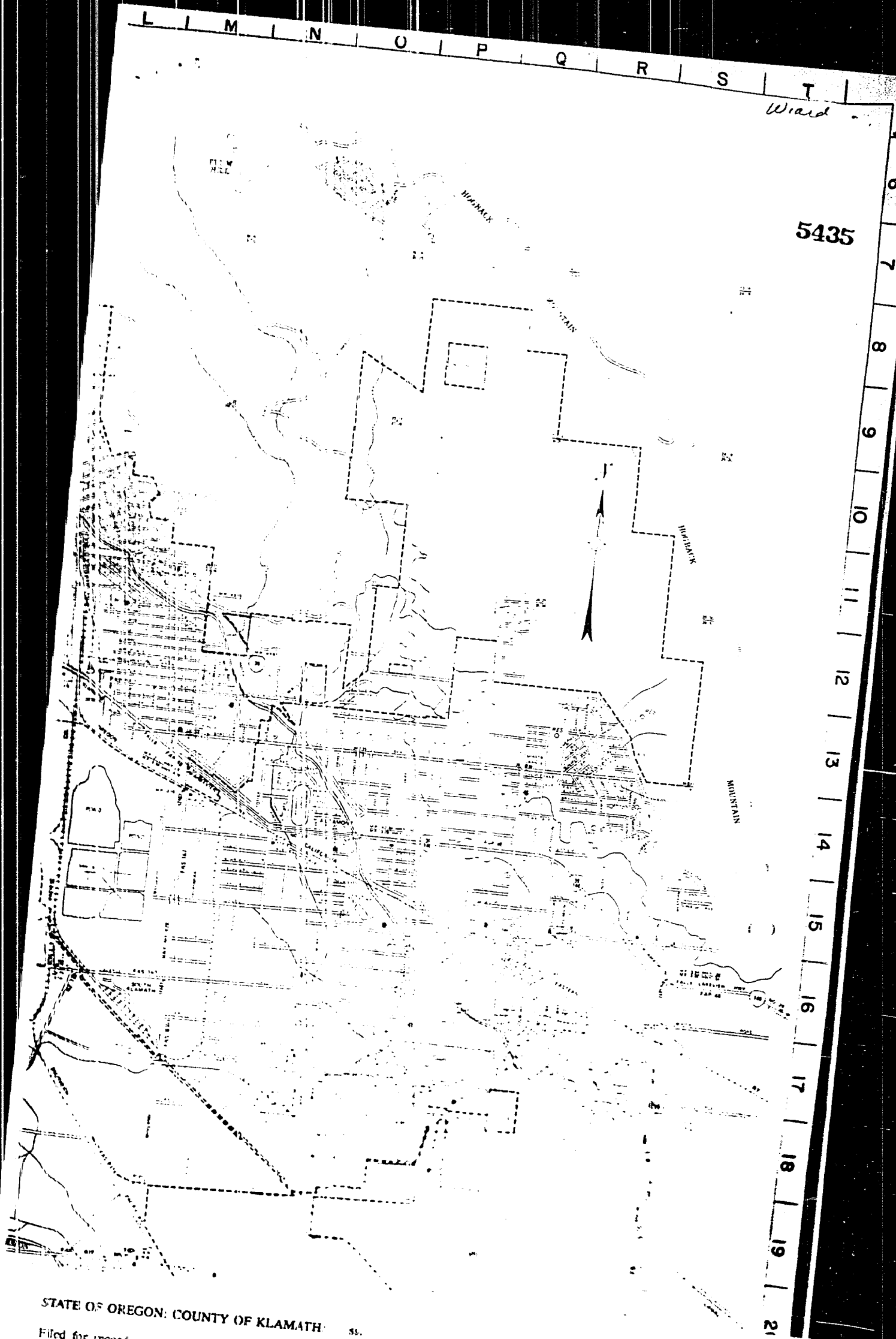

STATE OF OREGON: COUNTY OF KLAMATH

55.

Filed for record at request of
of April

A.D. 19 86 at 2:31
of Deeds

o'clock P.M., and duly recorded in Vol. M86 day

on Page 5433

EVELYN BIEHN

By

County Clerk

FEE None