

61714

RIGHT-OF-WAY EASEMENT
(Corporate)

For value received, W. C. Ranch, Inc.
Oregon corporation, hereinafter referred to as Grantor, does hereby grant to PACIFIC
 POWER & LIGHT COMPANY, a corporation, its successors and assigns, the Grantee, an easement or right-
 of-way 10 feet in width for an electric transmission and distribution line of one or more wires and all
 necessary or desirable appurtenances; (including telephone and telegraph wires, towers, poles, props, guys,
 anchors and other supports and the right to place all or any part of such line underground, and the right to
 place such guys and anchors outside of said right-of-way), the centerline of which is at or near the location
 and along the general course now located and staked out by the Grantee over, across and upon the following
 described real property in Klamath County, State of Oregon, to wit:
 Located in the Southwest $\frac{1}{4}$ of the Southwest $\frac{1}{4}$ of Section 3,

Township 39 South, Range 9 East, Willamette Meridian.

Said right-of-way to be 10 feet wide, 5 feet each side of centerline.

Including the right to clear said right-of-way and keep the same clear of brush, trees, timber and structures,
 and the right to top, trim, clear or cut away all trees outside of said right-of-way which might endanger such line.

Together with the right of ingress and egress over the adjacent lands of the Grantor for the purpose of con-
 structing, reconstructing, stringing new wires on, maintaining and removing such line and appurtenances, and
 exercising other rights hereby granted.

At no time shall any building nor anything flammable be erected, permitted or placed within the bounda-
 ries of said right-of-way, nor shall any material or equipment of any kind or nature which exceeds _____
 feet in height be used thereon by Grantor, or by Grantor's successors or assigns.

Grantor reserves the right to use said right-of-way for roads, agricultural crops or other purposes not incon-
 sistent with the easement granted hereby, but in using or operating any irrigation pipes, motorized vehicles
 or other equipment or in any other such use of said right-of-way, Grantor (including its successors or assigns)
 shall conform strictly to the provisions of any then applicable safety code or regulation pertaining to required
 clearances from the wires or conductors of such line.

All rights hereunder shall cease if and when such line shall have been abandoned.

Dated this _____ day of _____

By:

W. C. Ranch, Inc.
W. C. Ranch (Title)

Attest:

(Title)

STATE OF Oregon

ss.

County of KlamathOn this 19th day of May, 1986

before me personally appeared _____
 to me personally known to be the _____
 of the corporation that executed the within and foregoing instrument; who, duly sworn, on oath did say: that
 he is the W. C. Ranch of the corporation that executed the within foregoing instrument; that the
 seal affixed to said instrument is the corporate seal of said corporation, and that said instrument was signed and
 sealed in behalf of said corporation by authority of its Board of Directors, and he acknowledged said instrument
 to be the free act and deed of said corporation for the uses and purposes therein mentioned.

IN WITNESS WHEREOF, I have hereunto set my hand and official seal the day and year above written.

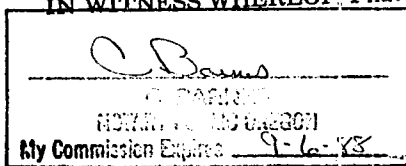
Notary Public for OregonResiding at Medell, ORMy commission expires 9-6-88

8904

SEND TO:
D. BOND
P. O. BOX 728
KLAMATH FALLS, OR 97601

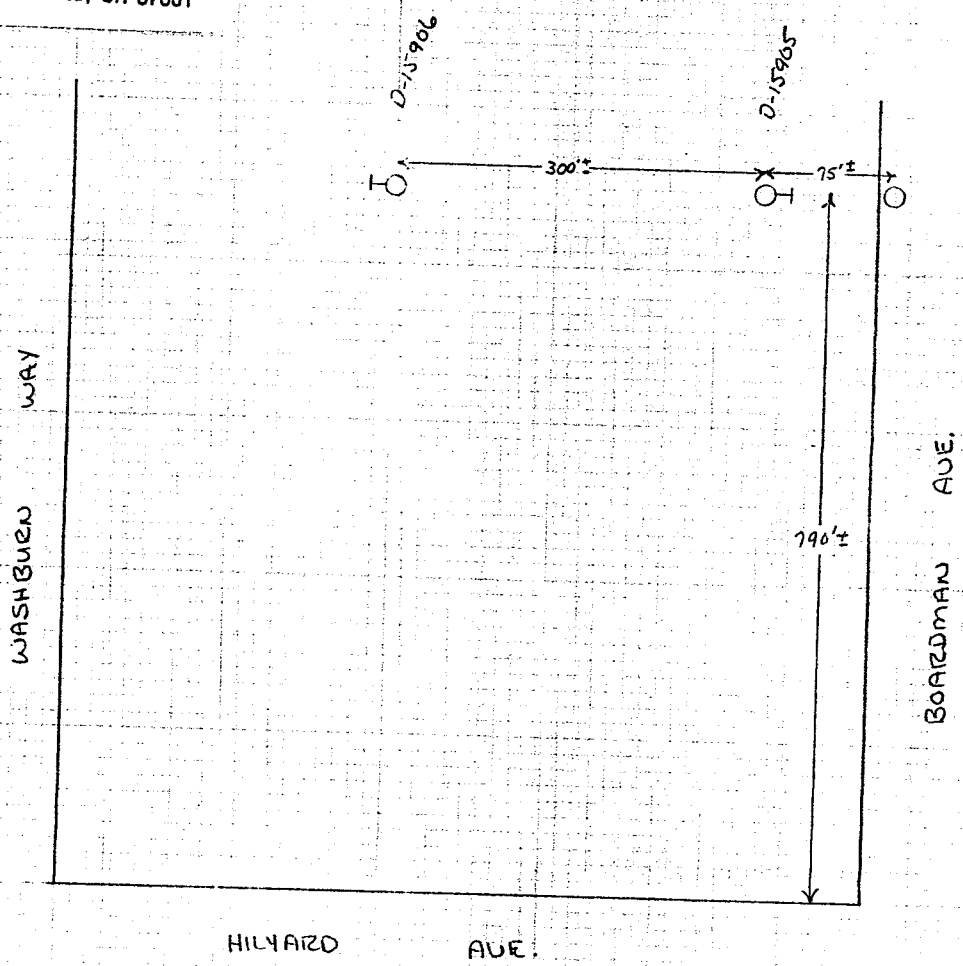

FOR LOCATION PURPOSES ONLY

DISTRICT _____		
NAME _____	FILE NO. _____	
LOCATION _____	E R NO. _____	
MAP NO. _____	W.O. _____	
DRAWN _____ 19 _____		

PACIFIC POWER & LIGHT COMPANY
E R SKETCH

SCALE _____

FORM 2708-4/74

STATE OF OREGON: COUNTY OF KLAMATH: ss.

Filed for record at request of _____ the _____ 23rd day
of May A.D., 19 86 at 11:02 o'clock A M., and duly recorded in Vol. M86
of _____ Deed: _____ on Page 8903

FEE \$9.00

Evelyn Biehn, County Clerk
By [Signature]