

UNDERGROUND
RIGHT-OF-WAY EASEMENT
(Individual)Vol. 1880 Page 18189

For value received the undersigned, (Grantor), (whether singular or plural), do hereby grant to PACIFIC POWER & LIGHT COMPANY, a corporation, its successors and assigns, (Grantee), an easement or right-of-way, 10 feet in width, for an electric underground distribution line of one or more conductors and all necessary or desirable appurtenances (including but not limited to the right to install conduits, surface or subsurface mounted transformers, surface mounted connection boxes and meter cabinets), over, under, across and along the following described real property in KLAMATH County, State of OREGON, to wit: SITUATED IN TAX LOT 5900 IN THE SOUTHWEST QUARTER OF THE NORTHEAST QUARTER OF THE NORTHWEST QUARTER, THE NORTHEAST QUARTER OF THE NORTHWEST QUARTER OF THE NORTHWEST QUARTER, THE SOUTHEAST QUARTER OF THE NORTHWEST QUARTER OF THE NORTHWEST QUARTER AND THE SOUTHWEST QUARTER OF THE NORTHWEST QUARTER ALL LOCATED IN SECTION 23, TOWNSHIP 40 SOUTH, RANGE 11 EAST, WILLAMETTE MERIDIAN.

the location and course of said right-of-way are approximately as shown on the sketch attached as Exhibit(s) A and by this reference made a part hereof.

Together with the right of ingress and egress over the adjacent lands of Grantor in order to install, maintain, repair, replace, rebuild, operate and patrol the underground electric power lines and appurtenances, and to exercise all other rights herein granted.

Grantor shall have the right to use the lands subject to the above-described easement for all purposes not inconsistent with the uses and purposes herein set forth; provided that Grantor shall not build or erect any structure upon the right-of-way without the prior written consent of Grantee.

All rights hereunder shall cease if and when such line shall have been abandoned.

Dated this 17th day of September, 1986.

(SEAL)

JOSEPH G. THOMPSON

(SEAL)

(SEAL)

(SEAL)

STATE OF OREGON
County of KLAMATH

On this 17th day of September, 1986, personally appeared before me a notary public in and for said State, the within named Joseph G. Thompson to me known to be the identical person described therein and who executed the foregoing instrument, and acknowledged to me that HE executed the same freely and voluntarily for the uses and purposes therein mentioned.

IN WITNESS WHEREOF, I have hereunto set my hand and official seal the day and year above written.

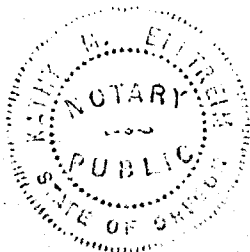

Kathy M. Edtman
Notary Public for State of Oregon
Residing at 2420 7th St. Malin, Oregon
My commission expires: 4-10-89

CH
922
Set:
D. Scott
Box 728
HFO

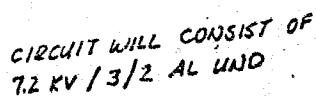

ALL CROSSINGS
LOCATED IN
TAX LOT 5900

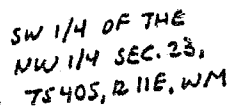

PACIFIC POWER & LIGHT COMPANY
E R SKETCH

DISTRICT <u>KLAMATH</u>		FILE NO.	1285
NAME <u>MCI</u>		ER NO.	136-31-
LOCATION <u>HAPPOLD RD.</u>		W.O.	
MAP NO. _____ 19 _____			
DRAWN _____			

FORM 2708-4/74

STATE OF OREGON: COUNTY OF KLAMATH: ss.

Filed for record at request of _____ the _____ day
of _____ October _____ A.D., 19 36 at 11:59 o'clock A M., and duly recorded in Vol. 1886
of _____ of _____ Deeds _____ on Page 13139.

Evelyn Bichin, County Clerk
By [Signature]

FEE \$9.00