

77741

Vol. 1887 Page _____

UNDERGROUND
RIGHT-OF-WAY EASEMENT
(Individual)

For value received the undersigned, (Grantor), (whether singular or plural), do hereby grant to PACIFIC POWER & LIGHT COMPANY, a corporation, its successors and assigns, (Grantee), an easement or right-of-way, 10 feet in width, for an electric underground distribution line of one or more conductors and all necessary or desirable appurtenances (including but not limited to the right to install conduits, surface or subsurface mounted transformers, surface mounted connection boxes and meter cabinets), over, under, across and along the following described real property in Klamath County, State of Oregon, to wit:

Located in Tax Lot 1800 in the Southeast $\frac{1}{4}$ of the Southeast $\frac{1}{4}$ of Section 20,

12 Township 37 South, Range 9 East, Willamette Meridian.

4 PM 3 the location and course of said right-of-way are approximately as shown on the sketch attached as Exhibit(s) A and by this reference made a part hereof.

37 AUG Together with the right of ingress and egress over the adjacent lands of Grantor in order to install, maintain, repair, replace, rebuild, operate and patrol the underground electric power lines and appurtenances, and to exercise all other rights herein granted.

Grantor shall have the right to use the lands subject to the above-described easement for all purposes not inconsistent with the uses and purposes herein set forth; provided that Grantor shall not build or erect any structure upon the right-of-way without the prior written consent of Grantee.

All rights hereunder shall cease if and when such line shall have been abandoned.

Dated this 28 day of July, 1987.

Miles D. Stevens (SEAL) _____ (SEAL)
_____. (SEAL) _____ (SEAL)

STATE OF OREGON

County of KLAMATH

On this 28th day of July, 1987, personally appeared before me a notary public in and for said State, the within named Miles D. Stevens

to me known to be the identical person described therein and who executed the foregoing instrument, and acknowledged to me that he executed the same freely and voluntarily for the uses and purposes therein mentioned.

IN WITNESS WHEREOF, I have hereunto set my hand and official seal the day and year above written.

Marie Campbell
Notary Public for OREGON
Residing at 3737 Shasta Way, K. Falls, OR
My commission expires: 7-25-89

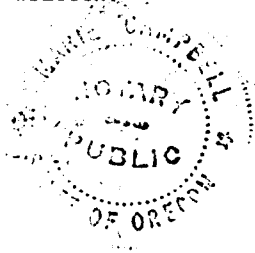

90x
200

13963

"EXHIBIT A"

SE 1/4 OF SE 1/4 OF
SEC. 20, T. 37 S.,
R. 9 E., W.M.

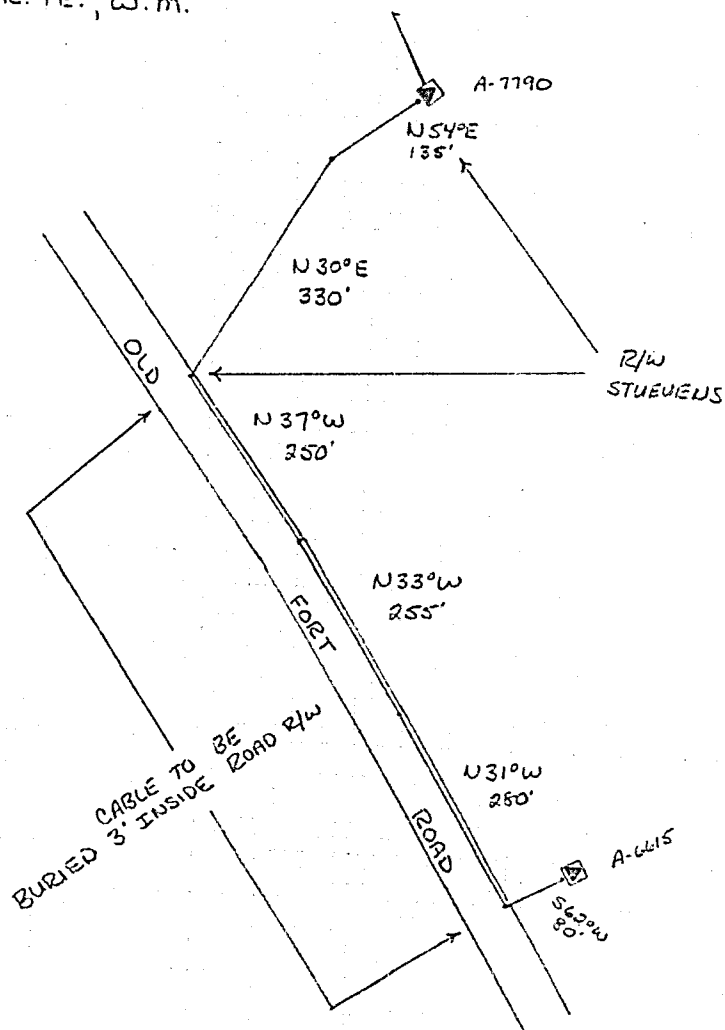

DISTRICT <u>KLAMATH</u>			
NAME <u>MILES STUEVENS</u>	FILE NO.		
LOCATION <u>OLD FORT RD</u>	ER NO.		
MAP NO. <u>A-67-9-A3 67-4</u>	NO.	<u>31-710</u>	
DRAWN <u>JOHN G. 4-9 1987</u>	W.O.	<u>3840</u>	

PACIFIC POWER & LIGHT COMPANY
E R SKETCH

SCALE 1" = 200'

FORM 2708-4/74

STATE OF OREGON: COUNTY OF KLAMATH: SS.

Filed for record at request of Pacific Power & Light
of August A.D. 19 87 at 3:12 o'clock P M., and duly recorded in Vol. M87
of Deeds on Page 13962.

FEE \$9.00

Return: D. Bond, Box 728, Klamath Falls, Oregon

Evelyn Biehn, County Clerk

By

John G. Smith