

80813

UNDERGROUND
RIGHT-OF-WAY EASEMENT
(Individual)Vol. 1187 Page 19273

For value received the undersigned, (Grantor), (whether singular or plural), do hereby grant to PACIFIC POWER & LIGHT COMPANY, a corporation, its successors and assigns, (Grantee), an easement or right-of-way, 10 feet in width, for an electric underground distribution line of one or more conductors and all necessary or desirable appurtenances (including but not limited to the right to install conduits, surface or subsurface mounted transformers, surface mounted connection boxes and meter cabinets), over, under, across and along the following described real property in KLAMATH County, State of OREGON, to wit:

SITUATED IN TAX LOT 200, IN THE NORTHEAST QUARTER OF THE NORTHEAST QUARTER OF SECTION 33, TOWNSHIP 39 SOUTH, RANGE 10 EAST, WILLAMETTE MERIDIAN.

the location and course of said right-of-way are approximately as shown on the sketch attached as Exhibit(s) "A" and by this reference made a part hereof.

Together with the right of ingress and egress over the adjacent lands of Grantor in order to install, maintain, repair, replace, rebuild, operate and patrol the underground electric power lines and appurtenances, and to exercise all other rights herein granted.

Grantor shall have the right to use the lands subject to the above-described easement for all purposes not inconsistent with the uses and purposes herein set forth; provided that Grantor shall not build or erect any structure upon the right-of-way without the prior written consent of Grantee.

All rights hereunder shall cease if and when such line shall have been abandoned.

Dated this 15th day of September, 1987.

x Diana Nelson (SEAL) x Randy C. Nelson (SEAL)

(SEAL) _____ (SEAL)

STATE OF Oregon
County of Klamath

On this 15th day of September, 1987, personally appeared before me a notary public in and for said State, the within named Diana Nelson and Randy C. Nelson and to me known to be the identical person described therein and who executed the foregoing instrument, and acknowledged to me that they executed the same freely and voluntarily for the uses and purposes therein mentioned.

IN WITNESS WHEREOF, I have hereunto set my hand and official seal the 15th day and year above written.

Ret. D Bond
Box 728
MFO

[Signature]
Notary Public for Oregon
Residing at Klamath Falls
My commission expires: 7/13/89

87 OCT 23 PM 2 09

OK
10:00

19274

SITUATED IN THE NE¹/₄ NE⁴ OF
SECTION 33, TS 39 S, R 10 E, WM
TAX LOT 200

EXISTING VAULT
D-16101

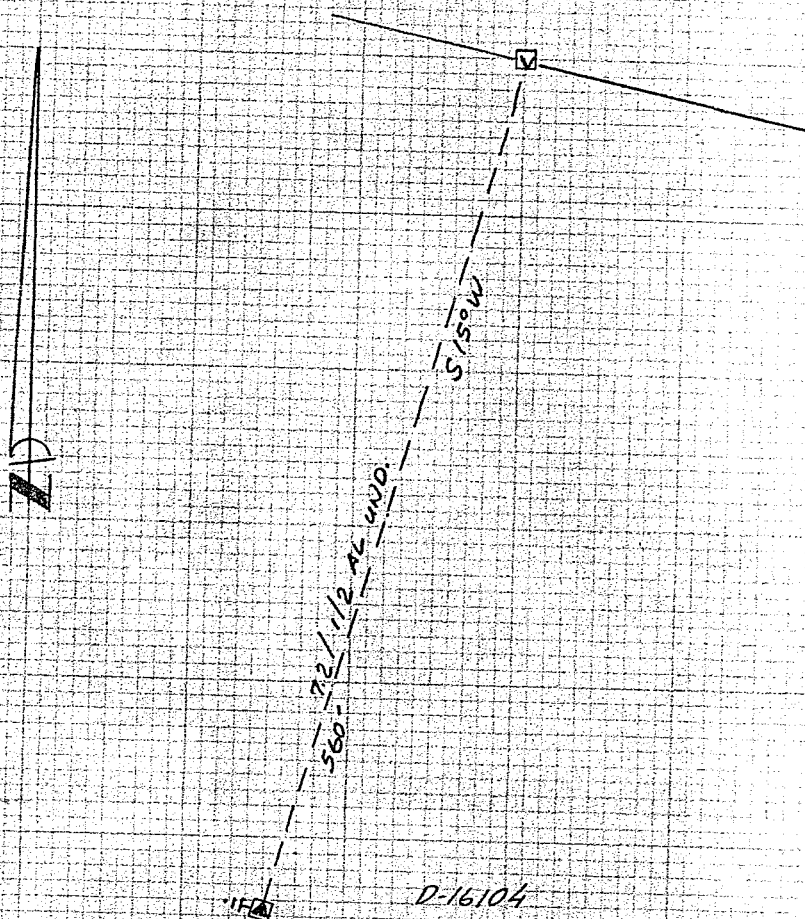

EXHIBIT "A"

DISTRICT <u>KLAMATH</u>			
NAME <u>RANDY NELSON</u>	FILE NO.		
LOCATION <u>HILL RD.</u>	E R NO.	<u>136-31-710</u>	
MAP NO. <u>D-88-8</u>	W.O.	<u>4272</u>	
DRAWN <u>J. COX 9-15-87</u>			

PACIFIC POWER & LIGHT COMPANY
E R SKETCH

SCALE 1"=100'

FORM 2708-4/74

STATE OF OREGON: COUNTY OF KLAMATH: ss.

Filed for record at request of Pacific Power & Light Company the 23rd day
of October A.D., 19 87 at 2:09 o'clock P M., and duly recorded in Vol. M87
of Deeds on Page 19273

FEE \$10.00

Evelyn Biehn County Clerk
By [Signature]