

86336

RIGHT-OF-WAY EASEMENT (Individual)

File No. _____
ER/WO No. 136-31-700-4681
K-5862

Vol. 788 Page 5662

For value received the undersigned, hereinafter referred to as Grantors, (whether singular or plural), do hereby grant to PACIFIC POWER & LIGHT COMPANY, a corporation, its successors and assigns, the Grantee, an easement or right-of-way 15 feet in width for an electric transmission and distribution line of one or more wires and all necessary or desirable appurtenances (including telephone and telegraph wires, towers, poles, props, guys, anchors and other supports and the right to place all or any part of such line underground and the right to place such guys and anchors outside of said right-of-way), the centerline of which is at or near the location and along the general course now located and staked out by the Grantee over, across and upon the following described real property in Klamath County, State of Oregon, to wit:

A portion of the Southwest Quarter (SW $\frac{1}{4}$) of the Northwest Quarter (NW $\frac{1}{4}$) of Section 23, Township 38 South, Range 11 East, of the Willamette Meridian.

The location and course of said Right-of-Way are approximately as shown on the sketch attached as exhibit "A" and by this reference made a part hereof.

Including the right to clear said right-of-way and keep the same clear of brush, trees, timber and structures, and the right to top, trim, clear or cut away all trees outside of said right-of-way which might endanger such line.

Together with the right of ingress and egress over the adjacent lands of the Grantors for the purpose of constructing, reconstructing, string new wires on, maintaining and removing such line and appurtenances, and exercising other rights hereby granted.

At no time shall any building or anything flammable be erected, permitted or placed within the boundaries of said right-of-way, nor shall any material or equipment of any kind or nature which exceeds _____ feet in height be used thereon by Grantors, or by Grantors' heirs or assigns.

Grantors reserve the right to use said right-of-way for roads, agricultural crops or other purposes not inconsistent with the easement granted hereby, but in using or operating any irrigation pipes, motorized vehicles or other equipment, or in any other such use of said right-of-way, Grantors and Grantors' heirs or assigns, shall conform strictly to the provisions of any then applicable safety code or regulation pertaining to required clearances from the wires or conductors of such line.

All rights hereunder shall cease if and when such line shall have been abandoned.

Dated this 24 day of March, 1988.

Carl R. Stallings (SEAL) _____ (SEAL)
Carl R. Stallings _____ (SEAL)

STATE OF Oregon _____ (SEAL)

County of Klamath } ss.

On this 24 day of March, 1988, personally appeared before me a notary public in and for said State, the within named Carl R. Stallings, described therein and who executed the foregoing instrument, and to me known to be the identical person acknowledged to me that he executed the same freely and voluntarily for the uses and purposes therein mentioned.

IN WITNESS WHEREOF, I have hereunto set my hand and official seal the day and year above written.

Alvin L. Smith
Notary Public for Oregon
Residing at Bonanza, Oregon
My commission expires: 3/24/89

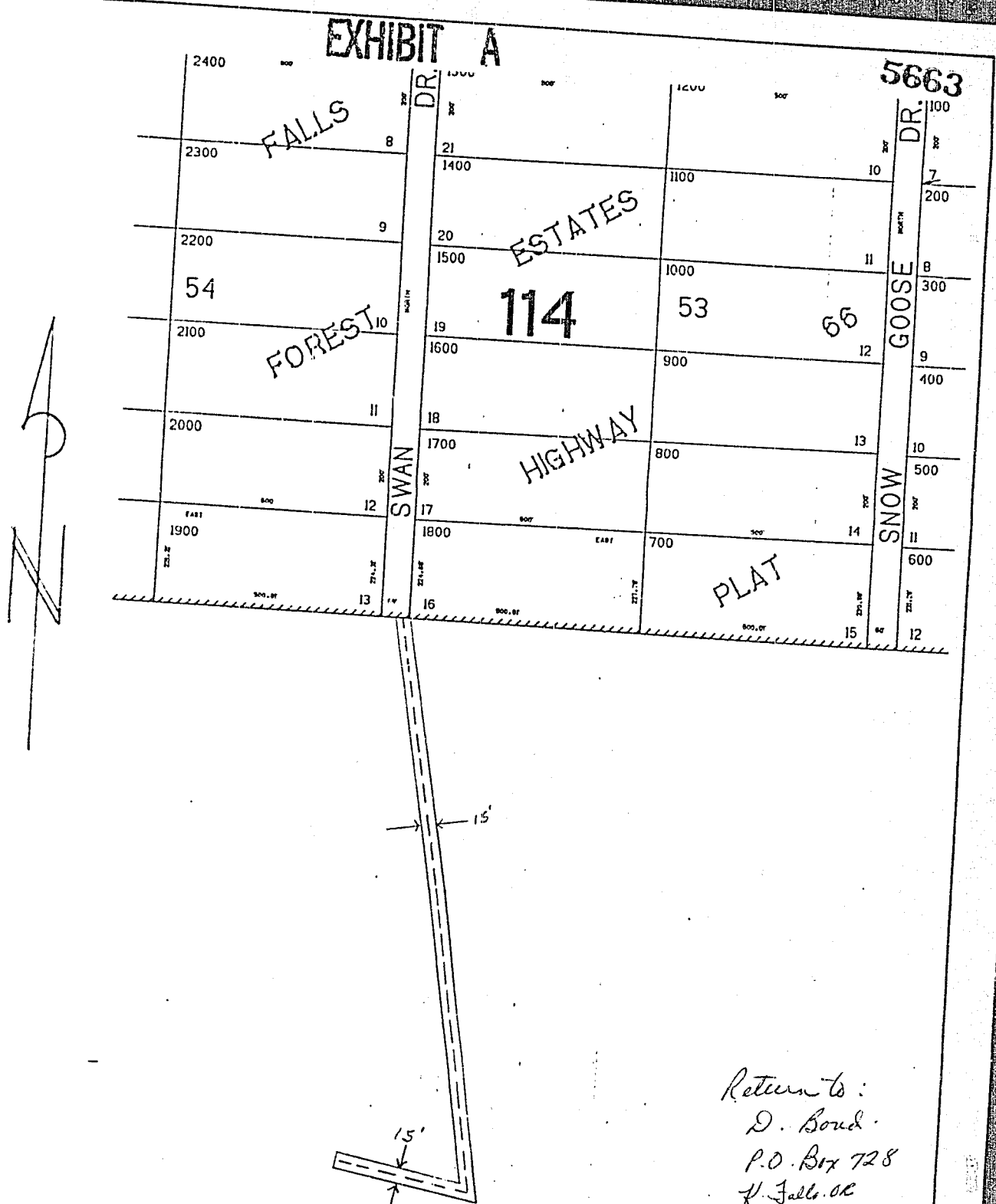

Return to:
D. Bond
P.O. Box 728
H. Falls, OR

LOCATED TO THE SW 1/4 OF THE NW 1/4 OF SEC. 23, T38N, R11E, W1W

DISTRICT <u>KLAMATH FALLS</u>		
NAME <u>CARL STALLINGS</u>	FILE NO.	
LOCATION <u>SWAN DR. (KFFE)</u>	E R NO.	<u>136-31-700</u>
MAP NO. <u>E-125-G-C</u>	W.O.	<u>4681</u>
DRAWN _____	19 _____	

PACIFIC POWER & LIGHT COMPANY
E R SKETCH
SCALE 1" = 5'
FORM 2705-A/74

STATE OF OREGON: COUNTY OF KLAMATH: ss.
Filed for record at request of Pacific Power & Light
of April A.D., 19 88 at 10:25 o'clock A M., and duly recorded in Vol. M88
of Deeds on Page 5662
By Evelyn Eiehn County Clerk
Bernetha D. Helock

FEE \$10.00