

# RIGHT-OF-WAY EASEMENT (Individual)

For value received the undersigned, hereinafter referred to as Grantors, (whether singular or plural), do hereby grant to PACIFIC POWER & LIGHT COMPANY, a corporation, its successors and assigns, the Grantee, an easement or right-of-way 10 feet in width for an electric transmission and distribution line of one or more wires and all necessary or desirable appurtenances (including telephone and telegraph wires, towers, poles, props, guys, anchors and other supports and the right to place all or any part of such line underground and the right to place such guys and anchors outside of said right-of-way), the centerline of which is at or near the location and along the general course now located and staked out by the Grantee over, across and upon the following described real property in Klamath County, State of Oregon, to wit:

A portion of the Southeast Quarter (SE $\frac{1}{4}$ ) of the Northeast Quarter (NE $\frac{1}{4}$ ) of Section 3, Township 40 South, Range 13 East of the Willamette Meridian

the location and course of said right-of-way are approximately as shown on the sketch attached as Exhibit "A" and by this reference made a part hereof.

Including the right to clear said right-of-way and keep the same clear of brush, trees, timber and structures, and the right to top, trim, clear or cut away all trees outside of said right-of-way which might endanger such line.

Together with the right of ingress and egress over the adjacent lands of the Grantors for the purpose of constructing, reconstructing, string new wires on, maintaining and removing such line and appurtenances, and exercising other rights hereby granted.

At no time shall any building or anything flammable be erected, permitted or placed within the boundaries of said right-of-way, nor shall any material or equipment of any kind or nature which exceeds \_\_\_\_\_ feet in height be used thereon by Grantors, or by Grantors' heirs or assigns.

Grantors reserve the right to use said right-of-way for roads, agricultural crops or other purposes not inconsistent with the easement granted hereby, but in using or operating any irrigation pipes, motorized vehicles or other equipment, or in any other such use of said right-of-way, Grantors and Grantors' heirs or assigns, shall conform strictly to the provisions of any then applicable safety code or regulation pertaining to required clearances from the wires or conductors of such line.

All rights hereunder shall cease if and when such line shall have been abandoned.

Dated this 17th day of JANUARY, 1989.

Raymond Richard Barrett (SEAL)  
Raymond Richard Barrett

Marlyn K. Barrett (SEAL)  
Marlyn K. Barrett

STATE OF OREGON

County of KLAMATH

ss.

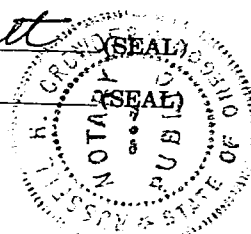

On this 17th day of JANUARY, 1989, personally appeared before me a notary public in and for said State, the within named RAYMOND RICHARD BARRETT and MARLYN K. BARRETT to me known to be the identical persons described therein and who executed the foregoing instrument, and acknowledged to me that THEY executed the same freely and voluntarily for the uses and purposes therein mentioned.

IN WITNESS WHEREOF, I have hereunto set my hand and official seal the day and year above written.

Russell W. Crowder  
Notary Public for OREGON  
Residing at KLAMATH FALLS  
My commission expires: 8-21-90

89 JAN 19 AM 9 50

PACIFIC POWER &amp; LIGHT COMPANY

OWNER \_\_\_\_\_

E.R./W.O. \_\_\_\_\_

SEC. \_\_\_\_\_ T. \_\_\_\_\_ R. \_\_\_\_\_ W.M. \_\_\_\_\_

MAP \_\_\_\_\_

COUNTY, OREGON

SCALE \_\_\_\_\_

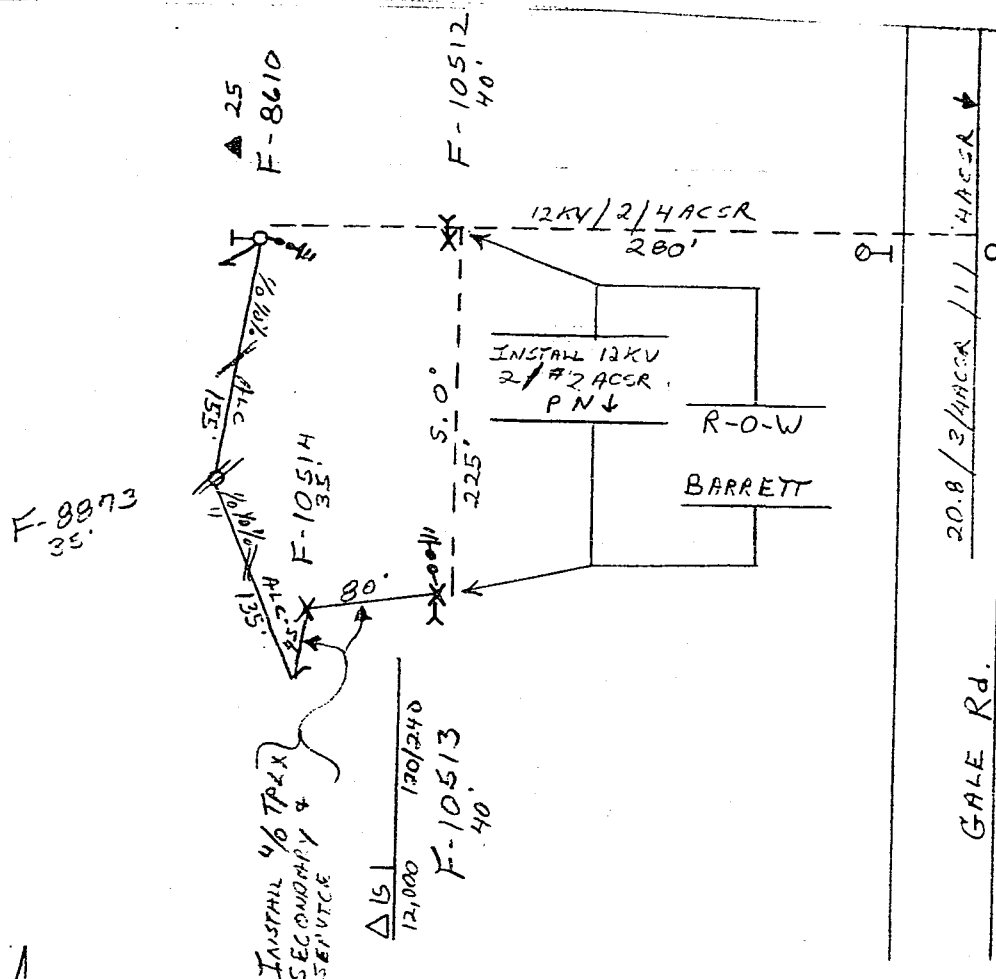

DISTRICT Klamath Falls

NAME PP&amp;L - BARRETT

FILE NO.

LOCATION GALE Rd.

ER NO.

MAP NO. F-136-2

W.O.

DRAWN

19

5239

PACIFIC POWER &amp; LIGHT COMPANY

E R SKETCH

SCALE 1" = 100'

FORM 2705-4/74

STATE OF OREGON: COUNTY OF KLAMATH: SS.

Filed for record at request of \_\_\_\_\_ Pacific Power & Light \_\_\_\_\_ the \_\_\_\_\_ 19th \_\_\_\_\_ day  
 of \_\_\_\_\_ Jan. \_\_\_\_\_ A.D., 1989 at 9:50 o'clock \_\_\_\_\_ A.M., and duly recorded in Vol. M89  
 of \_\_\_\_\_ Deeds \_\_\_\_\_ on Page 1127.

FEE \$13.00

Return: D. Bond

P.O. Box 728, Klamath Falls, Or. 97601

Evelyn Brehm

County Clerk

By Pauline Mullendore