

256

Vol. 5789 Page 8509

RIGHT-OF-WAY EASEMENT  
(Corporate)

For value received, Union High School District School District  
No. 2, Klamath County, Oregon, hereinafter referred to  
as Grantor, does hereby grant to PACIFIC POWER & LIGHT COMPANY, a corporation, its  
successors and assigns, the Grantee, an easement or right-of-way for an electric  
transmission and distribution line of one or more wires and all necessary or desirable  
appurtenances (including telephone and telegraph wires, towers, poles, props, guys,  
anchors and other supports and the right to place all or any part of such line  
underground) at or near the location and along the general course now located and  
staked out by the Grantee over, across and upon the following described real property  
in Klamath County, State of Oregon, to wit:

A portion of the NW $\frac{1}{4}$  NW $\frac{1}{4}$  of Section 11, Township 39 South, Range 9 East, W.M.  
and the SW $\frac{1}{4}$  SW $\frac{1}{4}$  of Section 2, Township 39 South, Range 9 East, W.M.

The location and course of said right-of-way are approximately as shown on the  
sketch attached as Exhibit "A" and by this reference made a part hereof.

Together with the right of ingress and egress over the adjacent lands of the  
Grantor for the purpose of constructing, reconstructing, stringing new wires on,  
maintaining and removing such line and appurtenances, and exercising other rights  
hereby granted.

Grantor reserves the right to use said right-of-way for roads, agricultural  
crops or other purposes not inconsistent with the easement granted hereby, but in  
using or operating any irrigation pipes, motorized vehicles or other equipment, or  
in any other such use of said right-of-way, Grantor (including its successors or  
assigns) shall conform strictly to the provisions of any then applicable safety  
code or regulations pertaining to required clearances from the wires or conductors  
of such line.

All rights hereunder shall cease if and when such line shall have been abandoned.

STATE OF Oregon

COUNTY OF Klamath

Dated this 11th day of May, 1989.

By: Earl E. Ferguson (Title)  
Superintendent

Attest: Robert J. Pratt (Title)  
Assistant Superintendent

On this 11th day of May, 1989, before me personally  
appeared Earl E. Ferguson, to me personally known to  
be the Superintendent of the Union High School  
School District No. 2 that executed the within and fore-  
going instrument; who duly sworn, on oath did say: that he is the  
Superintendent of the Union High School  
School District No. 2 who executed the within foregoing instrument in behalf  
of the Union High School School District  
No. 2 by authority of its Board of Directors, and he acknowledged said  
instrument to be the free act and deed of said Union High School  
School District No. 2 for the uses and purposes  
therein mentioned.

IN WITNESS WHEREOF, I have hereunto set my hand and official seal the day  
and year above written.

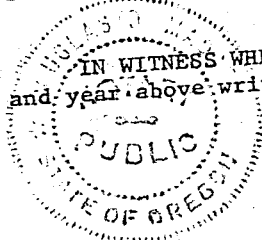

James D. Madson  
Notary Public for State of Oregon  
My commission expires: 9-13-91

8510

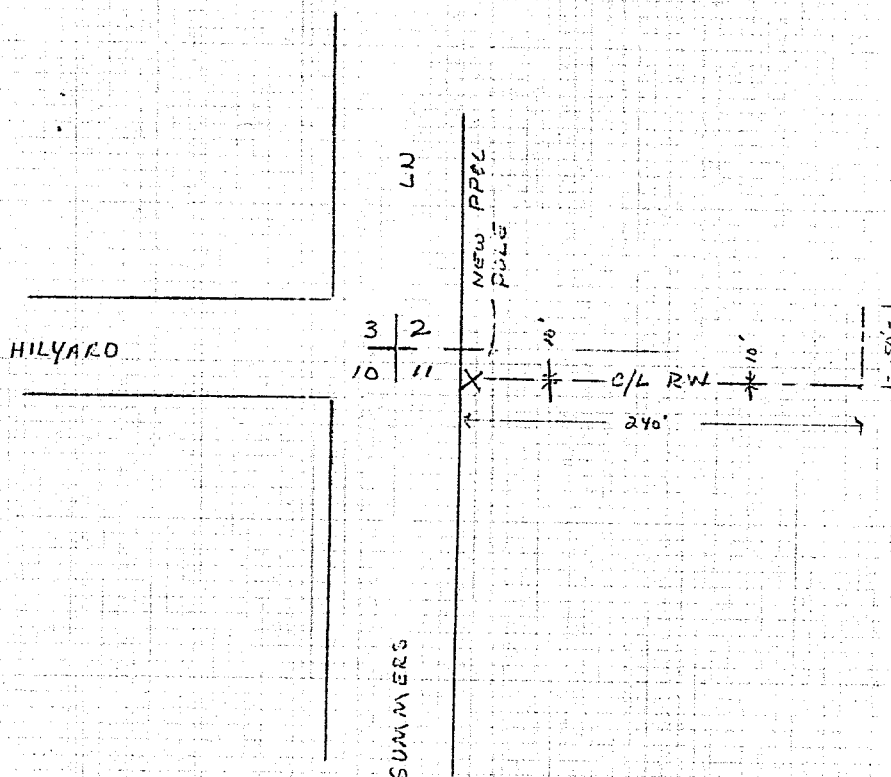

EXHIBIT A

SEND TO:

D. BOND

P. O. BOX 728

KLAMATH FALLS, OR 97601

DISTRICT <u>KLAMATH FALLS</u>		
NAME _____	FILE NO.	<u>5585</u>
LOCATION _____	ER NO.	<u>31-710</u>
MAP NO. _____	W.O.	<u>5585</u>
DRAWN _____ 19__		

PACIFIC POWER &amp; LIGHT COMPANY

E R SKETCH

SCALE 1" = 100'

FORM 2708-4/74

STATE OF OREGON: COUNTY OF KLAMATH: ss.

Filed for record at request of PP&L the 16th day  
 of May A.D., 19 89 at 2:15 o'clock P.M., and duly recorded in Vol. M89,  
 of Deeds on Page 8509.

FEE \$13.00

Evelyn Biehn, County Clerk

By Carol Miller