

6598

File No. 136-5910

ER/WO No. 31-700

5910

Vol. m89 Page 19850RIGHT-OF-WAY EASEMENT
(Corporate)

For value received, Klamath County School District No. , Klamath County, Oregon, hereinafter referred to as Grantor, does hereby grant to PACIFIC POWER & LIGHT COMPANY, a corporation, its successors and assigns, the Grantee, an easement or right-of-way for an electric transmission and distribution line of one or more wires and all necessary or desirable appurtenances (including telephone and telegraph wires, towers, poles, props, guys, anchors and other supports and the right to place all or any part of such line underground) at or near the location and along the general course now located and staked out by the Grantee over, across and upon the following described real property in Klamath County, State of Oregon, to wit:

Said property situated in the West Half of the Northeast Quarter of Section 3, Township 35 South, Range 7 East, Willamette Meridian.

Said right-of-way to be 20 feet in width, 10 feet each side of centerline.

The location and course of said right-of-way are approximately as shown on the sketch attached as Exhibit "A" and by this reference made a part hereof.

Together with the right of ingress and egress over the adjacent lands of the Grantor for the purpose of constructing, reconstructing, stringing new wires on, maintaining and removing such line and appurtenances, and exercising other rights hereby granted.

Grantor reserves the right to use said right-of-way for roads, agricultural crops or other purposes not inconsistent with the easement granted hereby, but in using or operating any irrigation pipes, motorized vehicles or other equipment, or in any other such use of said right-of-way, Grantor (including its successors or assigns) shall conform strictly to the provisions of any then applicable safety code or regulations pertaining to required clearances from the wires or conductors of such line.

All rights hereunder shall cease if and when such line shall have been abandoned.

Dated this 29 day of September, 1989.

By: Henry Sussman Business Manager
(Title)

Attest: Colleen Barker, Secretary
(Title)

17 2 PM 18 OCT 89

STATE OF OregonCOUNTY OF Klamath

On this 29 day of September, 19 89, before me personally appeared Gary Simmonds, to me personally known to be the Business Manager, of the Klamath County School District No. 600 that executed the within and foregoing instrument; who duly sworn, on oath did say: that he is the Business Manager of the Klamath County School District No. 600 who executed the within foregoing instrument in behalf of the Klamath County School District No. 600 by authority of its Board of Directors, and he acknowledged said instrument to be the free act and deed of said Klamath County School District No. 600 for the uses and purposes therein mentioned.

IN WITNESS WHEREOF, I have hereunto set my hand and official seal the day and year above written.

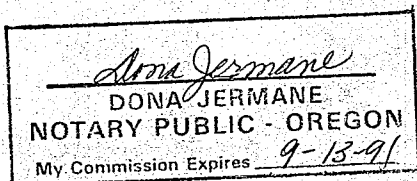

Dona Jermene
Notary Public for Oregon
My commission expires: 9-13-91

19852

OWNER Klamath County School District

E.R./W.O. 136-31-700-5910

W $\frac{1}{2}$ NE $\frac{1}{4}$ SEC. 3, T. 35 S., R. 7 E., W.M.

MAP. A-46-2-A-1

KLAMATH COUNTY, OREGON

SCALE None

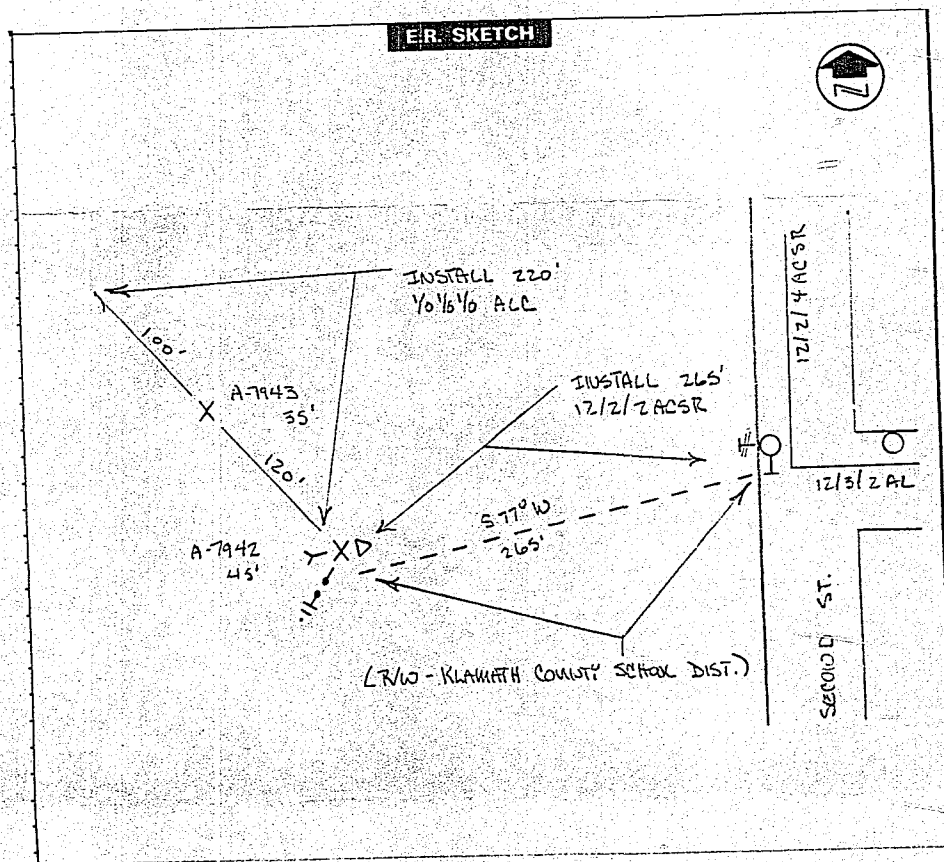

SEND TO:
D. BOND
P. O. BOX 728
KLAMATH FALLS, OR 97601

STATE OF OREGON, ss.
County of Klamath

Filed for record at request of:

Pacific Power & Light

on this 18th day of Oct. A.D., 19 89
at 2:17 o'clock PM. and duly recorded
in Vol. M89 of Deeds Page 19850.

Vol. _____ County Clerk
By Evelyn Biehn
Pauline Muelendorfer Deputy.

Fee, \$18.00