

File No. 41360-6374  
ER No. 41360-300-611  
WO No. 6374

16767

# UNDERGROUND RIGHT-OF-WAY EASEMENT (Individual)

For value received, the undersigned, (Grantor), (whether singular or plural), do hereby grant to PacificCorp, a corporation doing business as Pacific Power & Light Company, its successors and assigns, (Grantee), an easement or right-of-way, 10 feet in width, for an electric underground distribution line of one or more conductors and all necessary or desirable appurtenances (including but not limited to the right to install conduits, surface or subsurface mounted transformers, surface mounted connection boxes and meter cabinets) over, under, across and along the following described real property in Klamath County, State of Oregon, to wit:

A portion of The West Half of The Northwest Quarter of Section 33 of Township 39 South, Range 3 East, Willamette Meridian

the location and course of said right-of-way are approximately as shown on the sketch attached as Exhibit(s) A and by this reference made a part hereof.

Together with the right of ingress and egress over the adjacent lands of the Grantor in order to install, maintain, repair, replace, rebuild, operate and patrol the underground electric power lines and appurtenances, and to exercise all other rights herein granted.

Grantor shall have the right to use the lands subject to the above-described easement for all purposes not inconsistent with the uses and purposes herein set forth; provided that Grantor shall not build or erect any structure upon the right-of-way without the prior written consent of Grantee.

All rights hereunder shall cease if and when such line shall have been abandoned.

Dated this 4<sup>th</sup> day of June, 19 90.

Douglas R. Everett  
Douglas R. Everett

(SEAL)

Sheree Everett  
Sheree Everett

(SEAL)

(SEAL)

(SEAL)

STATE OF \_\_\_\_\_

County of \_\_\_\_\_

On this 4<sup>th</sup> day of June, 19 90, personally appeared before me a notary public in and for said State, the within named Doug Everett to me known to be the identical person described therein and who executed the foregoing instrument, and acknowledged to me that he executed the same freely and voluntarily for the uses and purposes therein mentioned.

IN WITNESS WHEREOF, I have hereunto set my hand and official seal the day and year above written.

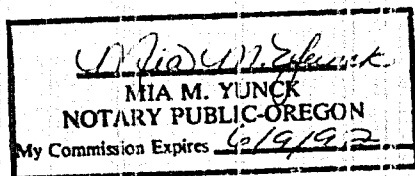

Notary Public for Oregon  
Residing at 13378 Olia Ln  
My commission expires: 6/9/92

'90 JUN 27 AM 10 07

STEVENS  
15084  
NOTARY PUBLIC  
CLERK OF DISTRICT COURT  
CLERK OF DISTRICT COURT  
CLERK OF DISTRICT COURT

12578

NOTARY PUBLIC  
STATE OF OREGON

STATE OF OREGON,

County of Klamath

SS.

FORM NO. 23 — ACKNOWLEDGMENT  
STEVENS-NESS LAW PUB. CO., PORTLAND, ORE.

BE IT REMEMBERED, That on this 4 day of June, 1990,  
before me, the undersigned, a Notary Public in and for said County and State, personally appeared the within  
named Sheree Everett

known to me to be the identical individual described in and who executed the within instrument and  
acknowledged to me that She executed the same freely and voluntarily.

IN TESTIMONY WHEREOF, I have hereunto set my hand and affixed  
my official seal the day and year last above written.

Mia M. Yunk  
Notary Public for Oregon  
My Commission expires 10/9/90  
NOTARY PUBLIC-OREGON  
My Commission Expires 10/9/90

SEND TO:

D. BOND

P. O. BOX 728

KLAMATH FALLS, OR 97601

NOTARY PUBLIC  
STATE OF OREGON

12579

## EXHIBIT-A

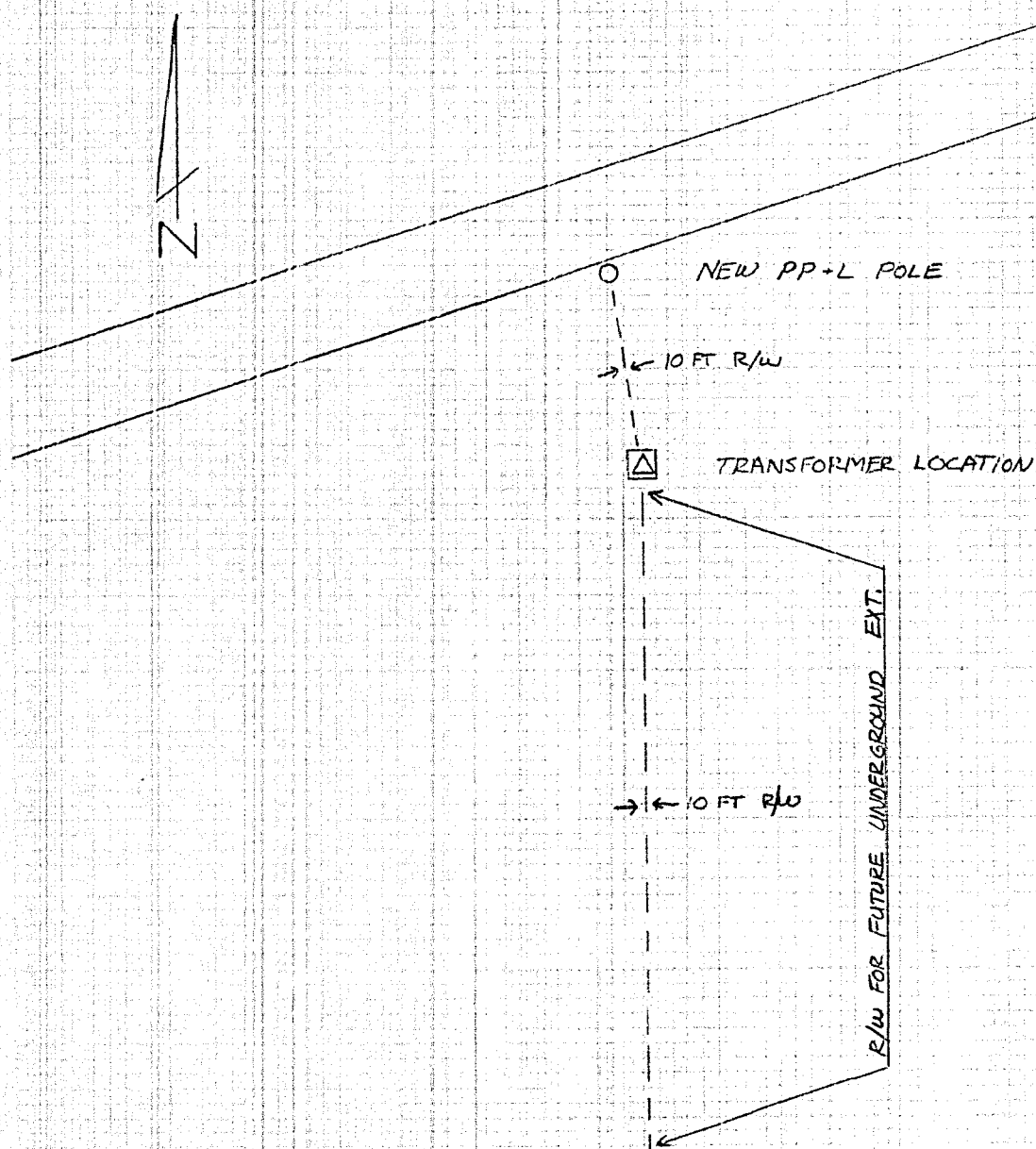

|                              |           |                   |  |
|------------------------------|-----------|-------------------|--|
| DISTRICT <u>KLAMATH</u>      |           |                   |  |
| NAME <u>DOUG EVERETT</u>     | FILE NO.  | <u>11360-6374</u> |  |
| LOCATION <u>11532 HWY 66</u> | ER NO.    | <u>300-611</u>    |  |
| MAP NO. <u>C-50-8-C</u>      | WO        | <u>6374</u>       |  |
| DRAWN <u>MAY 22</u>          | <u>90</u> |                   |  |

PACIFIC POWER &amp; LIGHT COMPANY

E R SKETCH

SCALE 1 - 100

FORM 2705-A 74

STATE OF OREGON: COUNTY OF KLAMATH: 55.

Filed for record at request of Pacific Power & Light the 27th day  
 of June A.D., 19 90 at 10:07 o'clock AM., and duly recorded in Vol. M90,  
 of Deeds on Page 12577.

Evelyn Biehn, County Clerk

By Douglas Miller

FEE \$18.00