

19714

Vol. m 90 Page 12743

Pacific Power  
920 S.W. Sixth Avenue  
Portland, Oregon 97204

File No. 41360-6395  
ER No. 41360-300-642  
WO No. 6395

Act:

Pacific Power  
P.O. Box 728  
Klamath Falls, Or 97601

UNDERGROUND  
RIGHT-OF-WAY EASEMENT  
(Individual)

For value received the undersigned, (Grantor), (whether singular or plural), do hereby grant to PACIFICORP, a Corporation, dba Pacific Power & Light Company, its successors and assigns, (Grantee), an easement or right-of-way, 10 feet in width, for an electric underground distribution line of one or more conductors and all necessary or desirable appurtenances (including but not limited to the right to install conduits, surface or sub-surface mounted transformers, surface mounted connection boxes and meter cabinets) over, under, across and along the following described real property in Klamath County, State of Oregon, to wit:

Said property situated in The Southwest Quarter of The Northwest Quarter of Section 24, Township 36 South, Range 12 East, Willamette Meridian

the location and course of said right-of-way are approximately as shown on the sketch attached as Exhibit(s) "A" and by this reference made a part hereof.

Together with the right of ingress and egress over the adjacent lands of Grantor in order to install, maintain, repair, replace, rebuild, operate and patrol the underground electric power lines and appurtenances, and to exercise all other rights herein granted.

Grantor shall have the right to use the lands subject to the above-described easement for all purposes not inconsistent with the uses and purposes herein set forth; provided that Grantor shall not build or erect any structure upon the right-of-way without the prior written consent of Grantee.

All rights hereunder shall cease if and when such line shall have been abandoned.

Form 2768 (Rev. 9/85)

Dated this 20 day of July, 19 90.

Ferris M. Stotler (SEAL)

(SEAL)

(SEAL)

Howard Thompson (SEAL)

(SEAL)

Edward D. Landels

(SEAL)

STATE OF Oregon

County of Klamath

STATE OF OREGON, )  
 ) SS.  
COUNTY OF Klamath )

BE IT REMEMBERED, That on this 30th day of July, 19 90,  
before me, the undersigned, a Notary Public in and for said County and State, personally appeared the within named  
Ferris M. Stotler

known to me to be the identical individual described in and who executed the within instrument and acknowledged to  
me that she executed the same freely and voluntarily.

IN TESTIMONY WHEREOF, I have hereunto set my hand and affixed my official seal the day and year last above written

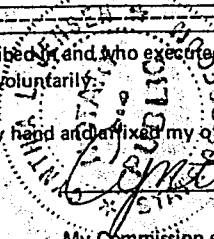

Cynthia Jensen  
Notary Public for Oregon.  
3-25-93  
My Commission expires

To Whom it may Concern:

Mr. Edward Landels signature is no longer necessary  
as he transferred/conveyed his interest in the property  
to me, Ferris May Stotler on the 30th Oct. 1989.

Vol. m 89. page 20768, County Court House, Klamath  
Falls, Oregon. County clerk Pauline Mullender.

Sincerely,

Ferris May Stotler

Form 2768 (Rev. 9/85)

STATE OF OREGON, )  
 ) SS.  
COUNTY OF Klamath )

BE IT REMEMBERED, That on this 2nd day of August, 19 90,  
before me, the undersigned, a Notary Public in and for said County and State, personally appeared the within named  
Howard Thompson

known to me to be the identical individual described in and who executed the within instrument and acknowledged to  
me that he executed the same freely and voluntarily.

IN TESTIMONY WHEREOF, I have hereunto set my hand and affixed my official seal the day and year last above written

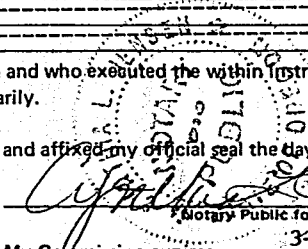

Cynthia Jensen  
Notary Public for Oregon.  
3-25-93  
My Commission expires

# EXHIBIT A

17745

PACIFIC POWER & LIGHT COMPANY

OWNER Stotler/Landels/Thompson

E.R./W.O. 41360-300-642-6395

SW $\frac{1}{4}$ , NW $\frac{1}{4}$  SEC. 24, T. 36S, R. 12E, W.M.

MAP B-132-6

KLAMATH COUNTY, OREGON

SCALE 1" = 100'

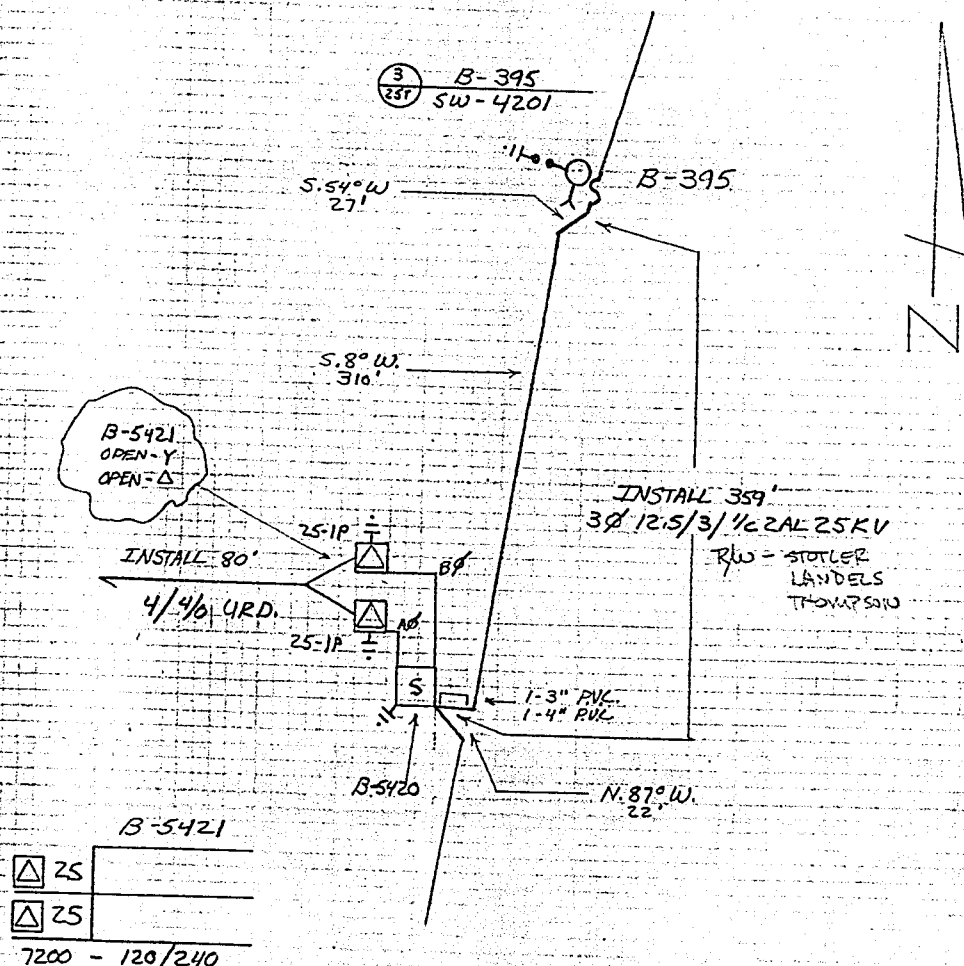

DISTRICT <u>KLAMATH</u>	
NAME <u>FERRIS STOTLER</u>	FILE NO.
LOCATION <u>BEATTY</u>	ER NO. <u>300-642</u>
MAP NO. <u>B-132-6</u>	W.O. <u>6395</u>
DRAWN <u>JUNE 8</u> 19 <u>90</u>	

PACIFIC POWER & LIGHT COMPANY

E R SKETCH

SCALE 1" = 100'

FORM 2705-6/74

STATE OF OREGON: COUNTY OF KLAMATH: ss.

Filed for record at request of Pacific Power & Light the 5th day of Sept. A.D., 19 90 at 11:26 o'clock A M., and duly recorded in Vol. M90 of Deeds on Page 17743

FEE \$18.00

Evelyn Biehn - County Clerk

By Pauline Mulhadow