

31507

Vol. m 91 Page 12779

ROAD EASEMENT

OREGON, CALIFORNIA & EASTERN RAILWAY COMPANY, a Nevada corporation, "Grantor," for One Dollar (\$1.00), receipt of which is hereby acknowledged, hereby grants and conveys to WEYERHAEUSER COMPANY, a Washington corporation, "Grantee," the perpetual nonexclusive right to reconstruct, use and maintain, for all road purposes, the existing truck road upon, over and along Grantor's railroad right of way located over and across the following described lands in Klamath County, Oregon:

<u>Description</u>	<u>Sec-Twp-Rge. W.M.</u>
N $\frac{1}{2}$ SE $\frac{1}{4}$	13-36S-12E
SW $\frac{1}{4}$ NW $\frac{1}{4}$, N $\frac{1}{2}$ SW $\frac{1}{4}$, NW $\frac{1}{4}$ SE $\frac{1}{4}$, S $\frac{1}{2}$ SE $\frac{1}{4}$	18-36S-13E

said road being located approximately as shown on the attached Exhibit A.

Dated this 1st day of July, 1991.

OREGON, CALIFORNIA & EASTERN
RAILWAY COMPANY

By: D. C. Williams
Its: President

STATE OF OREGON)
) ss.
COUNTY OF KLAMATH)

This instrument was acknowledged before me on July 1, 1991 by D. C. Williams as President of OREGON, CALIFORNIA & EASTERN RAILWAY COMPANY.

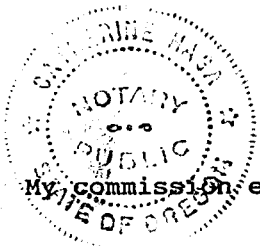

Catherine Haga
Notary Public

My commission expires: April 4, 1992

91 JUL 2 PM 12 55

Return: Weyerhaeuser Co.

Attn: John Monfore

P.O. Box 9

Klamath Falls, Or. 97601

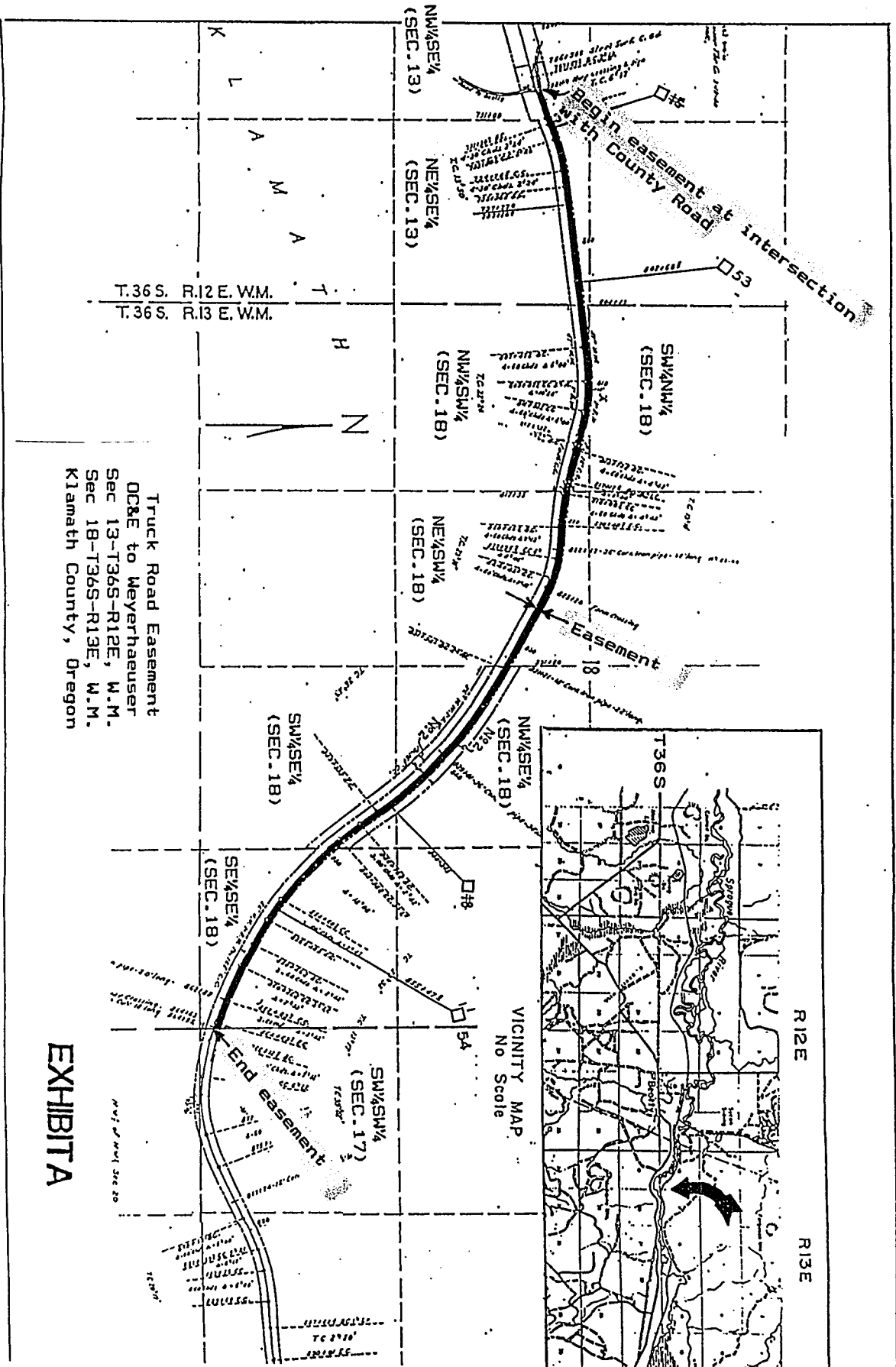

Filed for record at request of Weyerhaeuser Co. the 3rd day of July A.D., 19 91 at 12:55 o'clock P.M., and duly recorded in Vol. M91 of Deeds on Page 12779.

FEE \$33.00

Evelyn Biehn County Clerk

By D. A. Anderson