

File No. _____
ER No. 41360-300-611
WO No. 7119

31661

RIGHT-OF-WAY EASEMENT
(Individual)

For value received, the undersigned, hereinafter referred to as Grantors, (whether singular or plural), do hereby grant to PacificCorp, a corporation doing business as Pacific Power & Light Company, its successors and assigns, the Grantee, an easement or right-of-way for an electric transmission and distribution line of one or more wires and all necessary or desirable appurtenances (including telephone and telegraph wires, towers, poles, props, guys, anchors and other supports and the right to place all or any part of such line underground) at or near the location and along the general course now located and staked out by the Grantee over, across and upon the following described real property in _____ County, State of Oregon, to wit:

A portion of Government Lot 1 in Section 15, Township 41 South, Range 7 East, Willamette Meridian.

Said right-of-way to be 20 feet in width, 10 feet each side of centerline.

The location and course of said right-of-way are approximately as shown on the sketch attached as Exhibit(s) A and by this reference made a part hereof.

Including the right to clear said right-of-way and keep the same clear of brush, trees, timber and structures, and the right to top, trim, clear or cut away all trees outside of said right-of-way which might endanger such line.

Together with the right of ingress and egress over the adjacent lands of the Grantors for the purpose of constructing, reconstructing, stringing new wires on, maintaining and removing such line and appurtenances, and exercising other rights hereby granted.

Grantors reserve the right to use said right-of-way for roads, agricultural crops or other purposes not inconsistent with the easement granted hereby, but in using or operating any irrigation pipes, motorized vehicles or other equipment, or in any other such use of said right-of-way, Grantors and Grantors' heirs or assigns, shall conform strictly to the provisions of any then applicable safety code or regulation pertaining to required clearances from the wires or conductors of such line.

All rights hereunder shall cease if and when such line shall have been abandoned.

Dated this 27 day of June, 1991.

[Signature] (SEAL) _____
Catherine D. Faivre (SEAL) _____

STATE OF California } ss.
County of Siskiyou }

On this 27th day of June, 1991, personally appeared before me a notary public in and for said State, the within named Richard Faivre and Catherine D. Faivre

to me known to be the identical person s described therein and who executed the foregoing instrument, and acknowledged to me that they executed the same freely and voluntarily for the uses and purposes therein mentioned.

IN WITNESS WHEREOF, I have hereunto set my hand and official seal the day and year above written.

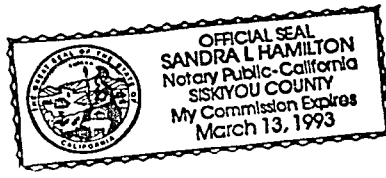

[Signature]
Notary Public for Timberline Community Bank
Residing at 3rd and California Streets, Dorris, Ca.
My commission expires: March 13, 1993

13228

EXHIBIT "A"

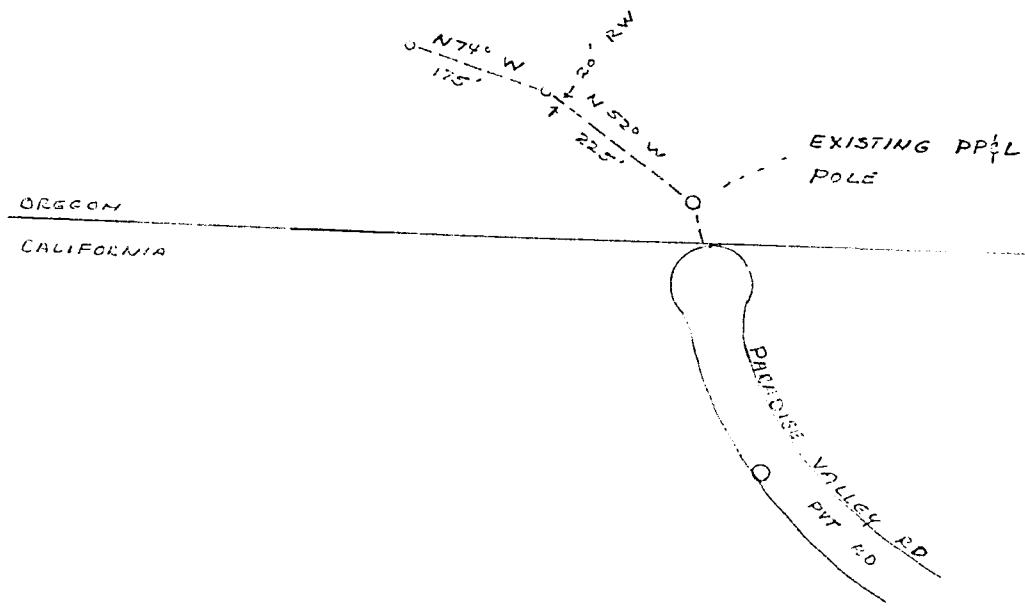

DISTRICT <u>KLAMATH</u>	
NAME _____	41360 - 7119
LOCATION _____	ER NO 300-01
MAP TO _____	WO 7119
DRAWN _____ 19 _____	

PACIFIC POWER & LIGHT COMPANY
E R SKETCH

SCALE 1" = 200'

STATE OF OREGON: COUNTY OF KLAMATH: SS.

Filed for record at request of _____ PP&L
of _____ July _____ A.D., 19 91 at 11:33 o'clock _____ A.M., and duly recorded in Vol. _____ M91
of _____ Deeds _____ on Page 13227.

FEE \$13.00

Return: D. Morrison
P.O. Box 728, Klamath Falls, Or. 97601

Evelyn Biehn County Clerk
By Paulene Mullendore