

40460

Vol. 92 Page 2049

PACIFIC POWER

RC Name Klamath Falls

Return To:

D. Morrison
P.O. Box 728
Klamath Falls, Or. 97601

RC 41360 WO 6700

**RIGHT-OF-WAY EASEMENT
(Individual)**

For value received the undersigned, (Grantor), (whether singular or plural), does hereby grant to PACIFICORP, a corporation, dba Pacific Power & Light Company, its successors and assigns, (Grantee), an easement and right-of-way, fifteen (15) feet in width, for an underground electric distribution line of one or more conductors and all necessary or desirable appurtenances (including but not limited to the right to install conduits, surface or subsurface mounted transformers, surface mounted connection boxes and meter cabinets) over, under, across and along the following described real property in Klamath County, State of Oregon, to wit:

Said property generally situated in The Southwest Quarter (SW $\frac{1}{4}$) of The Northwest Quarter (NW $\frac{1}{4}$) of Section 22, Township 33 South, Range 7 $\frac{1}{2}$ East, Willamette Meridian.

The location and course of said easement and right-of-way are approximately as shown on the sketch attached as Exhibit(s) "A" and by this reference made a part hereof.

Together with the right of ingress and egress over the adjacent lands of the Grantor in order to install, maintain, repair, replace, rebuild, operate and patrol the underground electric power lines and appurtenances, and to exercise all other rights herein granted.

Grantor shall have the right to use the lands subject to the above described easement and right-of-way for all purposes not inconsistent with the uses and purposes herein set forth; provided that Grantor shall not build or erect any structure upon said easement and right-of-way without the prior written consent of Grantee.

All rights hereunder shall cease if and when such line shall have been abandoned.

24
10
24

Dated this 10th day of January, 1992

2050

Leonore McAuliffe (SEAL)
Leonore McAuliffe (SEAL)

(SEAL) (SEAL)

STATE OF California
County of Shasta

On this 10th day of January, 1992,
personally appeared before me a notary public in and for said
State, the within named
Leonore McAuliffe

to me known to be the identical person _____ described therein and
who executed the foregoing instrument, and acknowledged to me that
she executed the same freely and voluntarily for the uses
and purposes therein mentioned.

IN WITNESS WHEREOF, I have hereunto set my hand and
official seal the day and year above written.

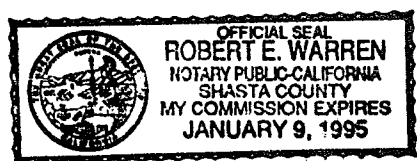

Robert E. Warren

Notary Public for Shasta County

Residing at Anderson, CA

My Commission expires: Jan 9, 1995

EXHIBIT A

2051

PACIFIC POWER & LIGHT COMPANY

OWNER McAuliffe

E.R./W.O. 41360-300-641-6700

SW 1/4, NW 1/4 SEC. 22, T. 33S., R. 7 1/2 E., W.M.

MAP A-25-5-FK

KLAMATH COUNTY, OREGON

SCALE _____

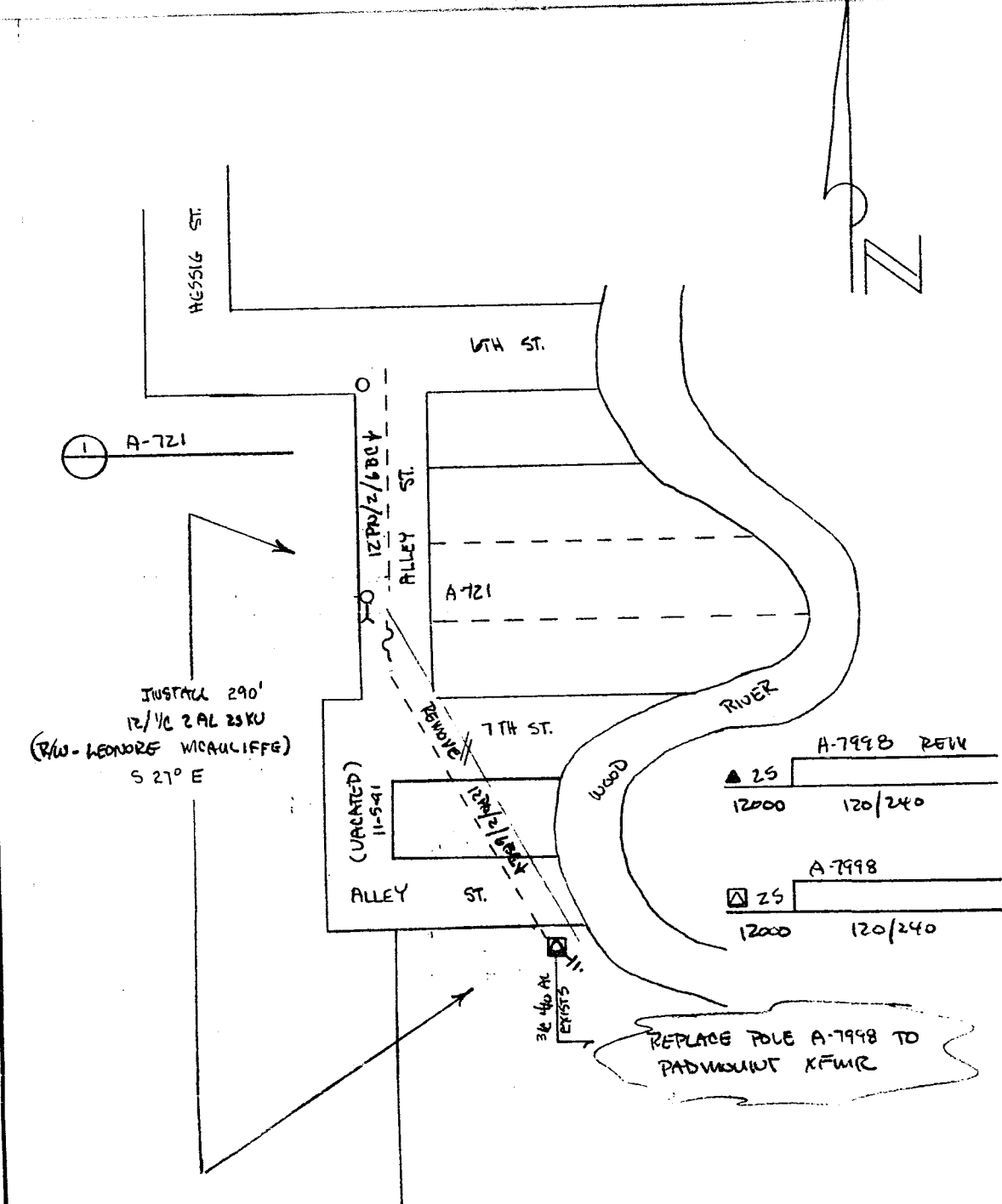

| | | | |
|------------------------------------|----------|----------------|--|
| DISTRICT <u>KLAMATH</u> | | | |
| NAME <u>MRS. JOE MCAULIFFE</u> | FILE NO. | <u>6700</u> | |
| LOCATION <u>FT. KLAMATH</u> | ER NO. | <u>300-641</u> | |
| MAP NO. <u>A-25-5-FK</u> | W.O. | <u>6700</u> | |
| DRAWN <u>MC 10-30</u> 19 <u>90</u> | | | |

PACIFIC POWER & LIGHT COMPANY
E R SKETCH

SCALE 1" = 100'

FORM 2705-4-74

STATE OF OREGON: COUNTY OF KLAMATH: ss.

Filed for record at request of PP&L the 30th day of Jan. A.D., 19 92 at 10:24 o'clock A M., and duly recorded in Vol. M92 of Deeds on Page 2049.

Evelyn Biehn, County Clerk
By [Signature]

FEE \$18.00