

52880

'92 OCT 27 AM 9 12

Vol. M92 Page 25144

PACIFIC POWER

RC: Name Klamath FallsReturn To: Pacific Power  
P.O. Box 728  
Klamath Falls, Or. 97601RC 41360 WO 7929UNDERGROUND  
RIGHT-OF-WAY EASEMENT  
(Corporate)

For value received, Stanislaus Management, Inc.,  
a California corporation, hereinafter  
referred to as Grantor, does hereby grant to PACIFICORP, a  
corporation, dba Pacific Power & Light Company, its successors and  
assigns, the Grantee, an easement and right-of-way, ten (10)  
feet in width, for an underground electric distribution line of one  
or more conductors and all necessary or desirable appurtenances  
(including but not limited to the right to install conduits,  
surface or subsurface mounted transformers, surface mounted  
connection boxes and meter cabinets) over, under, across and along  
the following described real property in Klamath County  
County, State of Oregon, to wit:

A portion of The Southwest Quarter (SW $\frac{1}{4}$ ) of The Northwest  
Quarter (NW $\frac{1}{4}$ ) of Section 21, Township 39 South, Range 9  
East, Willamette Meridian, as said property is described  
in Volume M92, page 11207, Official Records of Klamath  
County, Oregon.

The location and course of said easement and right-of-way  
are approximately as shown on the sketch attached as Exhibit(s)  
A and by this reference made a part thereof.

Together with the right of ingress and egress over the  
adjacent lands of the Grantor in order to install, maintain,  
repair, replace, rebuild, operate and patrol the underground  
electric power lines and appurtenances, and to exercise all other  
rights herein granted.

Grantor shall have the right to use the lands subject to  
the above described easement and right-of-way for all purposes not  
inconsistent with the uses and purposes herein set forth; provided  
that Grantor shall not build or erect any structure upon said  
easement and right-of-way without the prior written consent of  
Grantee.

All rights hereunder shall cease if and when such line  
shall have been abandoned.

Dated this 12<sup>th</sup> day of October, 1992

By: John J. Every  
(Title)

Attest:

W. B. Linn  
Secretary (Title)

STATE OF

California

County of

Alameda

On this 12<sup>th</sup> day of October, 1992,  
before me personally appeared JOHN J. EVERY, to me  
personally known to be the PRESIDENT  
of the corporation that executed the within and foregoing  
instrument; who, duly sworn, on oath did say that he is the  
PRESIDENT of the corporation that executed the  
within and foregoing instrument; that the seal affixed to said  
instrument is the corporate seal of said corporation, and that said  
instrument was signed and sealed in behalf of the said corporation  
by authority of its Board of Directors, and he acknowledged said  
instrument to be the free act and deed of said corporation for the  
uses and purposes therein mentioned.

IN WITNESS WHEREOF, I have hereunto set my hand and  
official seal the day and year above written.

Irene A. Linn

Notary Public for California  
Residing at Castro Valley

My Commission expires: March 12, 1993

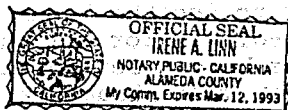

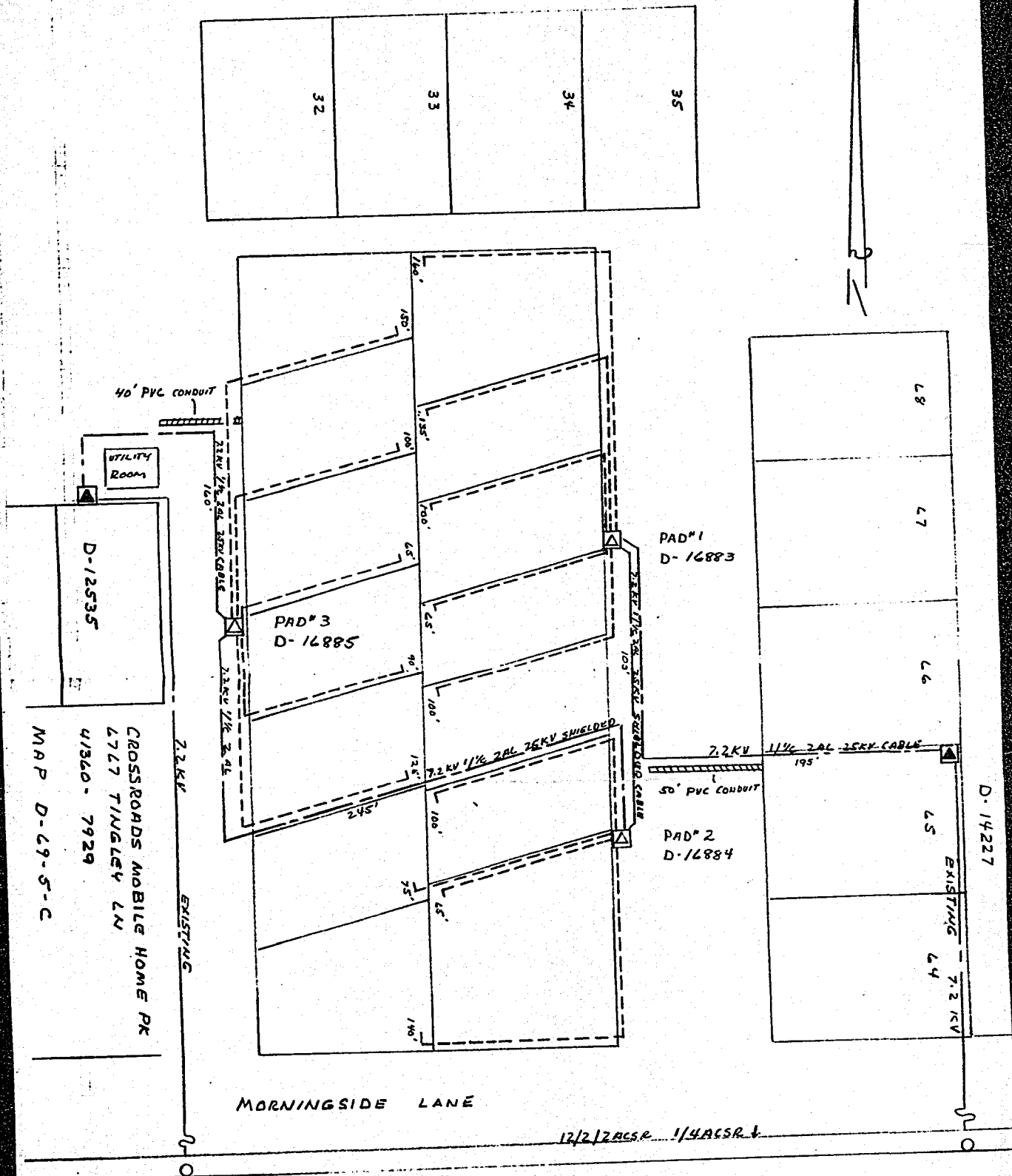

EXHIBIT "A"

STATE OF OREGON: COUNTY OF KLAMATH: ss.

Filed for record at request of \_\_\_\_\_ the 27th day  
of \_\_\_\_\_ Oct. A.D., 19 92 at 9:12 o'clock A.M., and duly recorded in Vol. M92  
of \_\_\_\_\_ Deeds on Page 25144.

FEE \$20.00

Evelyn Riehn County Clerk  
By Pauline Mulholland