

52881

'92 OCT 27 AM 9 12

Vol. m92 PageGRANTOR: Daniel G. Brown  
Eloise Brown

25147

File No.

ER No. 41360-300-611WO No. 7293

# **UNDERGROUND RIGHT-OF-WAY EASEMENT** (Individual)

For value received, the undersigned, (Grantor), (whether singular or plural), do hereby grant to PacifiCorp, a corporation doing business as Pacific Power & Light Company, its successors and assigns, (Grantee), an easement or right-of-way, ten (10) feet in width, for an electric underground distribution line of one or more conductors and all necessary or desirable appurtenances (including but not limited to the right to install conduits, surface or subsurface mounted transformers, surface mounted connection boxes and meter cabinets) over, under, across and along the following described real property in Klamath County, State of Oregon, to wit:

A portion of The East Half (E½) of The Northwest Quarter (NW¼) of Section 26, Township 34 South, Range 6 East, Willamette Meridian, as described in Book M91, page 8560, Official Records of Klamath County, Oregon.

the location and course of said right-of-way are approximately as shown on the sketch attached as Exhibit(s) "A" and by this reference made a part hereof.

Together with the right of ingress and egress over the adjacent lands of the Grantor in order to install, maintain, repair, replace, rebuild, operate and patrol the underground electric power lines and appurtenances, and to exercise all other rights herein granted.

Grantor shall have the right to use the lands subject to the above-described easement for all purposes not inconsistent with the uses and purposes herein set forth; provided that Grantor shall not build or erect any structure upon the right-of-way without the prior written consent of Grantee.

All rights hereunder shall cease if and when such line shall have been abandoned.

Dated this 8th day of October, 19 92.

(SEAL)

Daniel G. Brown

(SEAL)

Eloise Brown

Trustees of the Daniel G. Brown Trust  
and the Eloise Brown Trust

STATE OF OregonCounty of Klamath

On this 8th day of October, 19 92, personally appeared before me a notary public in and for said State, the within named Daniel G. Brown & Eloise Brown to me known to be the identical person described therein and who executed the foregoing instrument, and acknowledged to me that Daniel G. Brown & Eloise Brown executed the same freely and voluntarily for the uses and purposes therein mentioned.

IN WITNESS WHEREOF, I have hereunto set my hand and official seal the day and year above written.

Notary Public for State of OregonResiding at 4043 Valinda Klamath FallsMy commission expires: 12/15/92

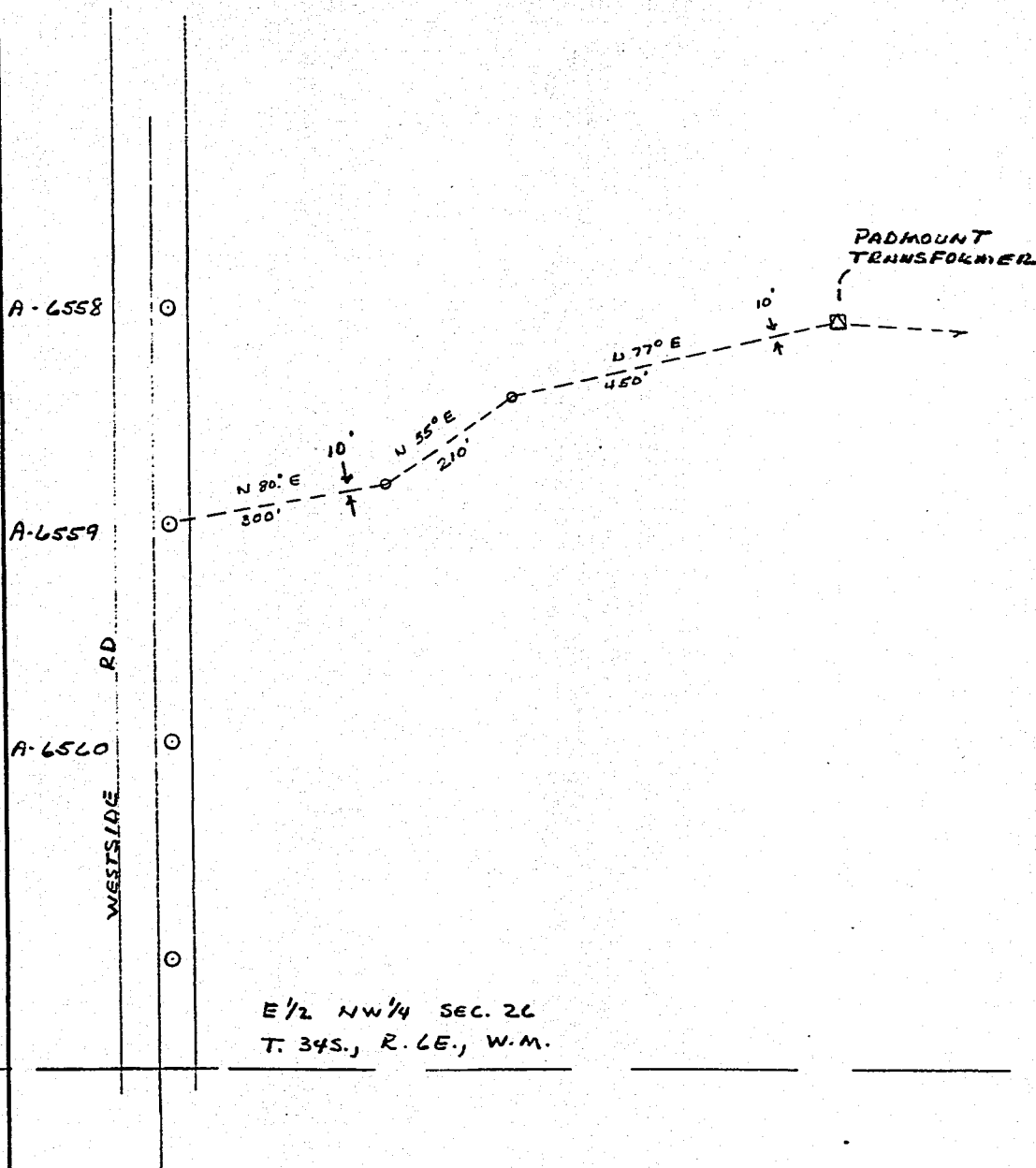

DISTRICT <u>KLAMATH FALLS</u>			
NAME _____	41360-7293		
LOCATION _____	ER NO	300-611	
MAP NO. _____	WO	7293	
DRAWN _____ 19__			

PACIFIC POWER &amp; LIGHT COMPANY

E R SKETCH

SCALE 1" = 200'

FORM 2705 REV 8/87

STATE OF OREGON: COUNTY OF KLAMATH: SS.

Filed for record at request of \_\_\_\_\_ the 27th day  
 of Oct. A.D., 19 92 at 9:12 o'clock AM., and duly recorded in Vol. M92,  
 of \_\_\_\_\_ Deeds \_\_\_\_\_ on Page 25147.

FEE \$15.00

Evelyn Biehn, County Clerk

By Pauline Mullendore