

52882

92 OCT 27 AM 9 12

Vol. 92 Page 25149

Return to: Pacific Power
P.O. Box 728
Klamath Falls, Or. 97601

GRANTOR: Daniel P. Souza

ER No. 41360-300-611
WO No. 7854

UNDERGROUND RIGHT-OF-WAY EASEMENT (Individual)

For value received, the undersigned, (Grantor), (whether singular or plural), do hereby grant to PacifiCorp, a corporation doing business as Pacific Power & Light Company, its successors and assigns, (Grantee), an easement or right-of-way, ten (10) feet in width, for an electric underground distribution line of one or more conductors and all necessary or desirable appurtenances (including but not limited to the right to install conduits, surface or subsurface mounted transformers, surface mounted connection boxes and meter cabinets) over, under, across and along the following described real property in Klamath County, State of Oregon, to wit:

Said property situated in The Northwest Quarter (NW $\frac{1}{4}$) of The Northeast Quarter (NE $\frac{1}{4}$) of Section 32, Township 39 South, Range 11 1/2 East, Willamette Meridian.

the location and course of said right-of-way are approximately as shown on the sketch attached as Exhibit(s) A and by this reference made a part hereof.

Together with the right of ingress and egress over the adjacent lands of the Grantor in order to install, maintain, repair, replace, rebuild, operate and patrol the underground electric power lines and appurtenances, and to exercise all other rights herein granted.

Grantor shall have the right to use the lands subject to the above-described easement for all purposes not inconsistent with the uses and purposes herein set forth; provided that Grantor shall not build or erect any structure upon the right-of-way without the prior written consent of Grantee.

All rights hereunder shall cease if and when such line shall have been abandoned.

Dated this 16 day of SEPT., 1992.

[Signature] (SEAL) _____ (SEAL)

(SEAL) _____ (SEAL)

STATE OF

County of

Oregon
Klamath

On this 16th day of September, 1992, personally appeared before me a notary public in and for said State, the within named DANIEL P. SOUZA to me known to be the identical person described therein and who executed the foregoing instrument, and acknowledged to me that HE executed the same freely and voluntarily for the uses and purposes therein mentioned.

IN WITNESS WHEREOF, I have hereunto set my hand and official seal the day and year above written.

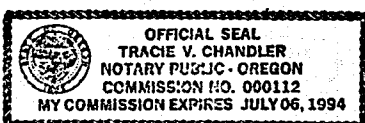

Notary Public for

Residing at

My commission expires:

[Signature]
Oregon
Klamath Falls
7-6-94

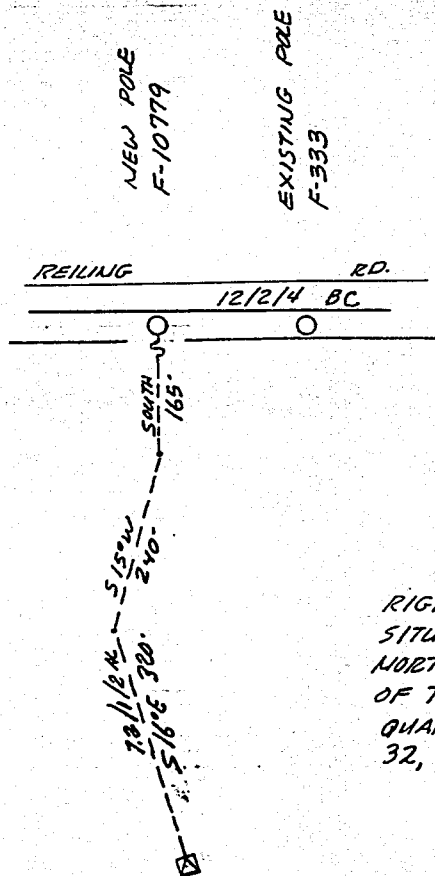

RIGHT-OF-WAY IS
SITUATED IN THE
NORTHWEST QUARTER (NW⁴)
OF THE NORTHEAST
QUARTER (NE⁴) OF SEC.
32, TS 39S, R 11¹/₂E, WM

PAD MOUNT TRANSF.
F-10880

EXHIBIT "A"

DISTRICT <u>KLAMATH</u>	
NAME <u>DAN SOUZA</u>	<u>4/1360</u>
LOCATION <u>19850 REILING RD</u>	E R NO. <u>300-61A</u>
MAP NO. <u>F-107-9</u>	W.O. <u>7854</u>
DRAWN <u>J. COX</u>	<u>6-5</u> 19 <u>92</u>

PACIFIC POWER & LIGHT COMPANY

E R SKETCH

SCALE 1"=200'

FORM 2708 REV. 8/87

STATE OF OREGON: COUNTY OF KLAMATH: ss.

Filed for record at request of _____ the _____ 27th _____ day
of _____ Oct. _____ A.D., 19 92 at 9:12 o'clock A.M., and duly recorded in Vol. _____ M92
of _____ Deeds _____ on Page 25149.

Evelyn Biehn, County Clerk

By Quintin M. Mendenhall

FEE \$15.00