

RETURN TO:
Pacific Power
PO Box 728
61524 Klamath Falls, OR

GRANTOR: Randy R. Scott
Susan J. Scott

File No.
ER No. 41360-300-611
WO No. 7886

RIGHT-OF-WAY EASEMENT
(Individual)

Vol. 93 Page 10907

For value received, the undersigned, hereinafter referred to as Grantors, (whether singular or plural), do hereby grant to PacifiCorp, a corporation doing business as Pacific Power & Light Company, its successors and assigns, the Grantee, an easement or right-of-way for an electric transmission and distribution line of one or more wires and all necessary or desirable appurtenances (including telephone and telegraph wires, towers, poles, props, guys, anchors and other supports and the right to place all or any part of such line underground) at or near the location and along the general course now located and staked out by the Grantee over, across and upon the following described real property in Klamath County, State of Oregon, to wit:

A portion of Parcel #2 of Major Land Partition #55-91, located in Section 22, Township 39 South, Range 8 East, Willamette Meridian.

Said right-of-way to be ten feet in width, five feet each side of centerline.

The location and course of said right-of-way are approximately as shown on the sketch attached as Exhibit(s) A and by this reference made a part hereof.

Including the right to clear said right-of-way and keep the same clear of brush, trees, timber and structures, and the right to top, trim, clear or cut away all trees outside of said right-of-way which might endanger such line.

Together with the right of ingress and egress over the adjacent lands of the Grantors for the purpose of constructing, reconstructing, stringing new wires on, maintaining and removing such line and appurtenances, and exercising other rights hereby granted.

Grantors reserve the right to use said right-of-way for roads, agricultural crops or other purposes not inconsistent with the easement granted hereby, but in using or operating any irrigation pipes, motorized vehicles or other equipment, or in any other such use of said right-of-way, Grantors and Grantors' heirs or assigns, shall conform strictly to the provisions of any then applicable safety code or regulation pertaining to required clearances from the wires or conductors of such line.

All rights hereunder shall cease if and when such line shall have been abandoned.

Dated this 11th day of May, 1993.

Randy R. Scott (SEAL) _____ (SEAL)

Susan J. Scott (SEAL) _____ (SEAL)

STATE OF OREGON
County of Klamath } ss.

On this 11th day of May, 1993, personally appeared before me a notary public in and for said State, the within named

RANDY R. SCOTT and SUSAN J. SCOTT
to me known to be the identical person s described therein and who executed the foregoing instrument, and acknowledged to me that they are executed the same freely and voluntarily for the uses and purposes therein mentioned.

IN WITNESS WHEREOF, I have hereunto set my hand and official seal the day and year above written.

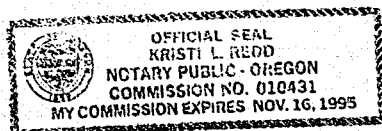

Kristi L. Reed
Notary Public for OREGON
Residing at Klamath County
My commission expires: 11/16/95

EXHIBIT A

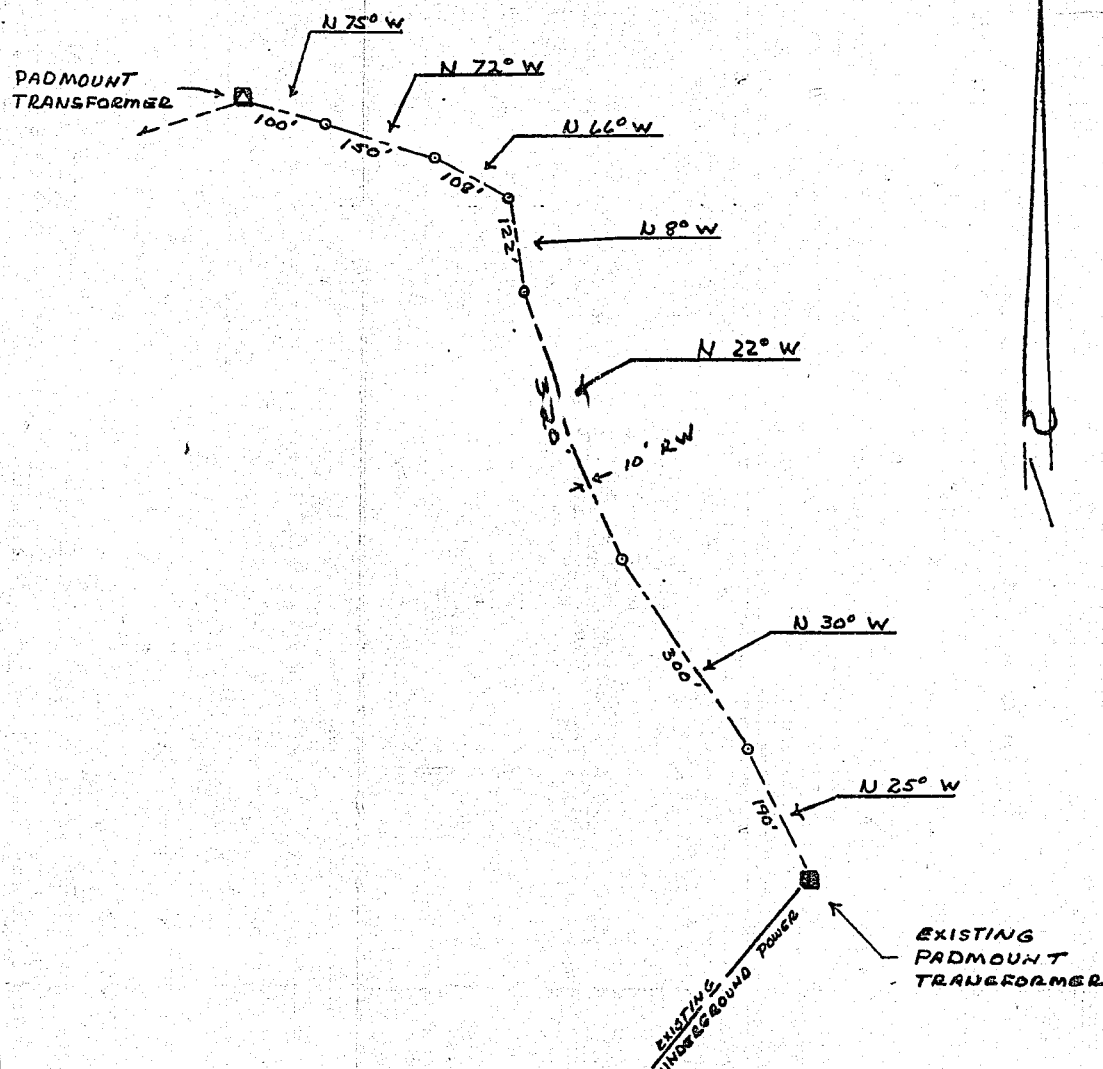

DISTRICT <u>KLAMATH FALLS</u>	
NAME _____	<u>41360-7886</u>
LOCATION _____	ER NO. <u>306-611</u>
MAP NO. _____	W.O. <u>7886</u>
DRAWN <u>KT 8-18-92</u>	

PACIFIC POWER & LIGHT COMPANY
E R SKETCH

SCALE _____

FORM 3705 REV. 5/87

STATE OF OREGON: COUNTY OF KLAMATH: ss.

Filed for record at request of PP&L the 14th day
of May A.D., 19 93 at 2:51 o'clock P.M., and duly recorded in Vol. M93
of Deeds on Page 10907

FEE \$15.00

Evelyn Biehn County Clerk
By [Signature]