

to: Pacific Power
P.O. Box 728
Klamath Falls, Or. 97601

GRANTOR: Alvin Deal
Glorie Deal
Charles W. Landry
Willine J. Landry

ER No. 41360-300-611
WO No. 8002

Vol. 93 Page 17943

UNDERGROUND RIGHT-OF-WAY EASEMENT (Individual)

For value received, the undersigned, (Grantor), (whether singular or plural), do hereby grant to PacificCorp, a corporation doing business as Pacific Power & Light Company, its successors and assigns, (Grantee), an easement or right-of-way, ten (10) feet in width, for an electric underground distribution line of one or more conductors and all necessary or desirable appurtenances (including but not limited to the right to install conduits, surface or subsurface mounted transformers, surface mounted connection boxes and meter cabinets) over, under, across and along the following described real property in Klamath County, State of Oregon, to wit:

A portion of The North Half (N $\frac{1}{2}$) of The Southwest Quarter (SW $\frac{1}{4}$) of The Southwest Quarter (SW $\frac{1}{4}$) of Section 17, Township 39 South, Range 8 East, Willamette Meridian, as described in Volume M89, page 9872, Official Records of Klamath County, Oregon.

The underground power line will be installed within the existing road easement established by that instrument recorded in Volume M78, page 28304, Official Records of Klamath County, Oregon.

the location and course of said right-of-way are approximately as shown on the sketch attached as Exhibit(s) A and by this reference made a part hereof.

Together with the right of ingress and egress over the adjacent lands of the Grantor in order to install, maintain, repair, replace, rebuild, operate and patrol the underground electric power lines and appurtenances, and to exercise all other rights herein granted.

Grantor shall have the right to use the lands subject to the above-described easement for all purposes not inconsistent with the uses and purposes herein set forth; provided that Grantor shall not build or erect any structure upon the right-of-way without the prior written consent of Grantee.

All rights hereunder shall cease if and when such line shall have been abandoned.

Dated this 10th day of May 1993.
Alvin Deal (SEAL) Charles W. Landry (SEAL)
Glorie Deal (SEAL) Willine J. Landry (SEAL)
STATE OF OREGON
County of KLAMATH

On this 10TH day of MAY, 19 93, personally appeared before me a notary public in and for said State, the within named ALVIN DEAL, GLORIA DEAL, CHARLES LANDRY, WILLINE LANDRY to me known to be the identical person THEY described therein and who executed the foregoing instrument, and acknowledged to me that THEY executed the same freely and voluntarily for the uses and purposes therein mentioned.

IN WITNESS WHEREOF, I have hereunto set my hand and official seal the day and year above written.

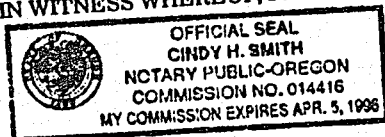

Cindy H. Smith
Notary Public for OREGON
Residing at KLAMATH FALLS
My commission expires: 4-5-96

THIS DOCUMENT WILL BE VALID FOR 120 DAYS FROM THE DATE OF BEING NOTARIZED.
VOID AFTER 120 DAYS, IF PACIFIC POWER HAS NOT INSTALLED UNDER GROUND LINE
WITHIN THAT TIME.

17944

EXHIBIT "A"

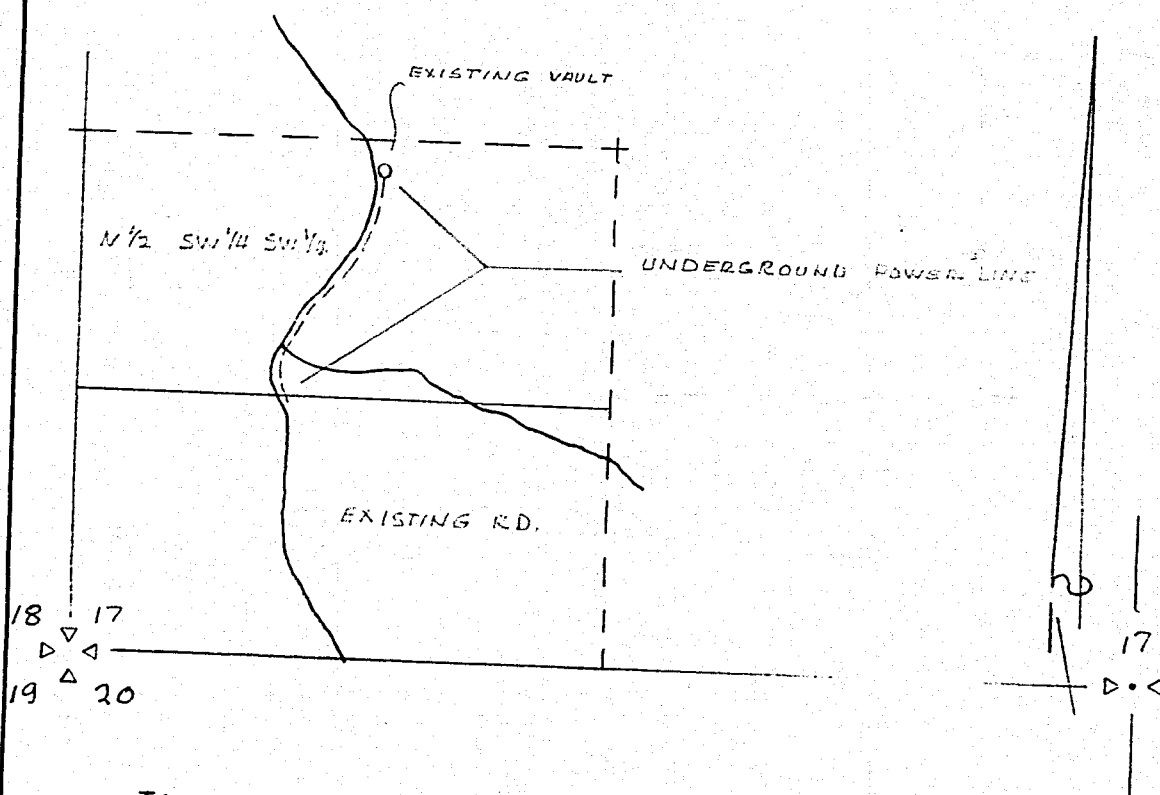

TOWNSHIP 39 SOUTH, RANGE 8 EAST W.M.

DISTRICT _____	
NAME _____	ER NO WO
LOCATION _____	
MAP NO _____	
DRAWN _____ 19 _____	

PACIFIC POWER & LIGHT COMPANY
E R SKETCH

SCALE _____

FORM 2705 REV 8-87

STATE OF OREGON: COUNTY OF KLAMATH: SS.

Filed for record at request of PP&L the 23rd day
 of July A.D., 19 93 at 11:24 o'clock A.M., and duly recorded in Vol. M93
 of Deeds on Page 17943

FEE \$15.00

Evelyn Biehn: County Clerk

By Debra M. M. M. M. M.