

65059

07-23-93A11:24 RCVD

GRANTOR: Charles W. Landry
Willine J. LandryReturn to: Pacific Power
P.O. Box 728
Klamath Falls, Or. 97601Vol. m93 Page 17945ER No. 41360-300-611
WO No. 8002**UNDERGROUND
RIGHT-OF-WAY EASEMENT**
(Individual)

For value received, the undersigned, (Grantor), (whether singular or plural), do hereby grant to PacificCorp, a corporation doing business as Pacific Power & Light Company, its successors and assigns, (Grantee), an easement or right-of-way, ten (10) feet in width, for an electric underground distribution line of one or more conductors and all necessary or desirable appurtenances (including but not limited to the right to install conduits, surface or subsurface mounted transformers, surface mounted connection boxes and meter cabinets) over, under, across and along the following described real property in Klamath County, State of Oregon, to wit:

A portion of The South Half (S $\frac{1}{2}$) of The Southwest Quarter (SW $\frac{1}{4}$) of The Southwest Quarter of Section 17, Township 39 South, Range 8 East, Willamette Meridian, as described in Volume M92, page 8380, Official Records of Klamath County, Oregon.

The underground power line will be installed within the existing road easement established by that instrument recorded in Volume M78, page 28304, Official Records of Klamath County, Oregon.

the location and course of said right-of-way are approximately as shown on the sketch attached as Exhibit(s) A and by this reference made a part hereof.

Together with the right of ingress and egress over the adjacent lands of the Grantor in order to install, maintain, repair, replace, rebuild, operate and patrol the underground electric power lines and appurtenances, and to exercise all other rights herein granted.

Grantor shall have the right to use the lands subject to the above-described easement for all purposes not inconsistent with the uses and purposes herein set forth; provided that Grantor shall not build or erect any structure upon the right-of-way without the prior written consent of Grantee.

All rights hereunder shall cease if and when such line shall have been abandoned.

Dated this 13TH day of MAY, 19 93.

Charles W. Landry (SEAL) _____ (SEAL)

Willine J. Landry (SEAL) _____ (SEAL)

STATE OF OREGON

County of KLAMATH

On this 13TH day of MAY, 19 93, personally appeared before me a notary public in and for said State, the within named CHARLES LANDRY + WILLINE J. LANDRY to me known to be the identical person _____ described therein and who executed the foregoing instrument, and acknowledged to me that _____ executed the same freely and voluntarily for the uses and purposes therein mentioned.

IN WITNESS WHEREOF, I have hereunto set my hand and official seal the day and year above written.

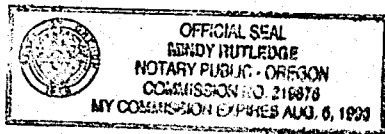

Mindy Rutledge
Notary Public for OREGON
Residing at SOUTH VALLEY STATE PARK
My commission expires: 2-6-95

EXHIBIT "A"

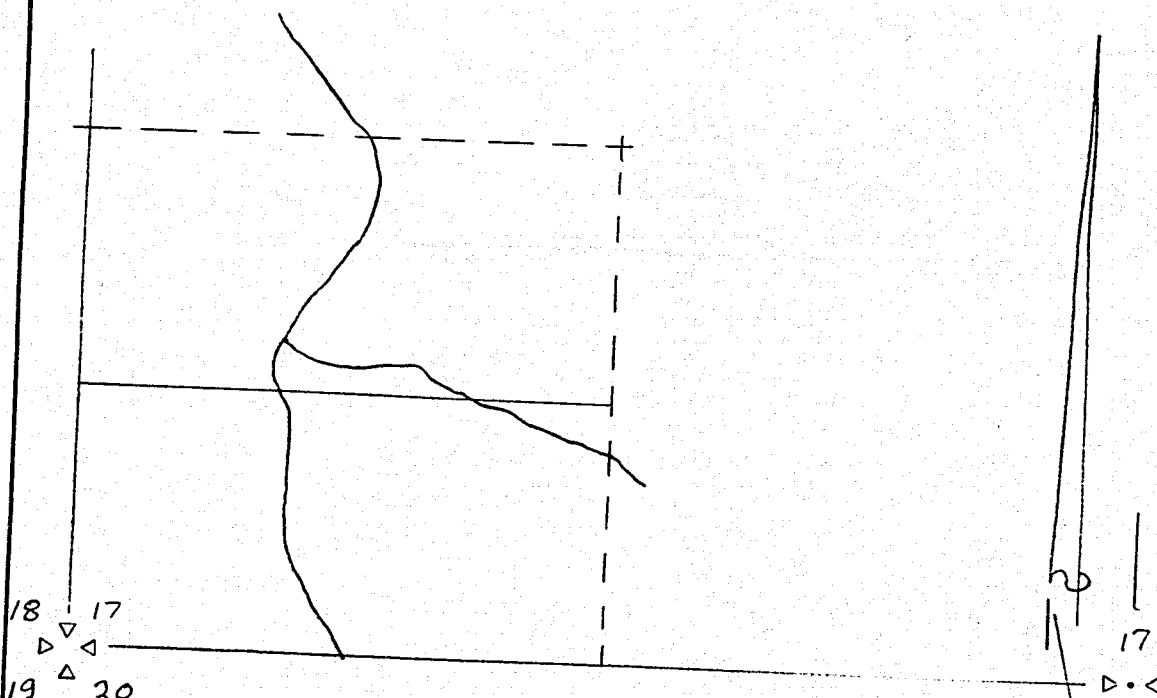

TOWNSHIP 39 SOUTH, RANGE 8 EAST W.M.

DISTRICT _____					
NAME _____	<table border="1"> <tr> <td>ER NO</td> <td></td> </tr> <tr> <td>WO</td> <td></td> </tr> </table>	ER NO		WO	
ER NO					
WO					
LOCATION _____					
MAP NO _____					
DRAWN _____ 19 _____					

PACIFIC POWER & LIGHT COMPANY
E R SKETCH

SCALE _____

FORM 2705 REV 6/87

STATE OF OREGON: COUNTY OF KLAMATH: ss.

Filed for record at request of PP&L
of July A.D., 19 93 at 11:24 o'clock A M., and duly recorded in Vol. M93
of Deeds on Page 17945

FEE \$15.00

Evelyn Biehn County Clerk

By [Signature]