

WHEN RECORDED MAIL TO:

Bruce M. and Patricia A. Boyd
 HC 63 Box 574
 Chiloquin, OR 97624

SEND TAX STATEMENT TO:

Bruce M. and Patricia A. Boyd
 HC 63 Box 574
 Chiloquin, OR 97624

Winema No. 2003

QUITCLAIM DEED

THIS DEED, made this 30 day of AUGUST, 1993, between the UNITED STATES OF AMERICA, acting through the Forest Service, Department of Agriculture, hereinafter called Grantor, and Bruce M. and Patricia A. Boyd, husband and wife, of HC63, Box 574, Chiloquin, Oregon, hereinafter called Grantee.

WITNESSETH: The Grantor is authorized to convey certain National Forest System lands by the Act of January 12, 1983 (96 Stat. 2535; 16 U.S.C. 521c).

NOW THEREFORE, the Grantor, for and in consideration of ONE HUNDRED AND TWENTY-EIGHT DOLLARS (\$128.00), the receipt whereof is hereby duly acknowledged, does hereby remise, release, and quitclaim unto the Grantee, its successors and assigns, all its right, title, interest and claim, in and to the real property situated in the County of Klamath, State of Oregon, described as follows:

T. 35 S., R. 9 E., W.M.

Section 11: a portion of the S1/2NW1/4NW1/4, more particularly describes as follows:

Commencing at a found 3 inch diameter aluminum cap marking the N1/16 corner for sections 10 and 11, T. 35 S., R. 9 E., W.M.; thence S.89°27'00"E., 121.53 feet to the True Point of Beginning, said point being a 5/8 inch rebar with an aluminum survey cap; thence, N.12°21'43"E., 70.92 feet to a 5/8 inch rebar with an aluminum survey cap; thence, N.65°17'58"E., 236.57 feet to a point on the southerly right-of-way line of the Sprague River Highway; thence, southeasterly following a curve to the right, on said right-of-way line, having a radius of 3928.9 feet (a chord length of 21.45 feet, a chord bearing of S.64°02'34"E., and a delta angle of 00-18-32), 21.45 feet to a point; thence, leaving said right-of-way line, S.06°24'27"W., 161.98 feet to a 5/8 inch rebar with an aluminum survey cap; thence, N.89°27'00"W., 231.33 feet to the True Point of Beginning.

Containing 0.64 acre, more or less, according to the plat entitled Map of Survey for Winema National Forest, in NW1/4 section 11, T. 35 S., R. 9 E., W.M., Klamath County, Oregon, dated October 14, 1992, a reduced copy marked Exhibit A attached hereto and made a part hereof.



Certified correct as to consideration,
 conditions, and descriptions *Marion R. Stump* 8/30/1993

25e
CA

EXCEPTING AND RESERVING TO THE UNITED STATES OF AMERICA and its assigns from the lands so granted, an exclusive perpetual easement, including all right, title, and interest for an existing road more particularly identified and described on the attached Exhibit A, and all appurtenances thereto, over, upon, or under the land so granted, together with such reasonable rights of temporary use of lands immediately adjacent to said easement as may be necessary for the maintenance and/or repair of said road.

Said easement being 50 feet wide, measured at a right angle to the Sprague River Highway, and parallels the south right-of-way line of said Sprague River Highway. The south right-of-way line of said Sprague River Highway is the northerly boundary of said easement.

IT IS AGREED that Bruce M. and Patricia A. Boyd, its successors and assigns, shall have the right to use the existing easement described above for all purposes deemed necessary or desirable in connection with the protection, administration, management, and utilization of Bruce M. and Patricia A. Boyd's lands or resources, subject, however to traffic-control regulations under 36 CFR 212.7(a)(1) and (2), and the bearing of road maintenance costs proportionate to use as provided in 36 CFR 212.7(d).

PROVIDED, that if the Regional Forester determines that the road, or any segment thereof, is no longer needed for the purposes reserved, the easement shall terminate. The termination shall be evidenced by a statement in recordable form furnished by the Regional Forester to Bruce M. and Patricia A. Boyd, or its successors or assigns in interest.

This instrument will not allow use of the property described in the instrument in violation of applicable land use laws and regulations. Before signing or accepting this instrument, the person acquiring fee title to the property should check with the appropriate city or County Planning Department to verify approved uses.

IN WITNESS THEREOF, the Grantor, by its duly authorized representative has executed this deed pursuant to the delegation of authority promulgated in Title 7 CFR 2.42, and 49 F.R. 34283, August 29, 1984.

UNITED STATES OF AMERICA

BY Manuel R. Castaneda
 MANUEL R. CASTANEDA
 Forest Supervisor, Winema National Forest
 Forest Service
 U. S. Department of Agriculture

ACKNOWLEDGMENT

STATE OF Oregon)
)ss.
 County of Klamath

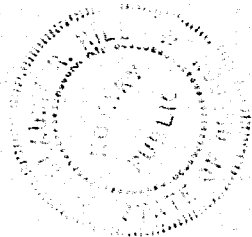

On this 30th day of August of 1993, before me, a Notary Public within and for said State, personally appeared Manuel R. Castaneda, Forest Supervisor of Winema National Forest, Forest Service, Department of Agriculture, and the same person who executed the within and foregoing instrument, who, being by me duly sworn according to law, did say that he is the Forest Supervisor of the Winema National Forest, Forest Service, Department of Agriculture, and that said instrument was signed in behalf of the United States of America by its authority duly given and by him delivered as and for its act and deed. And he did further acknowledge that he executed said instrument as the free act and deed of the United States of America, for the purposes and consideration herein mentioned and set forth, and I do hereby so certify.

IN WITNESS WHEREOF, I have hereunto set my hand and affixed my official seal the day and year above written.

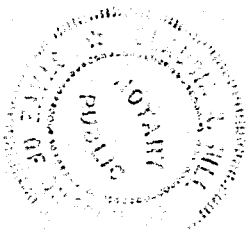

SEAL

Claudia R Hill
 Notary Public for the State of Oregon
 Residing at Klamath Falls, Oregon
 My commission expires _____

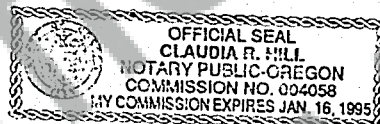
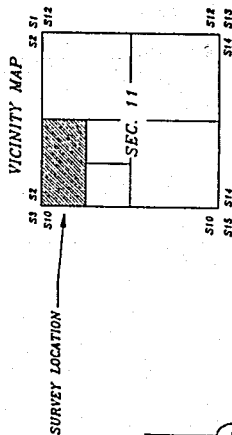

EXHIBIT A

MAP OF SURVEY
for: WINEMA NATIONAL FOREST
in: SECTION 11, T35S, R9E, W.M.
KLAMATH COUNTY, OREGON
SMALL TRACTS CASE NO. 062003
DATE SURVEYED: OCT. 14, 1992



NARRATIVE

The purpose of this survey was to establish the new property boundary line between National Forest System Land and private land, Section 11, Township 35 S., Range 9 E., Millamette Meridian, Harlan County, Ga.

THE BASIS OF BEARINGS for this survey was Record Of Survey No. 4248, A L&R/Sokkia Set-2 Electronic Total Station with SDR-33 data collector was used to traverse through all found monuments. The property corners were set from the closed loop control traverse that had a precision of 1:23,700 and was then adjusted by the Compass rule.

Aluminum posts with NATIONAL FOREST PROPERTY BOUNDARY signs were placed along the lines. 5/8" rebar with 1-1/2" aluminum SURV-KAPs stamped "PROP. COR. 1992 PLS 2205" were set at the corners described on this plat.

I certify that this survey was performed at the request of the Winema National Forest Supervisor.

of Bob Castaneda
Forest Supervisor

SURVEYOR'S CERTIFICATE

L. Vayen Yee, a Licensed Land Surveyor in the State of Oregon hereby certify that this plat is a true representation of a survey performed under my direct supervision, in accordance with the Statutes of the State of Oregon.

When the statutes of the State of Oregon
 Wayne, Pcs
 Volney, Pub 2000
 Forest Land Surveyor
 The record of survey was performed by and under the provisions
 of the Small Tracts Act (66 STAT 2535)
 Forest Service and Bruce M. and Patricia A. Boyd (Small Tracts Case
 No. 062032).

Surveyed By: J M ROBINSON, 10/92

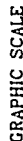

GRAPHIC SCALE (IN FEET)

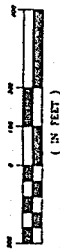

PRIVATE OWNERSHIP

STATE OF OREGON: COUNTY OF KLAMATH: ss.

Filed for record at request of U. S. Forest Service the 2nd day
of Sept. A.D., 19 93 at 11:39 o'clock A M., and duly recorded in Vol. M93,
of Deeds on Page 22395.

FEE \$25.00

Evelyn Biehn - County Clerk

By Pauline K. Henderson