

69731

GRANTOR: Taylor E. High

Return to:
Pacific Power
P.O. Box 728

10-14-93P03:16 RCVD

Betty J. High

File No. _____
ER No. 41360-300-611
WO No. 8748

Klamath Falls, Or. 97603-0321

RIGHT-OF-WAY EASEMENT

(Individual)

Vol. m93 Page 26913

For value received, the undersigned, hereinafter referred to as Grantors, (whether singular or plural), do hereby grant to PacifiCorp, a corporation doing business as Pacific Power & Light Company, its successors and assigns, the Grantee, an easement or right-of-way for an electric transmission and distribution line of one or more wires and all necessary or desirable appurtenances (including telephone and telegraph wires, towers, poles, props, guys, anchors and other supports and the right to place all or any part of such line underground) at or near the location and along the general course now located and staked out by the Grantee over, across and upon the following described real property in Klamath County, State of Oregon, to wit:

Situated in The Northwest Quarter (NW $\frac{1}{4}$) of The Southeast Quarter (SE $\frac{1}{4}$) of Section 14, Township 39 South, Range 10 East, Willamette Meridian.

Said right-of-way shall be ten (10) feet in width.

And for the installation of an overhead electrical circuit as more particularly shown on Exhibit "A" attached hereto and by this reference made a part hereof.

Including the right to clear said right-of-way and keep the same clear of brush, trees, timber and structures, and the right to top, trim, clear or cut away all trees outside of said right-of-way which might endanger such line.

Together with the right of ingress and egress over the adjacent lands of the Grantors for the purpose of constructing, reconstructing, stringing new wires on, maintaining and removing such line and appurtenances, and exercising other rights hereby granted.

Grantors reserve the right to use said right-of-way for roads, agricultural crops or other purposes not inconsistent with the easement granted hereby, but in using or operating any irrigation pipes, motorized vehicles or other equipment, or in any other such use of said right-of-way, Grantors and Grantors' heirs or assigns, shall conform strictly to the provisions of any then applicable safety code or regulation pertaining to required clearances from the wires or conductors of such line.

All rights hereunder shall cease if and when such line shall have been abandoned.

Dated this 1st day of OCTOBER, 19 93.

Taylor E. High (SEAL) _____ (SEAL)
Betty J. High (SEAL) _____ (SEAL)

STATE OF OREGONCounty of KLAMATH

ss.

On this 1st day of OCT, 19 93, personally appeared before me a notary public in and for said State, the within named TAYLOR E. HIGH AND BETTY J. HIGH
HUSBAND & WIFE
to me known to be the identical person 5 described therein and who executed the foregoing instrument, and acknowledged to me that THEY executed the same freely and voluntarily for the uses and purposes therein mentioned.

IN WITNESS WHEREOF, I have hereunto set my hand and official seal the day and year above written.

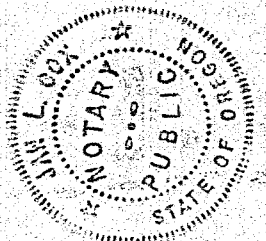
Notary Public for OREGONResiding at KLAMATH FALLSMy commission expires: JUNE 6, 1994

RIGHT-OF-WAY IS SITUATED
IN THE NW 1/4 SEC. 14,
T5 39S, R10E, WM

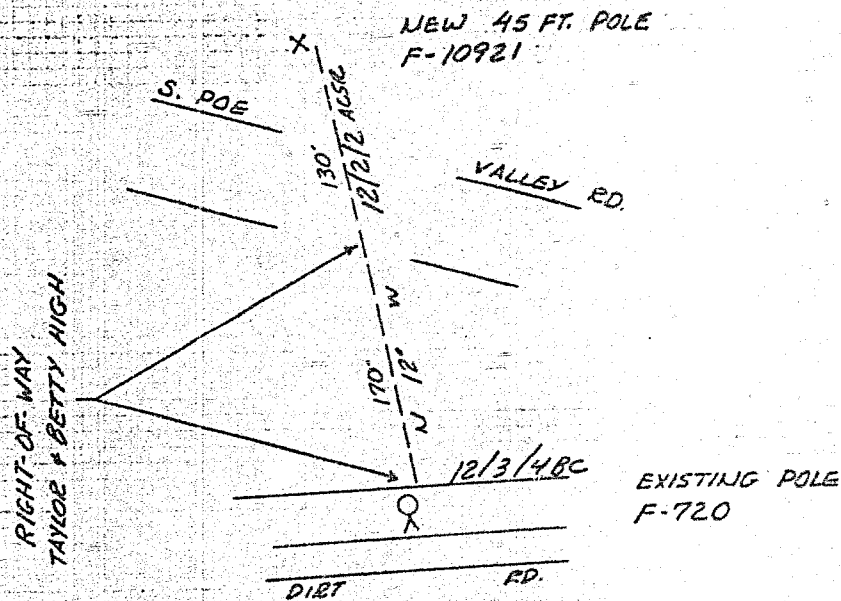

EXHIBIT "A"

| | | | |
|---|---------------|----------------|--|
| DISTRICT <u>KLAMATH</u> | | | |
| NAME <u>ERNIE MESSNER</u> | <u>411360</u> | | |
| LOCATION <u>11777 S. POE VALLEY RD.</u> | ER NO. | <u>300-611</u> | |
| MAP NO. <u>F-88-6</u> | W.O. | <u>8718</u> | |
| DRAWN <u>RE</u> | <u>1-25</u> | <u>19 22</u> | |

PACIFIC POWER & LIGHT COMPANY

E R SKETCH

SCALE 1" = 100'

FORM 2100-REV. 8/57

STATE OF OREGON: COUNTY OF KLAMATH: ss.

Filed for record at request of Pacific Power the 14th day
of Oct. A.D., 19 93 at 3:16 o'clock P M., and duly recorded in Vol. M93
of Deeds on Page 26913

Evelyn Biehn County Clerk

By Ernie Messner

FEE \$15.00