

RETURN TO: Pacific Power
PO Box 728
Klamath Falls, OR
12-07-93A11:47 RC97601

GRANTOR: Leslie Northcutt
Norma V. Northcutt

File No.
ER No. 41360-300-6.
WO No. 8819

RIGHT-OF-WAY EASEMENT
(Individual)

Vol m93 Page 32487

For value received, the undersigned, hereinafter referred to as Grantors, (whether singular or plural), do hereby grant to PacifiCorp, a corporation doing business as Pacific Power & Light Company, its successors and assigns, the Grantee, an easement or right-of-way for an electric transmission and distribution line of one or more wires and all necessary or desirable appurtenances (including telephone and telegraph wires, towers, poles, props, guys, anchors and other supports and the right to place all or any part of such line underground) at or near the location and along the general course now located and staked out by the Grantee over, across and upon the following described real property in Klamath County, State of Oregon, to wit:

A portion of The Northeast Quarter (NE $\frac{1}{4}$) of The Southeast Quarter (SE $\frac{1}{4}$) of The Southeast Quarter (SE $\frac{1}{4}$) of Section 6, Township 39 South, Range 8 East, Willamette Meridian.

The location and course of said easement and right-of-way are approximately as shown on the sketch attached as Exhibit "A" and by this reference made a part hereof.

Including the right to clear said right-of-way and keep the same clear of brush, trees, timber and structures, and the right to top, trim, clear or cut away all trees outside of said right-of-way which might endanger such line.

Together with the right of ingress and egress over the adjacent lands of the Grantors for the purpose of constructing, reconstructing, stringing new wires on, maintaining and removing such line and appurtenances, and exercising other rights hereby granted.

Grantors reserve the right to use said right-of-way for roads, agricultural crops or other purposes not inconsistent with the easement granted hereby, but in using or operating any irrigation pipes, motorized vehicles or other equipment, or in any other such use of said right-of-way, Grantors and Grantors' heirs or assigns, shall conform strictly to the provisions of any then applicable safety code or regulation pertaining to required clearances from the wires or conductors of such line.

All rights hereunder shall cease if and when such line shall have been abandoned.

Dated this 18th day of NOVEMBER, 1993.

Leslie E. Northcutt (SEAL) _____ (SEAL)
Norma V. Northcutt (SEAL) _____ (SEAL)

STATE OF OREGON } ss.
County of KLAMATH }

On this 18th day of NOV, 1993, personally appeared before me a notary public in and for said State, the within named LESLIE & NORMA NORTH CUTT

to me known to be the identical person S described therein and who executed the foregoing instrument, and acknowledged to me that THEY executed the same freely and voluntarily for the uses and purposes therein mentioned.

IN WITNESS WHEREOF, I have hereunto set my hand and official seal the day and year above written.

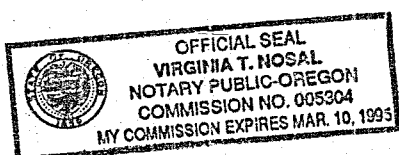

Virginia T. Nosal
Notary Public for OREGON
Residing at KLAMATH FALLS
My commission expires: MARCH 10, 1995

EXHIBIT "A"

32488

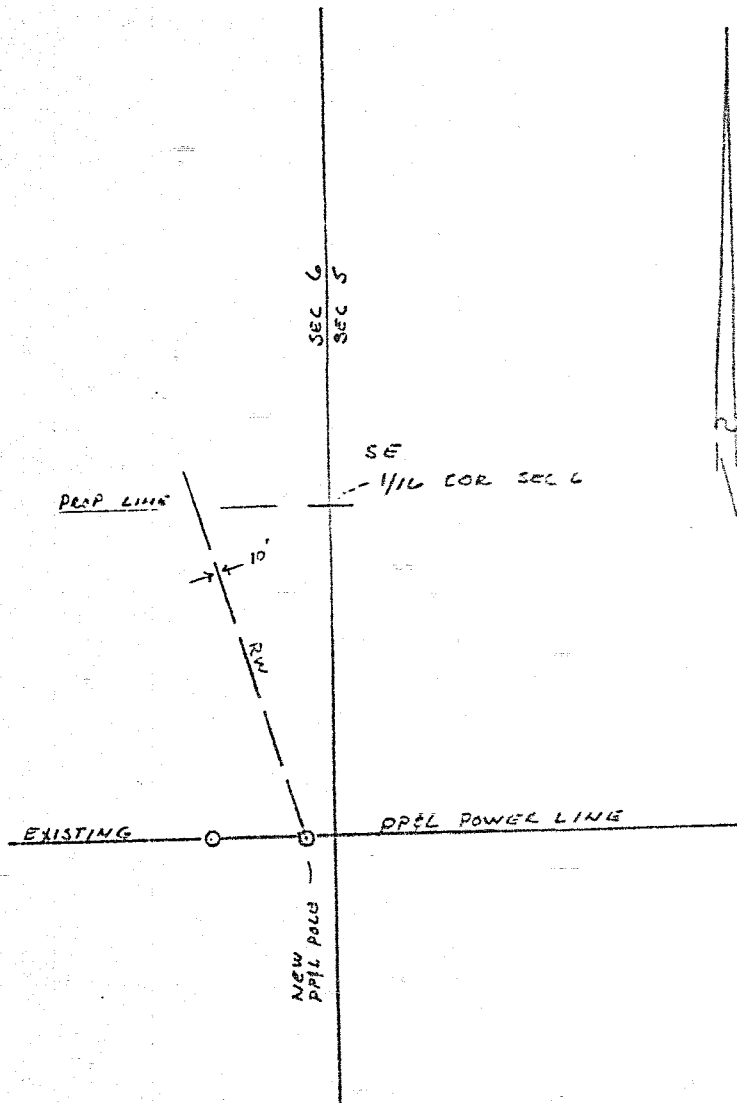

DISTRICT _____		
NAME _____	41360-8819	
LOCATION <u>ROUND LAKE</u>	ER NO	300-611
MAP NO. _____	WO	8819
DRAWN _____ 19__	FORM 2705 REV 8-87	

PACIFIC POWER & LIGHT COMPANY

E R SKETCH

SCALE 1" = 50'

STATE OF OREGON: COUNTY OF KLAMATH: SS.

Filed for record at request of PP&L the 7th day
 of Dec. A.D., 19 93 at 11:47 o'clock A M., and duly recorded in Vol. M93
 of Deeds on Page 32487

Evelyn Biehn, County Clerk

By Pauline Miller

FEE \$15.00