

Return to: Pacific Power 12-07-93A11:47 RCVD
P.O. Box 728
Klamath Falls, Or. 97601

GRANTOR: Stephen Trulove
Michelle N. Trulove

72418

ER No. 41360-300-611
WO No. 8761

UNDERGROUND
RIGHT-OF-WAY EASEMENT Vol. 1793 Page 32197
(Individual)

For value received, the undersigned, (Grantor), (whether singular or plural), do hereby grant to PacificCorp, a corporation doing business as Pacific Power & Light Company, its successors and assigns, (Grantee), an easement or right-of-way, ten (10) feet in width, for an electric underground distribution line of one or more conductors and all necessary or desirable appurtenances (including but not limited to the right to install conduits, surface or subsurface mounted transformers, surface mounted connection boxes and meter cabinets) over, under, across and along the following described real property in Klamath County, State of Oregon, to wit:

Said property generally located in The Northeast Quarter (NE $\frac{1}{4}$) of The Northwest Quarter (NW $\frac{1}{4}$) of Section 30, Township 34 South, Range 7 East, Willamette Meridian, and more specifically described as Parcel 2, Partition 19-93, in the Official Records of Klamath County.

the location and course of said right-of-way are approximately as shown on the sketch attached as Exhibit(s) "A" and by this reference made a part hereof.

Together with the right of ingress and egress over the adjacent lands of the Grantor in order to install, maintain, repair, replace, rebuild, operate and patrol the underground electric power lines and appurtenances, and to exercise all other rights herein granted.

Grantor shall have the right to use the lands subject to the above-described easement for all purposes not inconsistent with the uses and purposes herein set forth; provided that Grantor shall not build or erect any structure upon the right-of-way without the prior written consent of Grantee.

All rights hereunder shall cease if and when such line shall have been abandoned.

Dated this 5th day of November, 1993.

Stephen Trulove (SEAL) _____ (SEAL)
Michelle N. Trulove (SEAL) _____ (SEAL)

STATE OF OREGON

County of KLAMATH

On this 5th day of November, 1993, personally appeared before me a notary public in and for said State, the within named Stephen Trulove & Michelle N. Trulove to me known to be the identical person s described therein and who executed the foregoing instrument, and acknowledged to me that They executed the same freely and voluntarily for the uses and purposes therein mentioned.

IN WITNESS WHEREOF, I have hereunto set my hand and official seal the day and year above written.

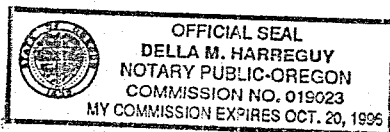

Della M. Harreguy
Notary Public for Oregon
Residing at Chiloquin, Or
My commission expires: 10-20-96

EXHIBIT A

32498

PACIFIC POWER & LIGHT COMPANY

OWNER Trulove, Stephen A./Michelle N.

E.R./W.O. 41360-300-611-8761

NE 1/4, NW 1/4 SEC. 30, T. 34S., R. 7E, W.M.

MAP A-45-9

KLAMATH COUNTY, OREGON

SCALE 1" = 100'

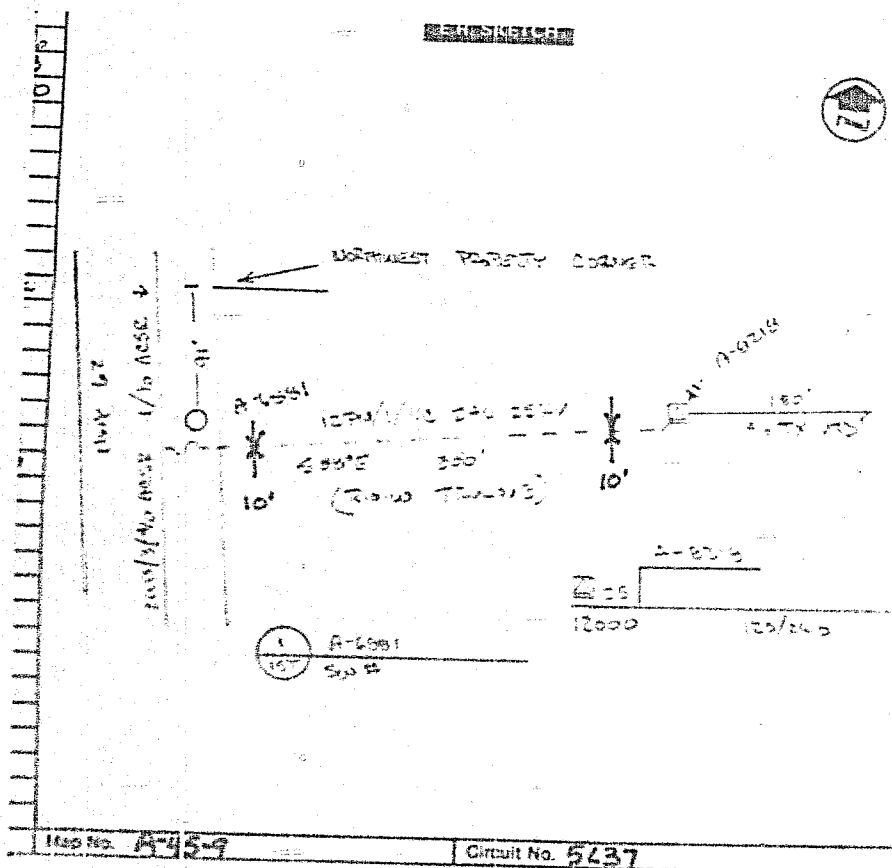

STATE OF OREGON: COUNTY OF KLAMATH: ss.

Filed for record at request of PP&L the 7th day of Dec. A.D. 19 93 at 11:47 o'clock A M., and duly recorded in Vol. M93 of Deeds on Page 32497

FEE \$15.00

Evelyn Biehn - County Clerk

By Quinn Muckelbauer