

90140

10-25-94P(3:16 RCVD)

GRANTORS: Mildred Fotheringham
Joe. C. Fotheringham
Walter W. FotheringhamVol. m94 Page 33178Return to: Pacific Power
P.O. Box 728
Klamath Falls, Or. 97601ER No. 41360-611WO No. 9551UNDERGROUND
RIGHT-OF-WAY EASEMENT
(Partnership)

For value received, the undersigned (Grantor), (whether singular or plural), do hereby grant to PacificCorp, a corporation doing business as Pacific Power & Light Company, its successors and assigns, (Grantee), an easement or right-of-way, ten (10) feet in width, for an electric underground distribution line of one or more conductors and all necessary or desirable appurtenances (including but not limited to the right to install conduits, surface or subsurface mounted transformers, surface mounted connection boxes and meter cabinets) over, under, across and along the following described real property in Klamath County, State of Oregon, to wit:

Said property located in the Southwest Quarter (SW $\frac{1}{4}$) of The Southwest Quarter (SW $\frac{1}{4}$) of Section 4, Township 41 South, Range 10 East, Willamette Meridian, as described in Volume M93, Page 18195, Official Book of Records, Klamath County, Oregon.

the location and course of said right-of-way are approximately as shown on the sketch attached as Exhibit(s) A and by this reference made a part hereof.

Together with the right of ingress and egress over the adjacent lands of the Grantor in order to install, maintain, repair, replace, rebuild, operate and patrol the underground electric power lines and appurtenances, and to exercise all other rights herein granted.

Grantor shall have the right to use the lands subject to the above-described easement for all purposes not inconsistent with the uses and purposes herein set forth; provided that Grantor shall not build or erect any structure upon the right-of-way without the prior written consent of Grantee.

All rights hereunder shall cease if and when such line shall have been abandoned.

Dated this 1st day of October, 19 94.

Walter W. Fotheringham (SEAL) Mildred Fotheringham (SEAL)
J. C. Fotheringham (SEAL) (SEAL)

STATE OF Oregon

County of Klamath

On this 1st day of October, 19 94, personally appeared before me a notary public in and for said State, the within named W. W. Fotheringham to me known to be the identical person 2 described therein and who executed the foregoing instrument, and acknowledged to me that they executed the same freely and voluntarily for the uses and purposes therein mentioned.

IN WITNESS WHEREOF, I have hereunto set my hand and official seal the day and year above written.

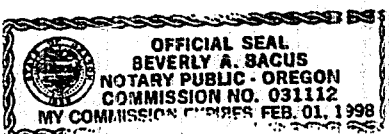

Beverly A. Sacus
Notary Public for Oregon
Residing at Married
My commission expires: 2-1-98

33179

EXHIBIT "A"

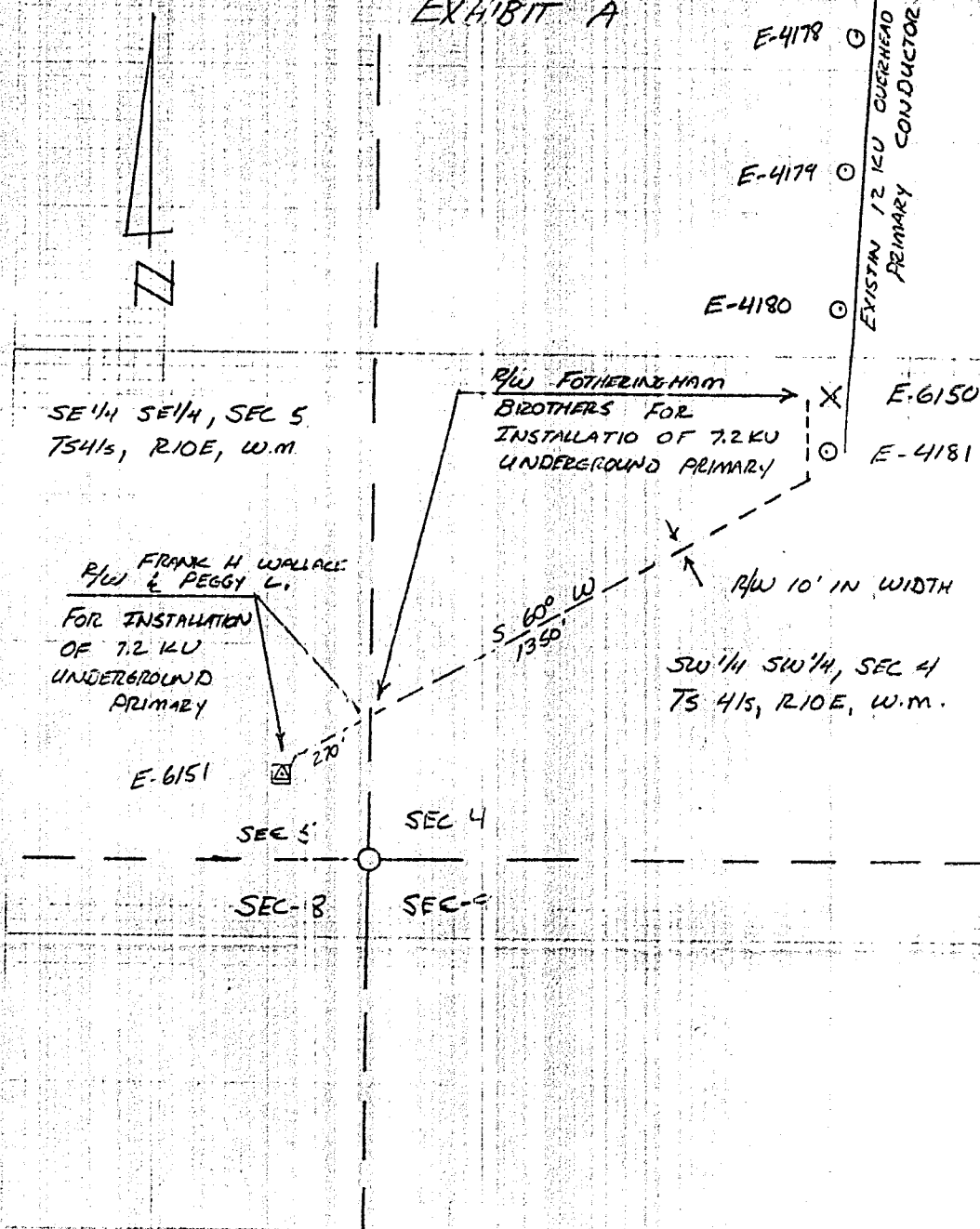
DISTRICT KLAMATH FALLSNAME RANDY WALLACELOCATION BUSING RDMAP NO. E-90-2 E-90-3DRAWN BY BUNDLIN 9-26-94

FILE NO.

41360

E II NO.

300-611

W.O.

9551

PACIFIC POWER & LIGHT COMPANY

E R SKETCH

SCALE 1" = 400'

FORM 2700-4/7-

STATE OF OREGON: COUNTY OF KLAMATH: ss.

Filed for record at request of Pacific Power the 25th day
 of Oct A.D. 19 94 at 3:36 o'clock P.M., and duly recorded in Vol. M94
 of Der: is on Page 33178

By Brelyn Biehn County ClerkBy Pauline Mullins

FEE \$15.00