

Return to: Pacific Power

P.O. Box 728

Klamath Falls, Or. 97601

10-25-94 P03:36 RCVD

ER No. 41360-611WO No. 9551

# UNDERGROUND RIGHT-OF-WAY EASEMENT

(Individual)

For value received, the undersigned, (Grantor), (whether singular or plural), do hereby grant to PacificCorp, a corporation doing business as Pacific Power & Light Company, its successors and assigns, (Grantee), an easement or right-of-way, ten (10) feet in width, for an electric underground distribution line of one or more conductors and all necessary or desirable appurtenances (including but not limited to the right to install conduits, surface or subsurface mounted transformers, surface mounted connection boxes and meter cabinets) over, under, across and along the following described real property in Klamath County, State of Oregon, to wit:

Said property located in The Southeast Quarter (SE $\frac{1}{4}$ ) of The Southeast Quarter (SE $\frac{1}{4}$ ) of Section 5, Township 41 South, Range 10 East, Willanette Meridian, as described in Volume M92, Page 11307, Official Book of Records, Klamath County, Oregon.

the location and course of said right-of-way are approximately as shown on the sketch attached as Exhibit(s) A and by this reference made a part hereof.

Together with the right of ingress and egress over the adjacent lands of the Grantor in order to install, maintain, repair, replace, rebuild, operate and patrol the underground electric power lines and appurtenances, and to exercise all other rights herein granted.

Grantor shall have the right to use the lands subject to the above-described easement for all purposes not inconsistent with the uses and purposes herein set forth, provided that Grantor shall not build or erect any structure upon the right-of-way without the prior written consent of Grantee.

All rights hereunder shall cease if and when such line shall have been abandoned.

Dated this 3rd day of October, 19 94.

Frank H. Wallace  
Frank H. Wallace

(SEAL)

Peggy L. Wallace  
Peggy L. Wallace

(SEAL)

(SEAL)

(SEAL)

STATE OF OREGON

County of KLAMATH

On this 3rd day of October, 19 94, personally appeared before me a notary public in and for said State, the within named Frank H. Wallace and Peggy L. Wallace AKA Margaret L. Wallace to me known to be the identical person s described therein and who executed the foregoing instrument, and acknowledged to me that they executed the same freely and voluntarily for the uses and purposes therein mentioned.

IN WITNESS WHEREOF, I have hereunto set my hand and official seal the day and year above written.

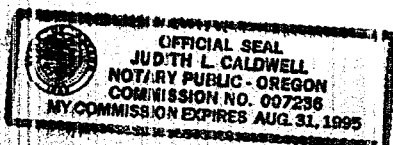

Judith L. Caldwell  
Notary Public for State of Oregon

Residing at Klamath Falls, Oregon

My commission expires: 8-31-95

## EXHIBIT "A"

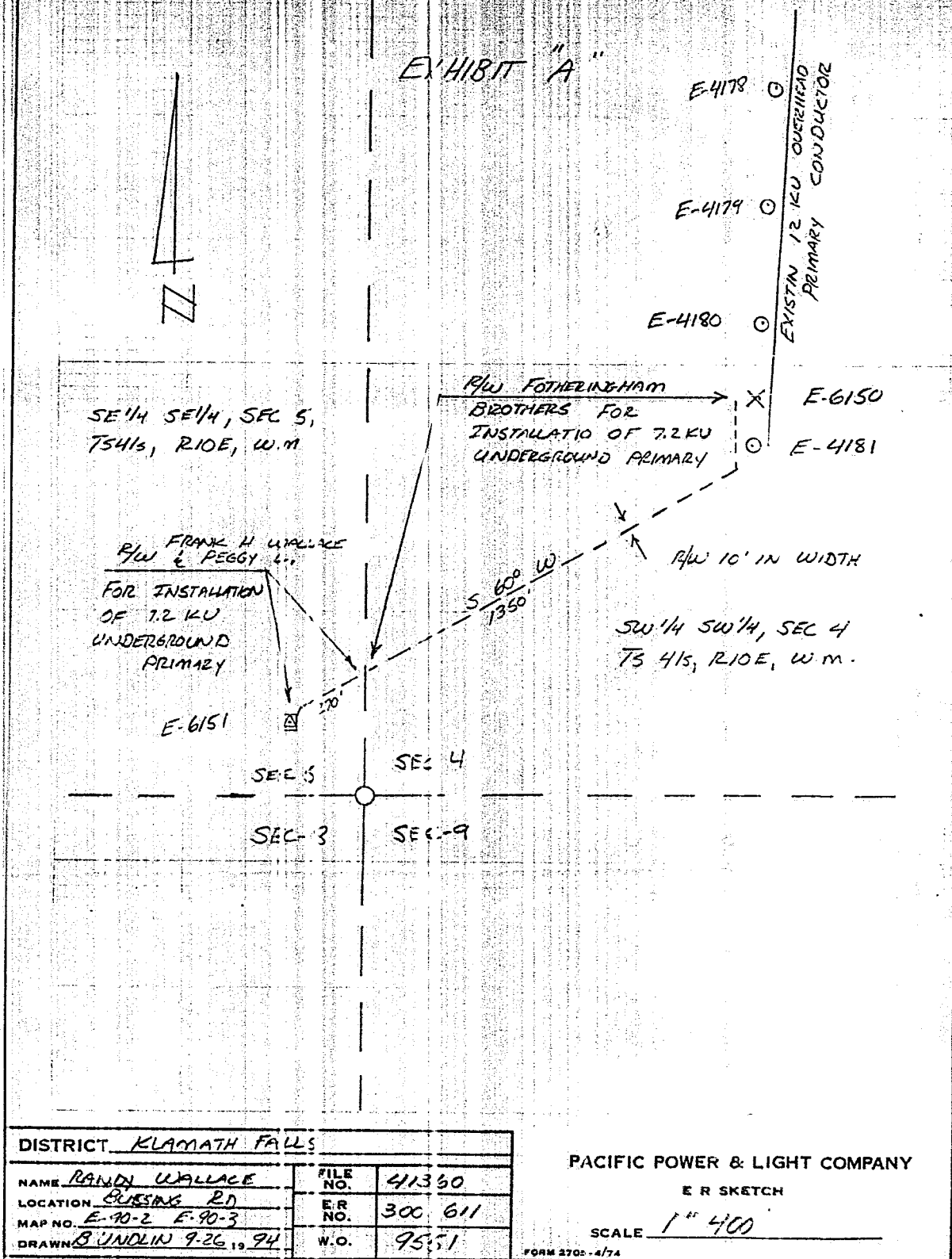

STATE OF OREGON: COUNTY OF KLAMATH: ss.

Filed for record at request of Pacific Power the 25th day  
of Oct A.D., 19 94 at 3:36 o'clock P M., and duly recorded in Vol. M94  
of Deeds on Page 33180

FEE \$15.00

Evelyn Biehn County Clerk  
By Melinda Mullendore