

96178

Route ID: O-KL-1774, O-KL-1775  
APN: 3908031C0-00100, 3908031D0-02900**RIGHT OF WAY AGREEMENT**

DOUGLAS J. PUCKETT, hereinafter called first party, in consideration of value paid by PACIFIC GAS TRANSMISSION COMPANY, a California corporation, whose address is 213 W. Sisters Avenue, Redmond, OR 97756-0123, hereinafter called second party, the adequacy and receipt where of are hereby acknowledged, hereby grants to second party the right to excavate for, install, replace (of the initial or any other size), maintain, use and remove such pipeline of any size as second party shall from time to time elect for conveying natural and artificial gas and other gaseous or liquid hydrocarbons and any products or by-products thereof, with necessary underground valves and other such appliances, and fittings, and devices for controlling electrolysis in connection with said pipeline, and such underground wires, cables, conduits, fiber optic lines and other electrical conductors, appliances, fixtures, and appurtenances as second party shall from time to time elect for pipeline communication purposes, together with adequate protection therefor, and also a right-of-way thirty-five feet in width within the herein described parcel(s) of land which is/are situated in the County of Klamath, State of Oregon, described as follows, to wit:

Parcel 1: A portion of the Southwest Quarter of Section 31, Township 39 South, Range 8 East of the Willamette Meridian, containing 9.26 acres;

Parcel 2: A portion of Section 31, Township 39 South, Range 8 East of the Willamette Meridian, containing 101.16 acres.

It is agreed between the parties that as soon as second party has completed the installation of the initial pipeline the aforesaid parcel (s) shall be restricted to the following:

That portion of the said lands of first party above described lying between lines parallel to and situate fifteen (15) feet to the north and twenty (20) feet to the south (going in a general westerly direction through the State of Oregon) measured at right angles from the center line (or tangent thereof if a curve) of the initial pipe as actually laid by the second party across the said lands of first party, or adjacent thereto if the initial pipe is not actually laid on the said lands of the first party, such parallel line or lines being extended to the boundary lines of the said lands so as to enclose the right-of-way and easement.

Second party may further define the location of said strip by recording a "Notice of Location" referring to this instrument and setting forth a legal description of the location of said initial pipe or said strip, which description may be set forth by map attached to said Notice. A copy of said Notice shall be delivered to first party. The location may not vary substantially from as indicated on the attached map(s). It is understood between the parties that the location is to be as close as practicably possible to the boundary with Weyerhaeuser Company Road.

First party further grants to second party:

- (a) the right to use such portion of said lands adjacent to and along said strip as may be reasonably necessary in connection with the installation, repair and replacement of such pipeline or other underground facilities, not to exceed a total of 30 feet adjacent to the easement granted herein except at the Highway 66 crossing;
- (b) the right of ingress to and egress from said strip over and across said lands by means of roads and lanes thereon, if such there be, otherwise by such practicable route or routes as shall occasion the least damage and inconvenience to first party;
- (c) the right from time to time to trim and to cut down and to clear away any and all trees and brush now or hereafter on said strip and to trim and to cut down and to clear away any trees on either side of said strip which now or hereafter in the opinion of second party may be a hazard to second party's facilities or may interfere with the exercise of second party's rights hereunder;
- (d) the right to install, maintain and use gates in all fences which now cross or shall hereafter cross said strip;

*Return to:*  
PGT  
48 HAWTHORNE STREET  
MEDFORD, OR 97504

(e) the right to mark the location of said strip by suitable markers set in the ground, provided that said markers shall be placed at fence lines or other locations which will not interfere with any reasonable use first party shall make of said strip.

Second party hereby covenants and agrees:

(a) second party shall pay first party the reasonable amount of actual damages to crops, timber, livestock, fences, buildings, private roads, and other improvements caused by it or its agents or employees on said lands in the construction or reconstruction of the pipeline or lines or in the exercise of the right of ingress or egress;

(b) second party shall promptly backfill any trench made by it on said strip and second party shall restore roads it may use during installation of the pipeline, drainage and the surface of the ground, so far as is practicable, to their condition prior to second party's trenching operations.

(c) second party shall indemnify first party against any loss or damage which shall be caused by any wrongful or negligent act or omission of second party or of its agents or employees in the course of their employment.

(d) second party will bury the pipeline so that the top of the pipe is a minimum of sixty inches (60") beneath the surface of the ground.

First party reserves the right to use said strip for purposes which will not interfere with second party's full enjoyment of the rights hereby granted, provided that first party shall not erect or construct any building or other structure, or drill or operate any well, or construct any reservoir or other obstruction on said strip, or diminish or substantially add to the ground cover over said pipelines or any other facilities.

The provisions herein granted shall inure to the benefit of and bind the heirs, successors, and assigns of the respective parties hereto, and all covenants shall apply to and run with the land.

IN WITNESS WHEREOF the parties have executed these presents this 8th day of February, 1995.

Executed in the presence of:

Ken Du Boggy  
Subscribing Witness

Douglas J. Puckett  
Douglas J. Puckett

Subscribing Witness

PACIFIC GAS TRANSMISSION COMPANY

By: W. G. Thomas Gme  
W. G. Thomas, Land Manager

By: \_\_\_\_\_

the location of said strip by suitable markers set in the ground, provided that said markers are placed at such locations which will not interfere with any reasonable use of the land.

the first party the responsible amount of actual damages to which it may be entitled, and other improvements caused by it or its agents or employees, in the construction or reconstruction of the pipeline or line or in the exercise of its right of eminent domain.

that such losses and damages shall be made by it or its agents or employees, in the construction or reconstruction of the pipeline or line or in the exercise of its right of eminent domain, prior to second party's trenching operations.

any of because of loss or damage which shall be caused by any of the agents or employees of second party or of its agents or employees in the course of the construction or reconstruction of the pipeline or line or in the exercise of its right of eminent domain.

the top of the pipe is a minimum of sixty inches (60").

that such losses and damages shall be made by it or its agents or employees, in the construction or reconstruction of the pipeline or line or in the exercise of its right of eminent domain, prior to second party's trenching operations.

STATE OF OREGON

) ss.

County of Jackson )

On this 9th day of February, 1995 before me Gregg A. McCleery, a Notary Public in and for the said County and State, residing therein, duly commissioned and sworn, personally appeared Kenneth W. Bagley known to me to be the person whose name is subscribed to the within instrument, as a witness thereto, who being by me duly sworn, deposes and says: THAT HE RESIDES IN Klamath Falls, Oregon, and that he was present and saw Douglas J. Puckett, personally known to him to be the same person whose name is subscribed to the foregoing instrument, execute and deliver the same, and acknowledge to said affiant that he executed the same and that said affiant subscribed his name thereto as a WITNESS.

IN WITNESS WHEREOF, I have hereunto set my hand and affixed my official seal the day and year in this Certificate first above written.

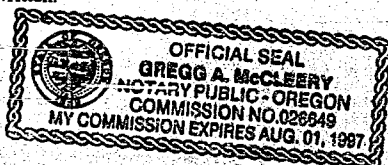

*Gregg A. McCleery*  
GREGG A. MCCLEERY  
NOTARY PUBLIC FOR OREGON  
My Commission Expires: August 1, 1997

STATE OF OREGON

) ss.

County of Jackson )

On this 8th day of March, 1995 before me appeared W. G. Thomas, to me personally known, who being duly sworn, did say that he, the said W. G. Thomas is the Land Manager of Pacific Gas Transmission Company, the within named Corporation, and that this instrument was signed in behalf of said Corporation by authority of its Board of Directors, and W. G. Thomas acknowledges said instrument to be the free act and deed of said Corporation.

IN TESTIMONY WHEREOF, I have hereunto set my hand and affixed my official seal the day and year last above written.

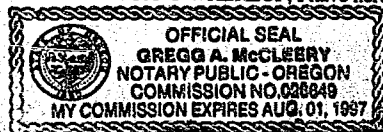

*Gregg A. McCleery*  
GREGG A. MCCLEERY  
NOTARY PUBLIC FOR OREGON  
My Commission Expires: August 1, 1997

# KLAMATH COUNTY, OREGON

SEC. 31, T-39-S, R-8-E

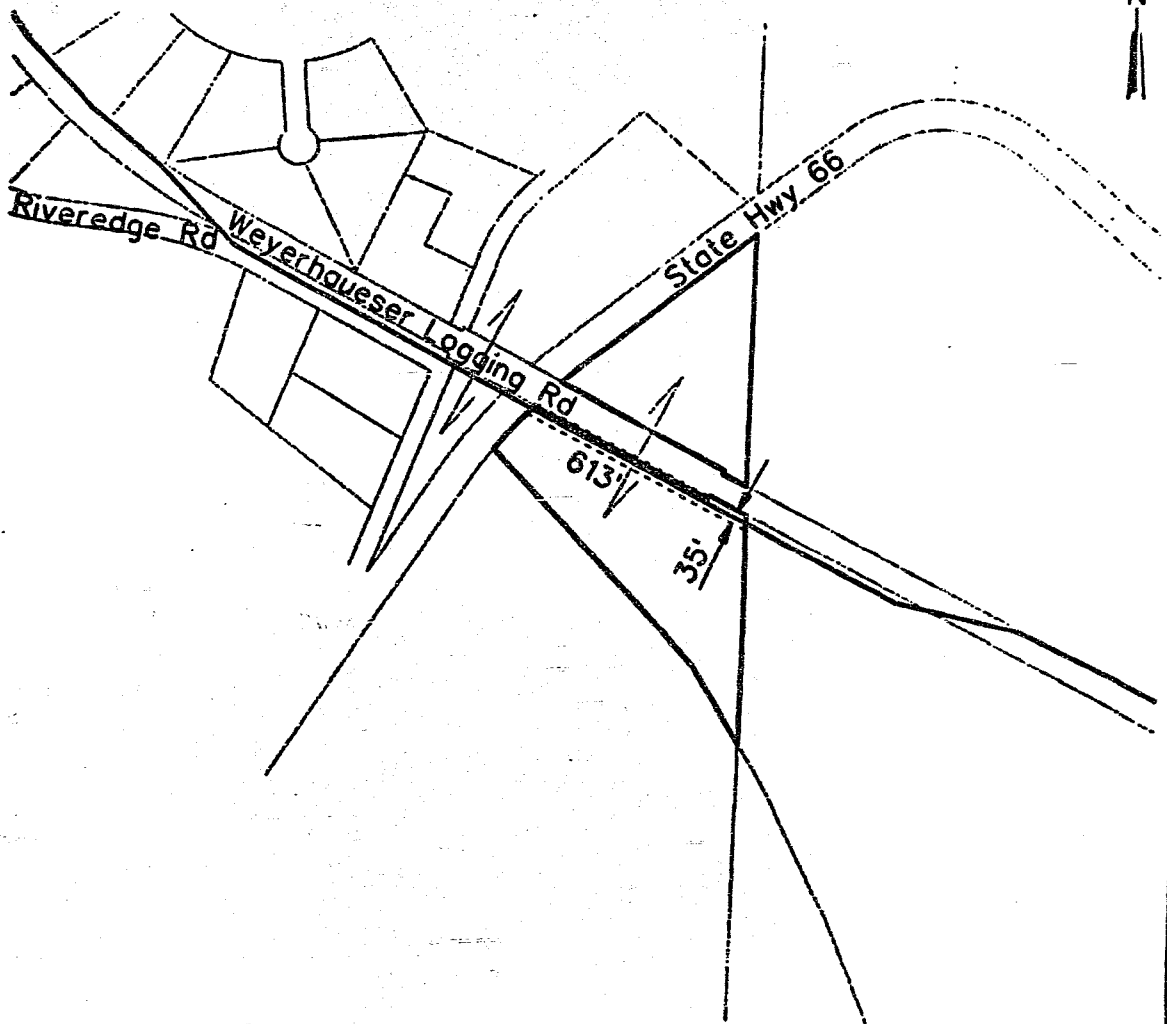
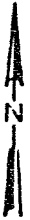

RECEIVED

1774

Robert D. Puckett & Douglas Puckett  
APN: 3908031C0-00100

JUN 23 1994

T. COVERT

NO.	DATE	DESCRIPTION	W.O.	DR.	CH.	APPROVALS

## RECORD OF APPROVALS AND CHANGES

W.O.
SUPV
DSGN B. SCHMITZ
DWN L. McCALL
CHKD
SCALE 1" = 400'

PIPELINE  
RIGHT-OF-WAY  
PACIFIC GAS TRANSMISSION COMPANY  
PORTLAND, OREGON

SUPERSEDES	
SHEET	OF SHEETS
DRAWING NUMBER	CHANGE
M-1774	0

PREPARED BY CH2M HILL 21-JUN-94

# KLAMATH COUNTY, OREGON

SEC. 31, T-39-S, R-8-E

[ 5721 ]

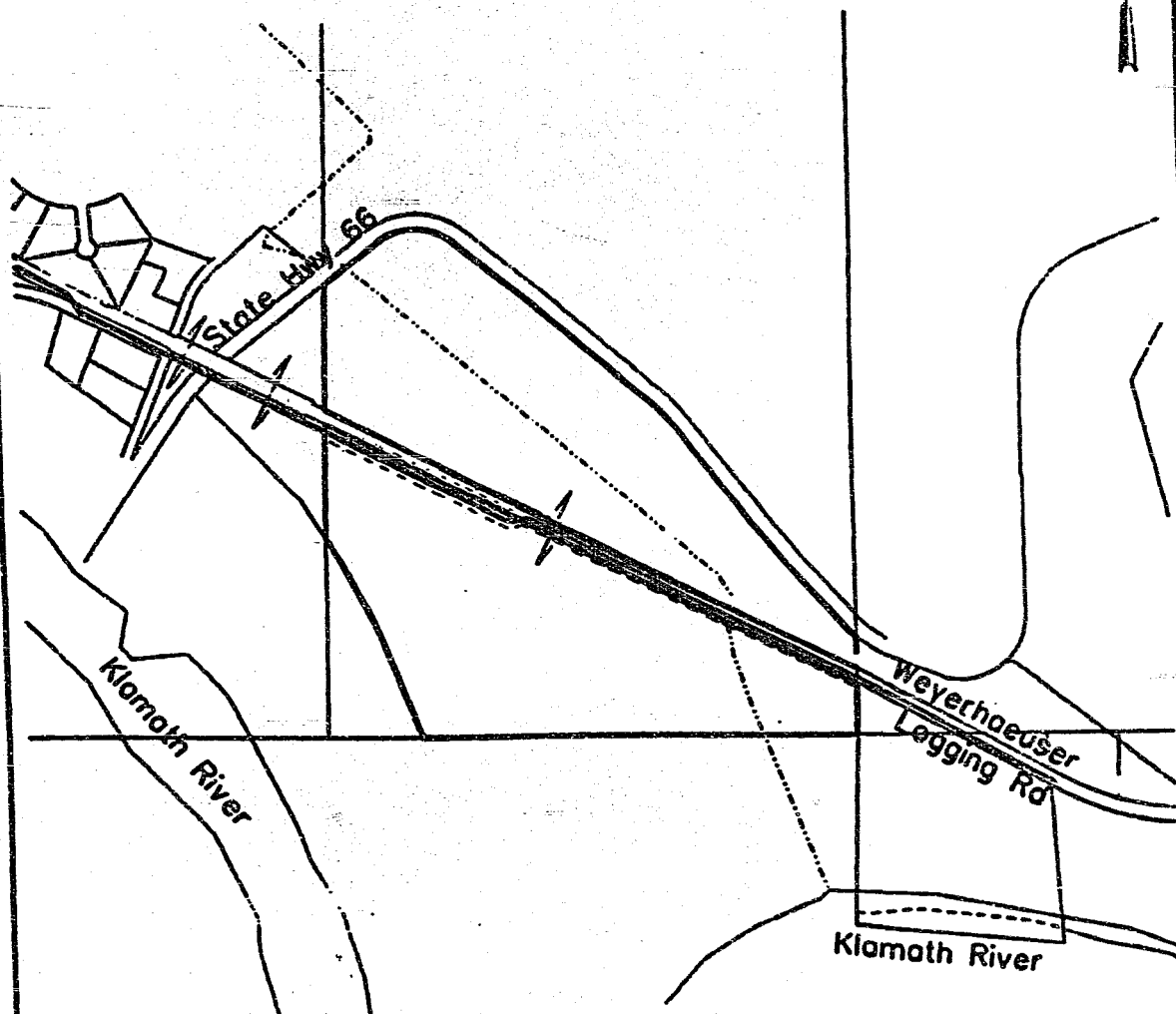
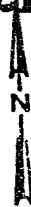

1775

Robert D. Puckett & Douglas Puckett

APN: 3908031D0-02900

PREPARED BY C12N HLL 18-AUG-94

1	07-21-94	FINAL SURVEY										
NO.	DATE	DESCRIPTION	W.O.	DR.	CH.	APPROVALS						
RECORD OF APPROVALS AND CHANGES												
W.O.			<b>PIPELINE RIGHT-OF-WAY</b>  <b>PACIFIC GAS TRANSMISSION COMPANY</b> PORTLAND, OREGON				SUPERSEDES					
SUPV							SHEET		OF		SHEETS	
DSGN B. SCHMITZ							DRAWING NUMBER				CHANGE	
DWN L. McCALL							M-1775				1	
CHKD												
SCALE 1" = 800'												

STATE OF OREGON: COUNTY OF KLAMATH: ss.

Filed for record at request of PGT the 15th day  
 of March A.D., 19 95 at 11:09 o'clock A M., and duly recorded in Vol. M95  
 of Deeds on Page 5717

Bernetha G. Leisch, County Clerk

By Sybil H. Heston

FEE \$30.00