

Return to: Pacific Power
P.O. Box 728
Klamath Falls, Or. 97601

04-28-95A10:48 RCVD

Vol m95 Page 10903
ER No. 41360-611
WO No. 01022624

39141

**UNDERGROUND
RIGHT-OF-WAY EASEMENT**
(Individual)

For value received, the undersigned, (Grantor), (whether singular or plural), do hereby grant to PacificCorp, a corporation doing business as Pacific Power & Light Company, its successors and assigns, (Grantee), an easement or right-of-way, ten (10) feet in width, for an electric underground distribution line of one or more conductors and all necessary or desirable appurtenances (including but not limited to the right to install conduits, surface or subsurface mounted transformers, surface mounted connection boxes and meter cabinets) over, under, across and along the following described real property in Klamath County, State of Oregon, to wit:

Said property generally located in The Southwest Quarter (SW $\frac{1}{4}$) of The Northeast Quarter (NE $\frac{1}{4}$) of Section 5, Township 39 South, Range 9 East, Willamette Meridian, and more specifically described in Volume 89, Page 24651, Official Book of Records of Klamath County.

the location and course of said right-of-way are approximately as shown on the sketch attached as Exhibit(s) A and by this reference made a part hereof.

Together with the right of ingress and egress over the adjacent lands of the Grantor in order to install, maintain, repair, replace, rebuild, operate and patrol the underground electric power lines and appurtenances, and to exercise all other rights herein granted.

Grantor shall have the right to use the lands subject to the above-described easement for all purposes not inconsistent with the uses and purposes herein set forth; provided that Grantor shall not build or erect any structure upon the right-of-way without the prior written consent of Grantee.

All rights hereunder shall cease if and when such line shall have been abandoned.

Dated this 17 day of April, 1995.

Wayne C Misco (SEAL) _____ (SEAL)

(SEAL) _____ (SEAL)

STATE OF Oregon
County of Klamath

On this 17th day of April, 1995, personally appeared before me a notary public in and for said State, the within named Wayne C. Misco to me known to be the identical person described therein and who executed the foregoing instrument, and acknowledged to me that he executed the same freely and voluntarily for the uses and purposes therein mentioned.

IN WITNESS WHEREOF, I have hereunto set my hand and official seal the day and year above written.

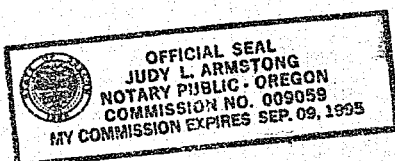

Judy L. Armstrong
Notary Public for Oregon
Residing at _____
My commission expires: 9.9.95

Owner: Misco, Wayne C. Living Trust

Location: SW $\frac{1}{4}$, NE $\frac{1}{4}$, Sec. 5, TS. 39S., R. 9E., W.M.

Work Order: 41360-01022624

Map: C-69-3-A-1

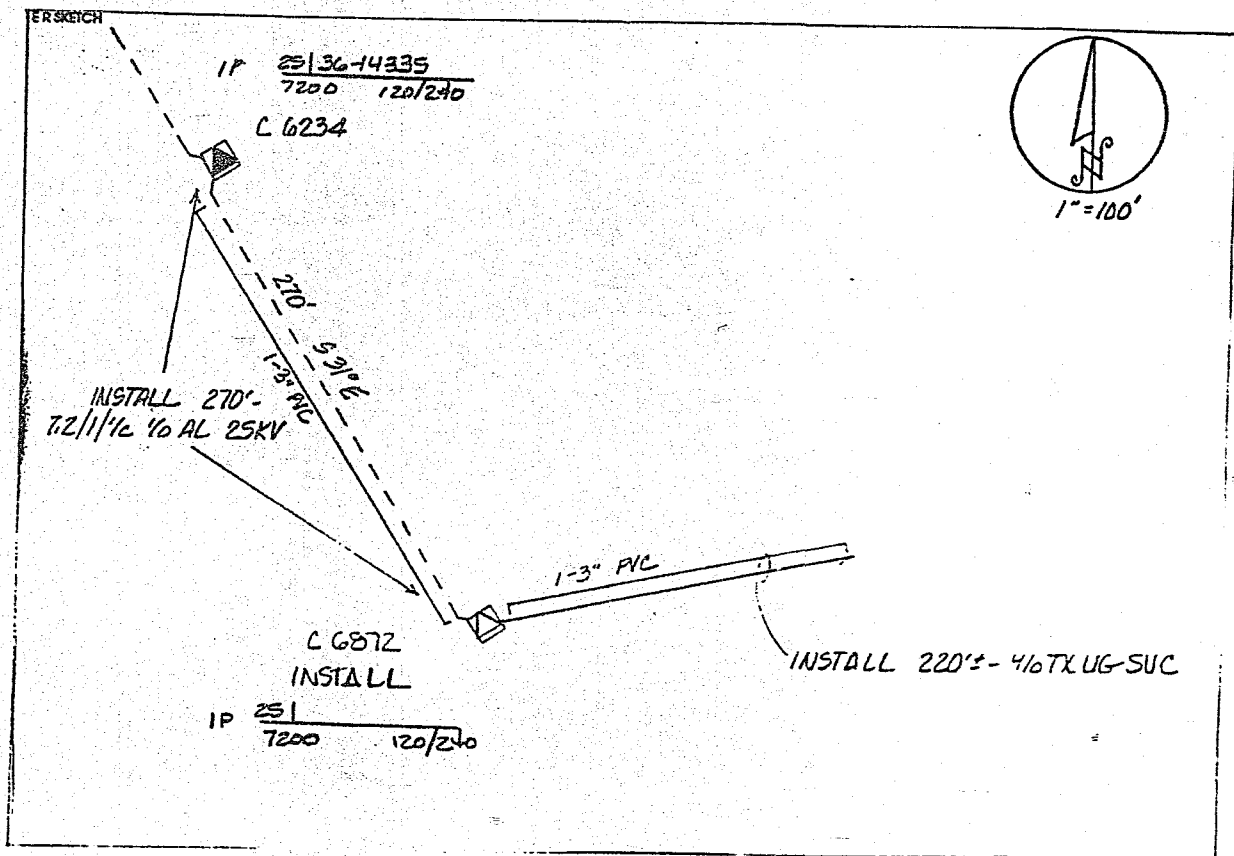

EXHIBIT 'A' SYMBOL KEY

- X - PROPOSED POLE
- O - EXISTING POLE
- ⊗ - EXISTING POLE TO BE REPLACED
- ⊘ - EXISTING POLE TO BE REMOVED
- - EXISTING WIRE TO BE REMOVED

- △ - PROPOSED ANCHOR # GU4
- ⊥ - EXISTING ANCHOR # GU4
- ⊞ - PROPOSED PADMOUNT TRANSFORMER
- ⊞ - EXISTING PADMOUNT TRANSFORMER
- ⊞ - SECTIONALIZING CABINET

STATE OF OREGON: COUNTY OF KLAMATH: ss.

Filed for record at request of Pacific Power the 28th day of April A.D., 19 95 at 10:48 o'clock A.M., and duly recorded in Vol. 95 of Deeds on Page 10903.

FEE \$15.00

By Bernetha G. Letsch, County Clerk