

031134

PACIFIC POWER

Vol. 1916 Page 59

Return To:

Pacific Power
P.O. Box 728
Klamath Falls, OR. 97601-0321

RC Name Klamath Falls

RC 41360 WO 01035921

RIGHT-OF-WAY EASEMENT
(Corporate)

For value received, Klamath Falls Elementary, School District No. 1, Klamath County hereinafter referred to as Grantor, does hereby grant to PACIFICORP, a corporation, dba Pacific Power & Light Company, its successors and assigns, the Grantee, an easement and right-of-way for an electric transmission and distribution line of one or more wires and all necessary or desirable appurtenances (including telephone and telegraph wires, towers, poles, props, guys, anchors and other supports and the right to place all of any part of such line underground) at or near the location and along the general course now located and staked out by the Grantee over, across and upon the following described real property in Klamath County, State of Oregon, to wit:

That portion of land described as being The Southeast Quarter (SE $\frac{1}{4}$) of Section 19, Township 38 South, Range 9 East of The Willamette Meridian. Said portion is Hank Street between Harvard Street and Front Street.

Specified width of easement is twenty (20) feet.

The general course and location of said right-of-way is as shown on the attached Exhibit "A" which is by this reference made a part hereof.

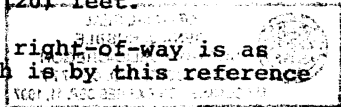

Together with the right of ingress and egress over the adjacent lands of the Grantor for the purpose of constructing, reconstructing, stringing new wires on, maintaining and removing such line and appurtenances, and exercising other rights hereby granted.

Grantor reserves the right to use said easement and right-of-way for roads, agricultural crops or other purposes not inconsistent with the easement and right-of-way granted hereby, but in using or operating any irrigation pipes, motorized vehicles or other equipment, or in any other such use of said easement and right-of-way, Grantor (including its successors or assigns) shall conform strictly to the provisions of any then-applicable safety code or regulations pertaining to required clearances from the wires or conductors of such line.

30
All rights hereunder shall cease if and when such line shall have been abandoned.

Dated this 9th day of October, 1995.

Carol M. Wendt

By Elementary District No. 1 Board Chair
(Title)

Attest: _____
(Title)

STATE OF Oregon

COUNTY OF Klamath

On this 13th day of November, 1995, before me personally appeared Carol Wendt, to me personally known to be the Board Chairperson of the Klamath Elementary School District No. 1 that executed the within and foregoing instrument; who, duly sworn, on oath did say that she is the Board Chairperson of the Klamath Elementary School District No. 1 who executed the within foregoing instrument in behalf of the Klamath Elementary School District No. 1 by authority of its Board of Directors, and she acknowledged said instrument to be the free act and deed of said Klamath Elementary School District No. 1 for the uses and purposes therein mentioned.

IN WITNESS WHEREOF, I have hereunto set my hand and official seal the day and year above written.

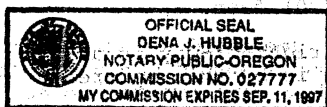

[Signature]

Notary Public for Oregon

My Commission expires: 9/11/97

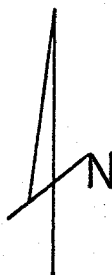
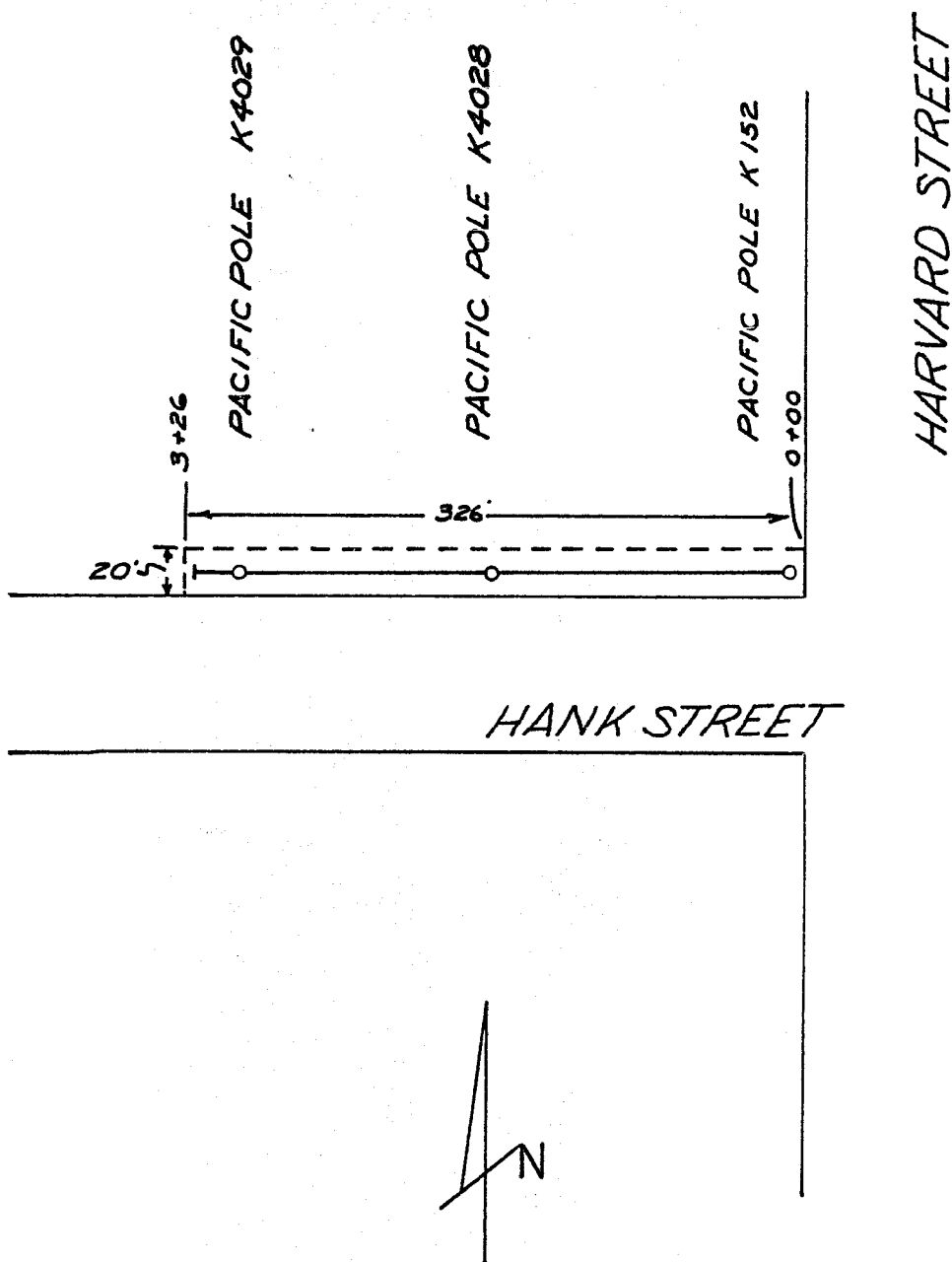

DISTRICT <u>KLAMATH FALLS</u>		
NAME <u>PELICAN ELEM</u>	FILE NO.	<u>41360</u>
LOCATION <u>501 McLean</u>	E R NO.	<u>621</u>
MAP NO. <u>136K-8</u>	W.O.	<u>01035921</u>
DRAWN <u>9/21</u>	10 <u>95</u>	

PACIFIC POWER & LIGHT COMPANY

E R SKETCH

SCALE no scale

FORM 2708-4/74

STATE OF OREGON: COUNTY OF KLAMATH: ss.

Filed for record at request of PP & L the 2nd day
of Jan A.D., 19 96 at 2:52 o'clock P M., and duly recorded in Vol. M96,
of Deeds on Page 59.

FEE \$20.00

By Bernetha G. Yetsch, County Clerk
Lynette M. May