

Return to: Pacific Power  
P.O. Box 728  
Klamath Falls, Or. 97601

ER No. 41360-611  
WO No. 01045307

## UNDERGROUND RIGHT-OF-WAY EASEMENT

For value received, the undersigned, (Grantor), (whether singular or plural), do hereby grant to Pacific Corp, a corporation doing business as Pacific Power & Light Company, its successors and assigns, (Grantee), an easement or right-of-way, ten (10) feet in width, for an electric underground distribution line of one or more conductors and all necessary or desirable appurtenances (including but not limited to the right to install conduits, surface or subsurface mounted transformers, surface mounted connection boxes and meter cabinets) over, under, across and along the following described real property in Klamath County, State of Oregon, to wit:

Situated in The Southwest Quarter (SW $\frac{1}{4}$ ) of The Southwest Quarter (SW $\frac{1}{4}$ ) of Section 11, Township 39 South, Range 11 East, Willamette Meridian.

the location and course of said right-of-way are approximately as shown on the sketch attached as Exhibit(s) A and by this reference made a part hereof.

Together with the right of ingress and egress over the adjacent lands of the Grantor in order to install, maintain, repair, replace, rebuild, operate and patrol the underground electric power lines and appurtenances, and to exercise all other rights herein granted.

Grantor shall have the right to use the lands subject to the above-described easement for all purposes not inconsistent with the uses and purposes herein set forth; provided that Grantor shall not build or erect any structure upon the right-of-way without the prior written consent of Grantee.

All rights hereunder shall cease if and when such line shall have been abandoned.

Dated this 10th day of November, 19 95.

Brenda G. Hartman (SEAL)

(SEAL)

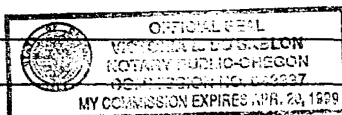

(SEAL)

(SEAL)

STATE OF Oregon

County of Klamath

On this 10th day of November, 19 95, personally appeared before me a notary public in and for said State, the within named Brenda G. Hartman to me known to be the identical person described therein and who executed the foregoing instrument, and acknowledged to me that she executed the same freely and voluntarily for the uses and purposes therein mentioned.

IN WITNESS WHEREOF, I have hereunto set my hand and official seal the day and year above written.

Victoria A. Russell  
Notary Public for South Valley State Bank  
Residing at Klamath Falls, Oregon  
My commission expires: 04/20/99

FACILITIES ARE SITUATED  
IN THE SW<sup>4</sup> SW<sup>4</sup> OF  
SECTION 11, TOWNSHIP 39S,  
RANGE 11E, WM

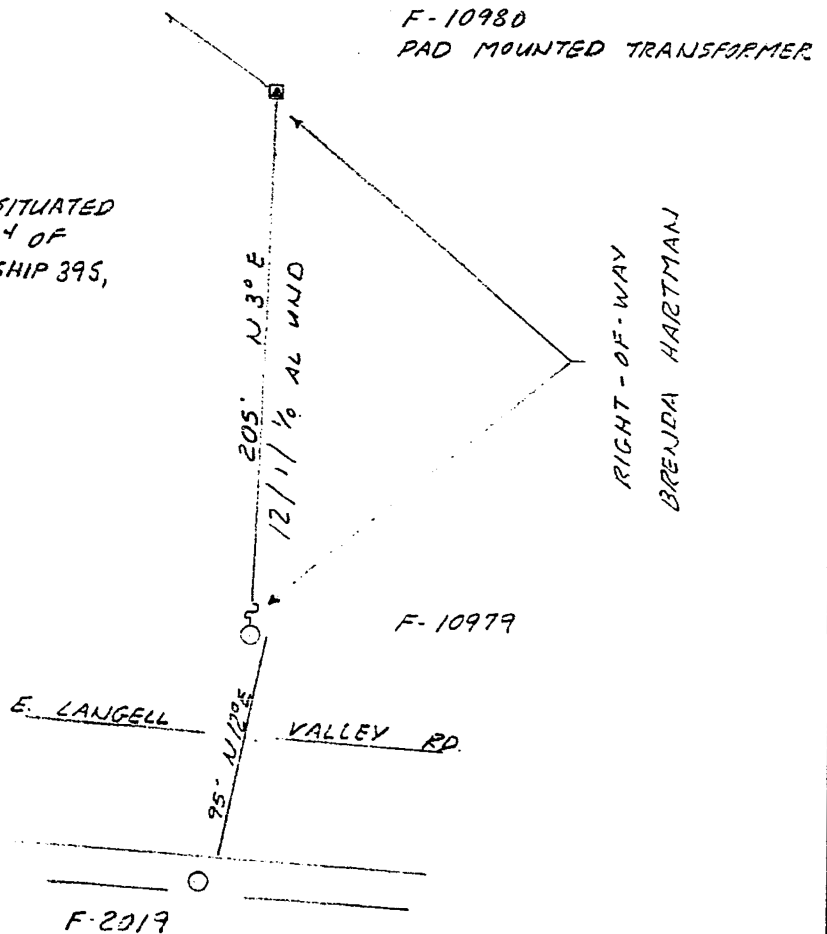

DISTRICT <u>KLAMATH</u>	
NAME <u>BRENDA HARTMAN</u>	
CIRCUIT NUMBER <u>4L 16</u>	
MAP NO. <u>F-126-1</u>	R.C. <u>41360</u>
DRAWN <u>J COX 11-1 19 95</u>	W.O. <u>01045307</u>

PACIFIC POWER  
E R SKETCH

SCALE 1"=60'

FORM 2705 - 4/80

STATE OF OREGON: COUNTY OF KLAMATH: ss.

Filed for record at request of Pacific Power the 2nd day  
of Feb A.D., 19 96 at 11:34 o'clock A M., and duly recorded in Vol. M96  
of Deeds on Page 3121

FEE \$15.00

By Bernetha G. Letsch, County Clerk  
Lynette Fluker