

13214

96 FEB 12 A9:33

Vol. 96 Page 3900

Return to: Pacific Power
P.O. Box 728
Klamath Falls, Or. 97601

ER No. 41360-611
WO No. 01047894

UNDERGROUND RIGHT-OF-WAY EASEMENT

For value received, the undersigned, (Grantor), (whether singular or plural), do hereby grant to PacificCorp, a corporation doing business as Pacific Power & Light Company, its successors and assigns, (Grantee), an easement or right-of-way, ten (10) feet in width, for an electric underground distribution line of one or more conductors and all necessary or desirable appurtenances (including but not limited to the right to install conduits, surface or subsurface mounted transformers, surface mounted connection boxes and meter cabinets) over, under, across and along the following described real property in Klamath County, State of Oregon, to wit:

Said property located in The Southwest Quarter (SW¼)
of The Northeast Quarter (NE¼) of Section 7, Township
39 South, Range 10 East, Willamette Meridian.

the location and course of said right-of-way are approximately as shown on the sketch attached as Exhibit(s) A and by this reference made a part hereof.

Together with the right of ingress and egress over the adjacent lands of the Grantor in order to install, maintain, repair, replace, rebuild, operate and patrol the underground electric power lines and appurtenances, and to exercise all other rights herein granted.

Grantor shall have the right to use the lands subject to the above-described easement for all purposes not inconsistent with the uses and purposes herein set forth; provided that Grantor shall not build or erect any structure upon the right-of-way without the prior written consent of Grantee.

All rights hereunder shall cease if and when such line shall have been abandoned.

Dated this 8th day of DECEMBER, 1995.

Lester J. Tucker (SEAL) _____ (SEAL)
Lois M. Tucker (SEAL) _____ (SEAL)

STATE OF OREGON

County of Klamath

On this 8th day of December, 1995, personally appeared before me a notary public in and for said State, the within named Lester J. and Lois M. Tucker to me known to be the identical persons described therein and who executed the foregoing instrument, and acknowledged to me that They executed the same freely and voluntarily for the uses and purposes therein mentioned.

IN WITNESS WHEREOF, I have hereunto set my hand and official seal the day and year above written.

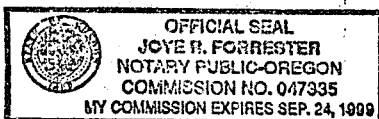

Joye R. Forrester
Notary Public for OREGON
Residing at Klamath Falls, OR
My commission expires: Sept 24, 1999

EXHIBIT A

Owner: Tucker, Lester J./Lois M. Work Order: 41360-01047894
 Location: 3636 UALE RD KLAMATH FALLS, OR.
 Map: D-88-3-C-1

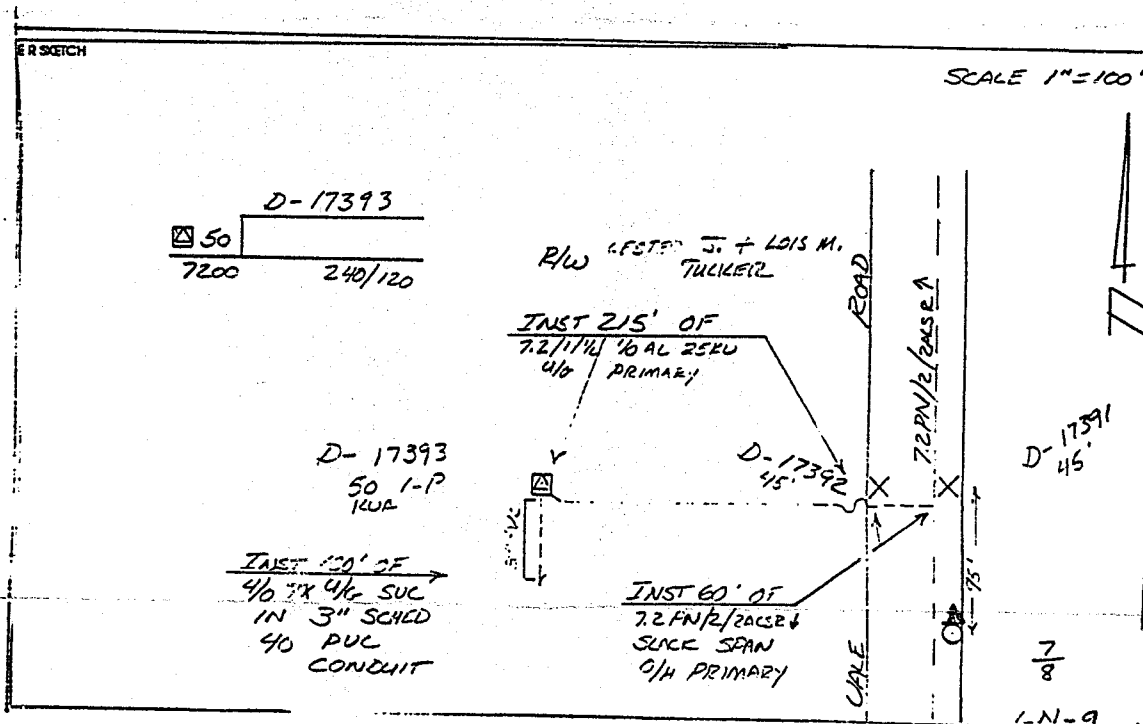

EXHIBIT 'A' SYMBOL KEY

- | | |
|--|--|
| <ul style="list-style-type: none"> X - PROPOSED POLE O - EXISTING POLE ⊗ - EXISTING POLE TO BE REPLACED ⊘ - EXISTING POLE TO BE REMOVED — - EXISTING WIRE TO BE REMOVED | <ul style="list-style-type: none"> ⋈ - PROPOSED ANCHOR + GUY ⊥ - EXISTING ANCHOR + GUY ⊠ - PROPOSED PADMOUNT TRANSFORMER ⬢ - EXISTING PADMOUNT TRANSFORMER ⊡ - SECTIONALIZING CABINET |
|--|--|

STATE OF OREGON: COUNTY OF KLAMATH: ss.

Filed for record at request of Pacific Power the 12th day
 of Feb A.D., 19 96 at 9:33 o'clock A M., and duly recorded in Vol. M96
 of Deeds on Page 3900

FEE
\$15.00

By Bernetha G. Letsch, County Clerk