

Return to: Pacific Power
P.O. Box 728
Klamath Falls, Or. 97601

ER No. 41360-611
WO No. 01050075

UNDERGROUND RIGHT-OF-WAY EASEMENT (Partnership)

For value received, the undersigned, (Grantor), (whether singular or plural), do hereby grant to PacificCorp, a corporation doing business as Pacific Power & Light Company, its successors and assigns, (Grantee), an easement or right-of-way, ten (10) feet in width, for an electric underground distribution line of one or more conductors and all necessary or desirable appurtenances (including but not limited to the right to install conduits, surface or subsurface mounted transformers, surface mounted connection boxes and meter cabinets) over, under, across and along the following described real property in Klamath County, State of Oregon, to wit:

Said property generally located in The Southeast Quarter (SE $\frac{1}{4}$) of The Northeast Quarter (NE $\frac{1}{4}$) of Section 35, Township 38 South, Range 11 $\frac{1}{2}$ East, Willamette Meridian.

the location and course of said right-of-way are approximately as shown on the sketch attached as Exhibit(s) A and by this reference made a part hereof.

Together with the right of ingress and egress over the adjacent lands of the Grantor in order to install, maintain, repair, replace, rebuild, operate and patrol the underground electric power lines and appurtenances, and to exercise all other rights herein granted.

Grantor shall have the right to use the lands subject to the above-described easement for all purposes not inconsistent with the uses and purposes herein set forth; provided that Grantor shall not build or erect any structure upon the right-of-way without the prior written consent of Grantee.

All rights hereunder shall cease if and when such line shall have been abandoned.

Dated this 20 day of March, 19 96.

Kenneth S. Gordon (SEAL) _____ (SEAL)

(SEAL) _____ (SEAL)

STATE OF Oregon
County of Klamath

On this 20 day of March, 19 96, personally appeared before me a notary public in and for said State, the within named Kenneth S. Gordon
~~appeared~~ to me known to be the identical person ~~he~~ described therein and who executed the foregoing instrument, and acknowledged to me that he executed the same freely and voluntarily for the uses and purposes therein mentioned.

IN WITNESS WHEREOF, I have hereunto set my hand and official seal the day and year above written.

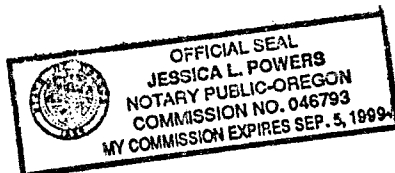

Jessica L. Powers
Notary Public for Artline Office
Residing at 4525 S. 6th K-Falls
My commission expires: Sept 5, 1999

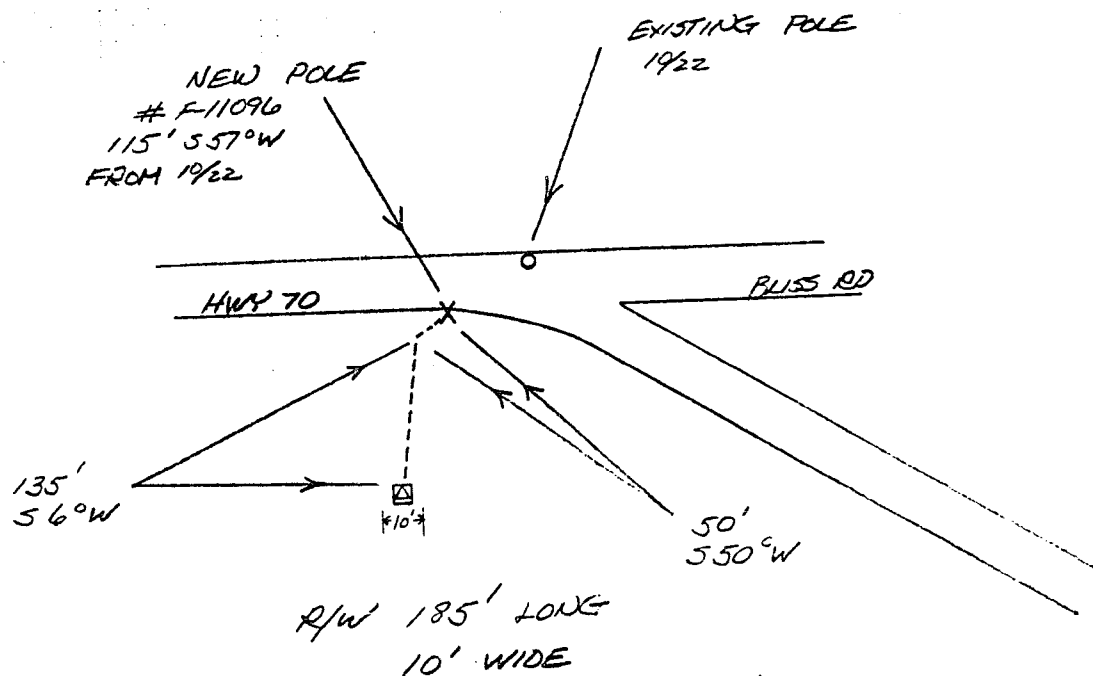

EXHIBIT A

DISTRICT <u>KLAMATH</u>	
NAME <u>REN GORDEN</u>	
CIRCUIT NUMBER <u>5443</u>	
MAP NO. <u>E-106-7-C</u>	R.C. <u>41360</u>

PACIFIC POWER
E R SKETCHSCALE 1" = 200'

STATE OF OREGON: COUNTY OF KLAMATH: ss.

Filed for record at request of Pacific Power & Light Company the 2nd day
of April A.D., 19 96 at 11:18 o'clock A M., and duly recorded in Vol. M96
of Deeds on Page 9204

Bernetha G. Letsch, County Clerk

By Cindy Russell

FEE \$15.00

WITHDRAWN

April 2, 1996

Doc. #15802

Vol. M96 Page 9206