

20139

REF 160261

Vol 1796 Page 18948

23-10-10-CA

ELECTRIC LINE RIGHT-OF-WAY EASEMENT

KNOW ALL MEN BY THESE PRESENTS, that the undersigned, Wayne Ronek and Denise Ronek do hereby grant unto MIDSTATE ELECTRIC COOPERATIVE, INC., a cooperative (hereinafter called the "Cooperative") whose post office address is P O Box 127, LaPine OR 97739, and to its successors or assigns, the right to enter upon the lands of the undersigned, situated in the county of Klamath, State of Oregon, and more particularly described as follows:

Portion: NE1/4 SW1/4,
Section: 10, Township 23 South, Range 10 East Willamette Meridian,
Tax Lot: 900,

A 30 foot wide easement to install electrical facilities starting at the southwest property corner and true point of beginning; thence north 30 feet along the west property line; thence east 400 feet parallel to the south property line; thence south 30 feet parallel to the west property line; thence west 400 feet along the south property line to the southwest property corner and true point of beginning, containing $\pm .28$ acres, more or less; See exhibit "A",

and to construct, operate and maintain an electric transmission and/or distribution line or system on or under the above described lands and/or in, upon or under all streets, roads or highways abutting said lands; to inspect and make such repairs, changes, alterations, improvements, removals from, substitutions and additions to its facilities as Cooperative may from time to time deem advisable, including, by way of example and not by way of limitation, the right to increase or decrease the number of conduits, wires, cables, handholes, manholes, connection boxes, transformer enclosures; to cut, trim and control the growth by machinery or otherwise of trees and shrubbery located within 15 feet of the center line of said line or system, or that may otherwise interfere with or threaten to endanger the operation and maintenance of said line or system (including any control of the growth of other vegetation in the right-of-way which may incidentally and necessarily result from the means of control employed); to keep the easement clear of all buildings, structures or other obstructions; and to license, permit or otherwise agree to the joint use of occupancy of the lines, system or if any said system is placed underground, of the trench related underground facilities, by other person, association or corporation.

The undersigned agreed that all poles, wires and other facilities including any main service entrance equipment, installed in, upon or under the above described lands at the Cooperative's expense shall remain the property of the Cooperative, removable at the option of the Cooperative.

The undersigned further stipulate that they are the owners of the above described lands and that the said lands are free and clear of encumbrances and liens whatsoever except those held by the following persons:

DATED THIS 11 DAY OF June 1976 at LaPine, Oregon

SEAL

STATE OF Oregon)
COUNTY OF Deschutes) SS

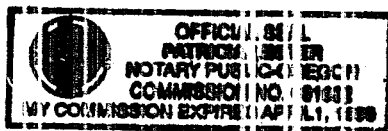

SUBSCRIBED AND SWORN TO BEFORE ME:

X Wayne Ronek
OWNER: Wayne Ronek

X Denise Ronek
OWNER: Denise Ronek

X Patricia L. Smith
NOTARY PUBLIC FOR: Deschutes County

My commission Expires: 4-1-80

96 JUN 26 A9:45

EXHIBIT A

18949

NOT TO SCALE

23-10-10-CA

LA PINE, OREGON
OREGON 39, KLAMATH

EXHIBIT "A" FOR EASEMENT

STATE	COUNTY	REF. NUMBER
OREGON	KLAMATH	960261

STATE OF OREGON: COUNTY OF KLAMATH: ss.

Filed for record at request of Midstate Electric Inc. the 26th day
of June A.D., 19 96 at 9:45 o'clock A.M., and duly recorded in Vol. M96
of Deeds on Page 18948

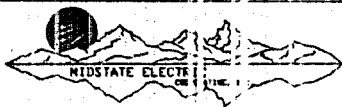
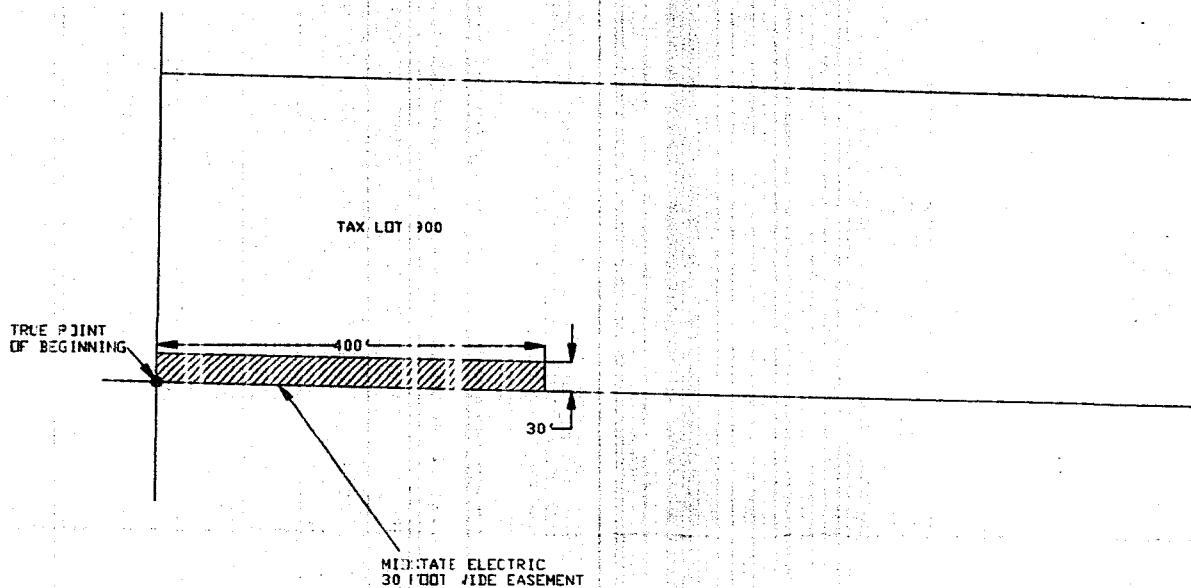
FEE \$15.00

Return: Midstate Electric
P.O. Box 127
LaPine, Oregon 97139

By Bernetha G. Letsch
Bernetha G. Letsch, County Clerk