

25753

Vol. 1996 Page 30568
23-09-25-DB

REF: 950709d

96 SEP 26 P3:18

ELECTRIC LINE RIGHT-OF-WAY EASEMENT

KNOW ALL MEN BY THESE PRESENTS, that the undersigned, Brian Polley and Barbara Polley do hereby grant unto MIDSTATE ELECTRIC COOPERATIVE, INC., a cooperative (hereinafter called the "Cooperative") whose post office address is P O Box 127, LaPine OR 97739, and to its successors or assigns, the right to enter upon the lands of the undersigned, situated in the county of Klamath, State of Oregon, and more particularly described as follows:

Portion: NW1/4 SE1/4,
Section: 25, Township 23 South, Range 09 East Willamette Meridian,
Tax Lot: 300, Lot: 8, Block: 2,
Subdivision: Chapman Acres,
A 10 foot wide easement to install electrical facilities starting at southeast property corner and true point of beginning; thence west 10 feet along the south property line; thence north 30 feet parallel to the east property line; thence east 10 feet to the east property line; thence south 30 feet along the east property line to the southeast property corner and true point of beginning, containing \pm .01 acres, more or less; See exhibit "A",

and to construct, operate and maintain an electric transmission and/or distribution line or system on or under the above described lands and/or in, upon or under all streets, roads or highways abutting said lands; to inspect and make such repairs changes, alterations, improvements, removals from, substitutions and additions to its facilities as Cooperative may from time to time deem advisable, including, by way of example and not by way of limitation, the right to increase or decrease the number of conduits, wires, cables, handholes, manholes, connection boxes, transformer enclosures; to cut, trim and control the growth by machinery or otherwise of trees and shrubbery located within 15 feet of the center line of said line or system, or that may otherwise interfere with or threaten to endanger the operation and maintenance of said line or system (including any control of the growth of other vegetation in the right-of-way which may incidentally and necessarily result from the means of control employed); to keep the easement clear of all buildings, structures or other obstructions; and to license, permit or otherwise agree to the joint use of occupancy of the lines, system or, if any said system is placed underground, of the trench related underground facilities, by other person, association or corporation.

The undersigned agreed that all poles, wires and other facilities including any main service entrance equipment, installed in, upon or under the above-described lands at the Cooperative's expense shall remain the property of the Cooperative, removable at the option of the Cooperative.

The undersigned further stipulate that they are the owners of the above described lands and that the said lands are free and clear of encumbrances and liens whatsoever except those held by the following persons:

DATED THIS 28 DAY OF August 1996 at Eugene Or 97402

SEAL

STATE OF Oregon)
COUNTY OF Lane) SS

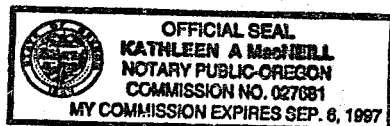

Return: Midstate Electric
P.O. Box 127
La Pine, OR 97739

SUBSCRIBER AND SWORN TO BEFORE ME:

X Brian Polley
OWNER: Brian Polley

X Barbara Polley
OWNER: Barbara Polley

X Kathleen A. MacNeill
NOTARY PUBLIC FOR: Oregon

My commission Expires: Sep 6, 1997

ck
15

EXHIBIT A 23-09-25-DB

NOT TO SCALE

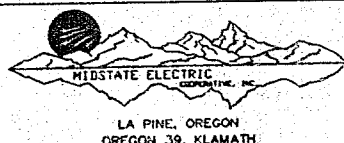
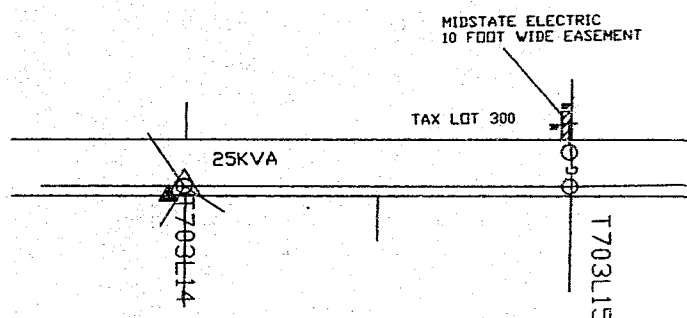

EXHIBIT 'A' FOR EASEMENT

STATE	COUNTY	REF. NUMBER
OREGON	KLAMATH	950709

STATE OF OREGON: COUNTY OF KLAMATH: ss.

Filed for record at request of Midstate Electric the 26th day
 of Sept. A.D., 19 96 at 3:18 o'clock P. M., and duly recorded in Vol. M96
 of Deeds on Page 30568

Bernetha G. Letsch County Clerk
 By Kathleen Rose

FEE \$15.00