

Ordinance No. 96-33

**A SPECIAL ORDINANCE ANNEXING CERTAIN TERRITORY TO THE
CITY OF KLAMATH FALLS
LOCATED ON EBERLEIN AVENUE, OFF THE EASTSIDE BYPASS,
LOT 18, BLOCK 160, ENTERPRISE TRACTS**

WHEREAS, the City of Klamath Falls initiated an annexation based upon island annexation laws due to the fact that it is surrounded by City property; of certain real property by the Klamath Falls City Council thereof, which property is hereinafter described;

WHEREAS, a hearing was held on August 12, 1996, pursuant to applicable laws, at which time all objections or remonstrances with reference to said proposed annexation and zone change were considered by the Planning Commission;

WHEREAS, the City Council hearing notice having been duly given, did hold a public hearing on November 4, 1996; on the record of the Planning Commission on the annexation;

WHEREAS, the Council has adopted the findings of the Planning Commission, attached hereto and incorporated by this reference as Exhibit "B", determining the annexation to be in compliance with the Comprehensive Plan and Community Development Ordinance;

WHEREAS, the Council did determine annexation of said property to be in the best interest of the City and the continuous territory;

WHEREAS, the City of Klamath Falls adapted a Comprehensive Plan for the City on April 20, 1982, by virtue of passage of Ordinance No. 6336;

WHEREAS, pursuant to such record and hearing, the City Council has determined the annexation and zone change to be in compliance with the Community Development Ordinance and the Comprehensive Plan; **NOW THEREFORE**,

THE CITY OF KLAMATH FALLS ORDAINS AS FOLLOWS;

Section 1

There is hereby annexed to the City of Klamath Falls, a tract of land situated located on Eberlein Avenue, off the Eastside Bypass, tax account number 3809-0034-500, Lot 18, Block 160, Enterprise Tracts, as shown on the map attached hereto as Exhibit "A", and further described as follows: Tract No. 18, Enterprise Tracts in Klamath County, Oregon, being a portion of the Northwest quarter of the Southeast quarter (NE 1/4 of SE 1/4) of Section 34, Township 33, South, Range 9 E.W.M.

Passed by the Council of the City of Klamath Falls, Oregon, the 18th day of November, 1996.

Presented to the Mayor (Mayor Pro-tem), approved and signed this 19th day of November, 1996.

Mayor (Mayor Pro-tem)

ATTEST:

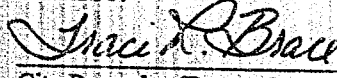
City Recorder (Deputy Recorder)

AFTER RECORDING RETURN TO:

City Recorder
P.O. Box 237
Klamath Falls, OR 97601

Ordinance No. 96-33 Page 1

96 DEC 16 P1:12

cc-2500

STATE OF OREGON
COUNTY OF KLAMATH
CITY OF KLAMATH FALLS

}

ss

I, ELISA D. FRITZ, Recorder (~~Deputy Recorder~~) for the City of Klamath Falls, Oregon, do hereby certify that the foregoing is a true and correct copy of an Ordinance duly adopted by the Council of the City of Klamath Falls, Oregon, at the meeting held on the 18th day of November, 1996 and thereafter approved and signed by the Mayor (~~Mayor Pro-tem~~) and attested by the City Recorder (~~Deputy Recorder~~).

Elisa D. Fritz
City Recorder (~~Deputy Recorder~~)

SEE MAP 38 09 3300

EE MAP 38 03 33DA

SEE MAP 30 08 33A

SEE MAP 38 08 13M

20
27
SEE MAP 38 09 27CC

MAITH COUNTRY
T-400

INDEX
KLAMATH FALLS

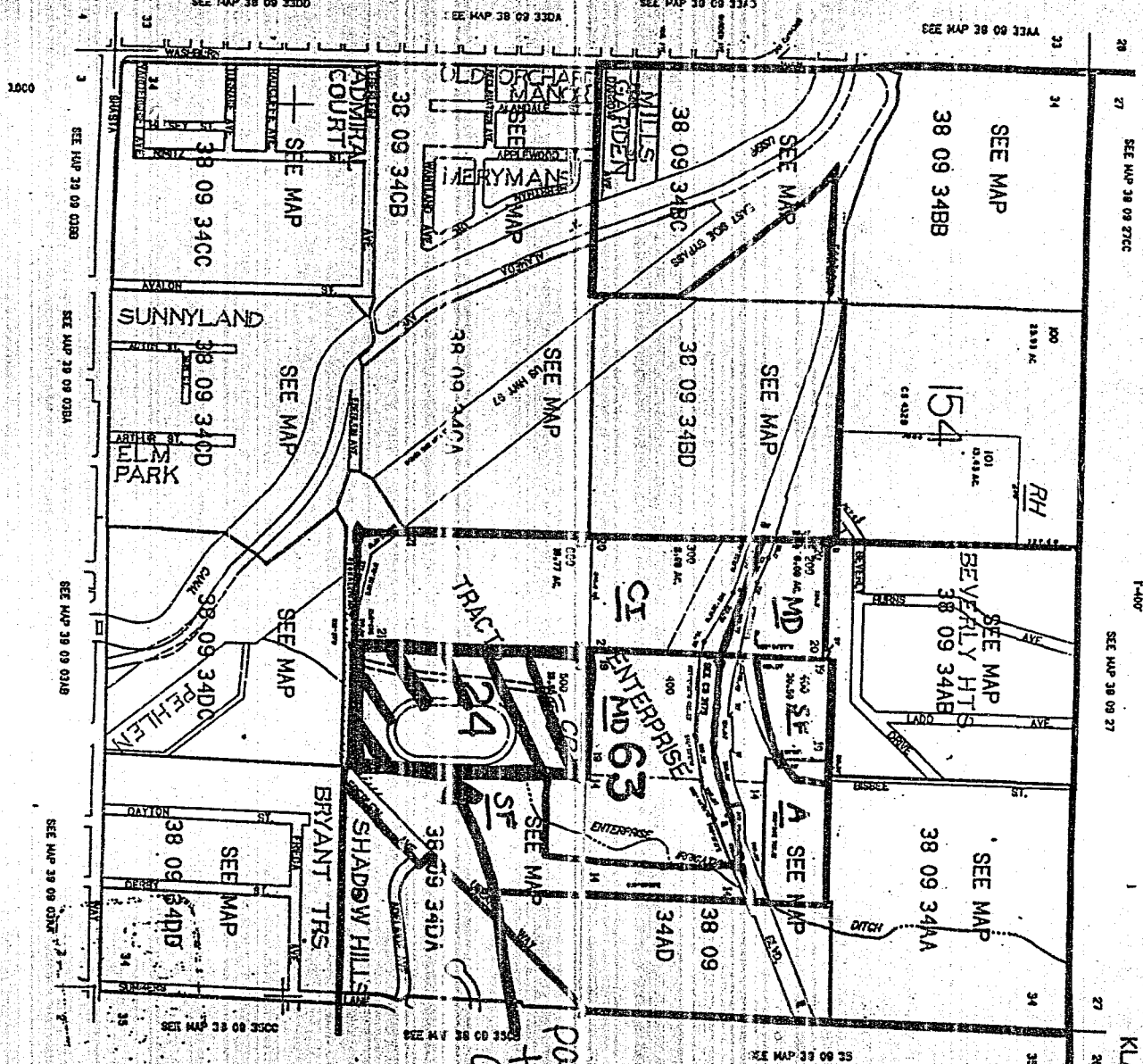

percol
to be
annexed

Exhibit "B"

FINDINGS

- 1) The subject property is planned and zoned for commercial use. The current development on the property is a race track. No adverse affects on surrounding properties is expected as a result of the proposed annexation.
- 2) The subject property is not located in a flood plain or other natural hazard or resource area.
- 3) The proposed annexation of the site is consistent with City policy which encourages annexation of property surrounded by City property.
- 4) Fire and road access are currently available to the property. No impact on these services is expected with the annexation of the subject property to the City of Klamath Falls, Police protection will be available following annexation.

STATE OF OREGON : COUNTY OF KLAMATH:

Filed for record at request of City of Klamath Falls the 16th day
 of December A.D., 1996 at 1:12 o'clock P. M., and duly recorded in Vol. M96
 of Deeds on Page 38933

FEE \$25.00

County Clerk
 by Bernetha Letsch

Kathleen Ross